



HAYES GROVE, EAST DULWICH, SE22  
OIEO £450,000 LEASEHOLD

THIS BEAUTIFULLY PRESENTED MODERN TWO  
DOUBLE BEDROOM GROUND FLOOR FLAT IS  
SITUATED IN A PRIME CENTRAL LOCATION.

Dulwich | 020 8299 2722 | [dulwich@winkworth.co.uk](mailto:dulwich@winkworth.co.uk)

**Winkworth**

[winkworth.co.uk](http://winkworth.co.uk)

See things differently



## DESCRIPTION:

This beautifully presented modern two double bedroom ground floor flat is situated in a prime central East Dulwich location, close to both Denmark Hill, Peckham Rye, and East Dulwich stations. The property offers two good double bedrooms, a modern kitchen, two bathrooms, and a large reception. In addition, there is parking for one car and a large communal garden. It is well positioned to benefit from easy access to the bars, restaurants, shops, and cinema on Lordship Lane as well as those on Bellenden Road and direct transport links into Central London via East Dulwich, Denmark Hill or Peckham Rye with East London tube connections should they be required. This is a fantastic modern flat offered to the market chain free with early viewing recommended.

Leasehold: 107 years  
Service Charge: £2,000/year  
Ground Rent: £100/year  
Council Tax Band C

## AT A GLANCE

- Two Double Bedrooms
- Ground Floor Modern Flat
- Large Reception
- Modern Kitchen
- Bathroom & Shower Room
- Communal Garden & Parking for One Car
- Leasehold
- Chain Free





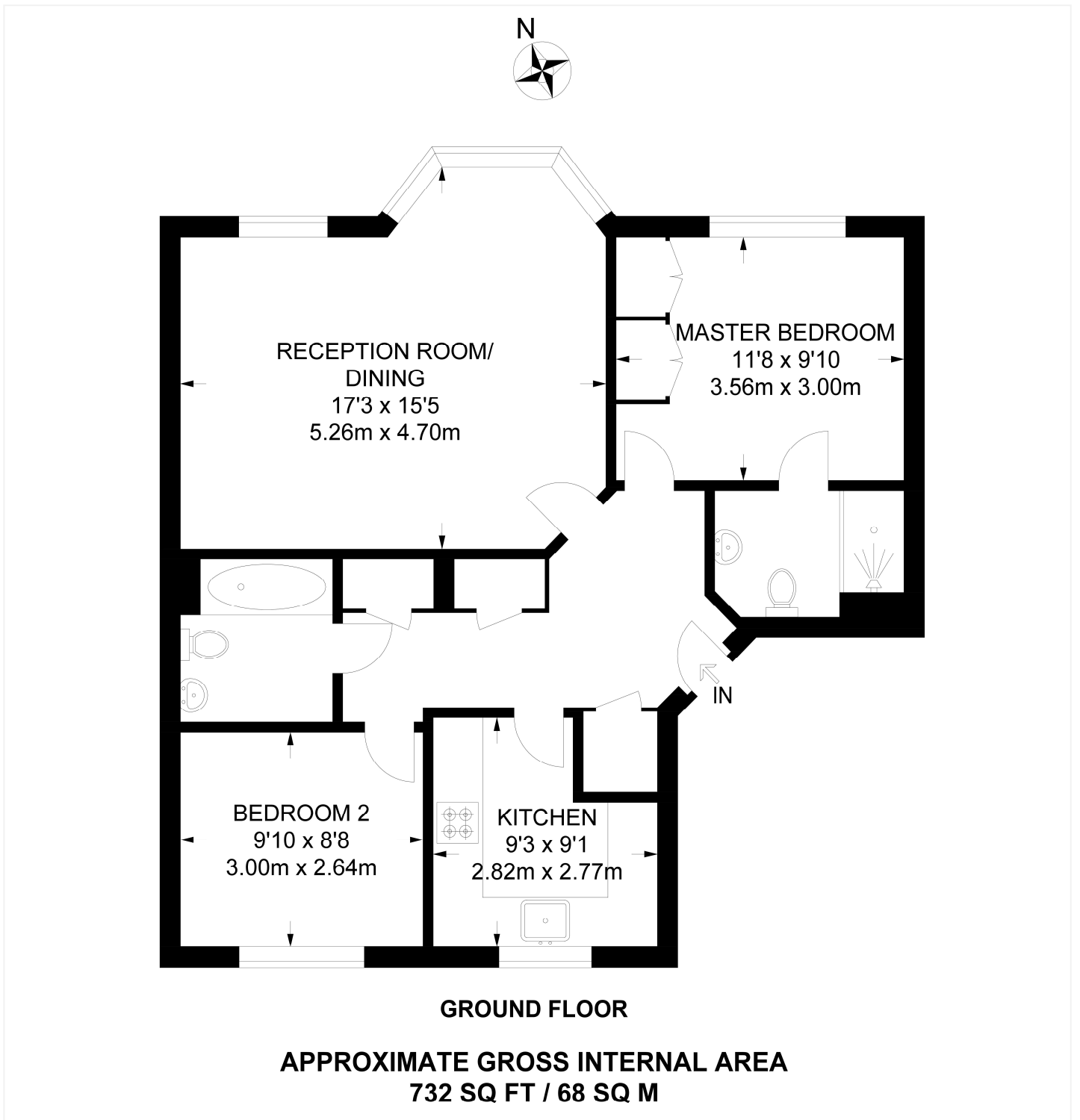

This floorplan is for illustration purposes only and is not to scale. The position and size of doors, windows, appliances and other features are approximate.

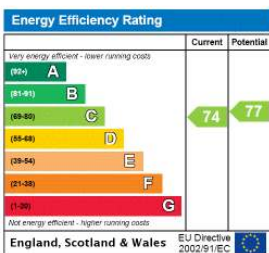

Dulwich | 020 8299 2722 | [dulwich@winkworth.co.uk](mailto:dulwich@winkworth.co.uk)



[winkworth.co.uk](http://winkworth.co.uk)

See things differently

Winkworth wishes to inform prospective buyers and tenants that these particulars are a guide and act as information only. All our details are given in good faith and believed to be correct at the time of printing but they don't form part of an offer or contract. No Winkworth employee has authority to make or give any representation or warranty in relation to this property. All fixtures and fittings, whether fitted or not are deemed removable by the vendor unless stated otherwise and room sizes are measured between internal wall surfaces, including furnishings.