



HILL CLOSE, CHISLEHURST, BR7
GUIDE PRICE £550,000-£575,000 FREEHOLD

CHAIN FREE! A LIGHT AND AIRY THREE BEDROOM SEMI-DETACHED FAMILY HOME LOCATED IN THIS POPULAR CUL-DE-SAC JUST A SHORT WALK FROM POPULAR SCHOOLS AND CHISLEHURST HIGH STREET.

Chislehurst | 0208 2855099 | chislehurst@winkworth.co.uk

Winkworth

for every step...

winkworth.co.uk



DESCRIPTION:

Accommodation comprises through reception room with bay window to the front, dinning area with doors leading onto the garden at the rear and modern kitchen. Upstairs there are two double bedrooms, one single bedroom, a shower room and separate WC. Externally there is a good sized south facing garden which is mainly laid to lawn. This property will make a lovely family home and has potential to extended STTP

The location is superb with Chislehurst High Street just 0.5 miles away and offering a vast array of boutique shops, restaurants and coffee bars and the beautiful Chislehurst commons and ponds. Elmstead Woods and New Eltham stations are within easy reach and bus stops can be found at the end of the road on Green Lane and White Horse Hill. Many of the area's finest schools are also nearby including Red hill, Mead road, St Nicholas and Edgebury.



Winkworth

for every step...



Winkworth

for every step...

Ground Floor

Approx. 38.1 sq. metres (410.5 sq. feet)

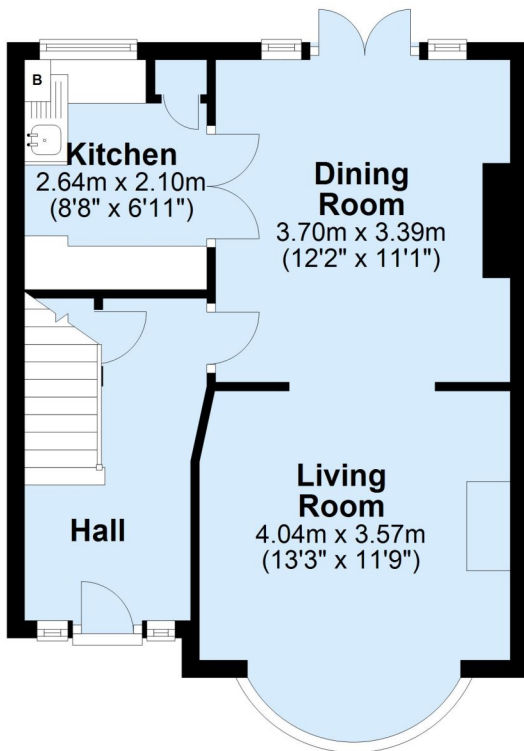

First Floor

Approx. 40.2 sq. metres (432.2 sq. feet)

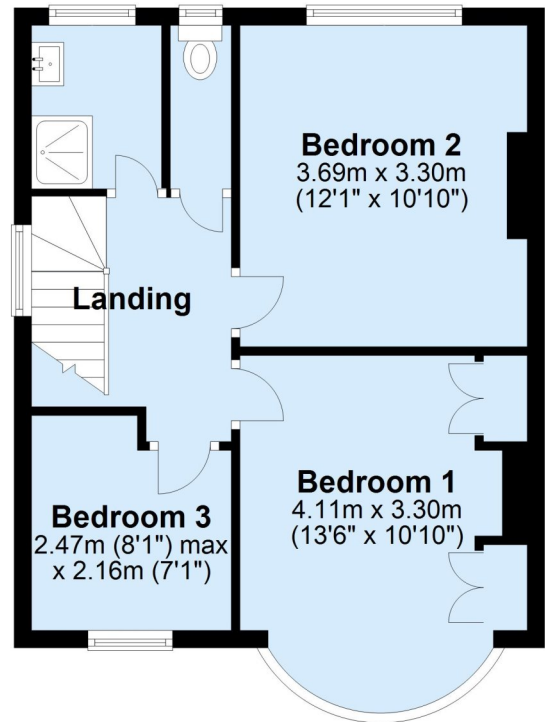

Total area: approx. 78.3 sq. metres (842.7 sq. feet)

This floorplan is for illustration purposes only and is not to scale. The position and size of doors, windows, appliances and other features are approximate.

Energy Efficiency Rating		
	Current	Potential
Very energy efficient - lower running costs		
(92+) A		
(81-91) B		
(69-80) C		
(55-68) D		
(39-54) E		
(21-38) F		
(1-20) G		
Not energy efficient - higher running costs		
England, Scotland & Wales	EU Directive 2002/91/EC	

Chislehurst | 0208 2855099 | chislehurst@winkworth.co.uk

Winkworth

for every step...

winkworth.co.uk

Winkworth wishes to inform prospective buyers and tenants that these particulars are a guide and act as information only. All our details are given in good faith and believed to be correct at the time of printing but they don't form part of an offer or contract. No Winkworth employee has authority to make or give any representation or warranty in relation to this property. All fixtures and fittings, whether fitted or not are deemed removable by the vendor unless stated otherwise and room sizes are measured between internal wall surfaces, including furnishings.