

2 COLLEGE MANOR, FARQUHAR ROAD, LONDON, SE19
£1,225 PER MONTH PART FURNISHED

A FANTASTIC ONE BEDROOM GROUND FLOOR FLAT WITH COMMUNAL GARDENS AVAILABLE TO LET

Crystal Palace | 02038693222 | crystalpalace@winkworth.co.uk

Tenant Fees Apply: Details of fees for tenant referencing, tenancy agreement admin fees and renewal fees are available on the Winkworth website and the link can be found with the displayed rent for the property. Tenants should ensure they are fully conversant with these upfront fees and other costs that are involved at the outset of the tenancy before making an offer to rent and your local Winkworth office will provide written details upon request.

[winkworth.co.uk](https://www.winkworth.co.uk)

Winkworth

for every step...



DESCRIPTION:

A fantastic one bedroom ground floor flat to let, situated on this desirable road within easy access to Crystal Palace Triangle, Park and Station.

This flat benefits from a spacious living area with a separate modern fitted kitchen, a generously sized bedroom and three-piece bathroom suite. Additional benefits include a communal garden to the rear and free street parking directly outside the building.

Situated within a short walk to Crystal Palace Triangle with its array of trendy bars, cinema, restaurants and shops this flat is perfect for a single professional or couple looking for a property rent in an artistic and vibrant part of South East London.

Winkworth

for every step...



Winkworth

for every step...

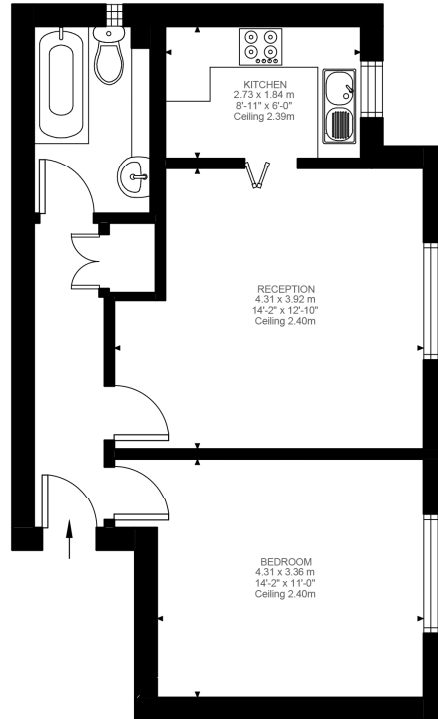

Ground Floor
493 ft²

College Manor, SE19
Approximate Gross Internal Area
45.76 SQ.M / 493 SQ.FT

Illustration for identification purposes only. Not to scale.
Floor Plan Drawn According To RICS Guidelines.

This floorplan is for illustration purposes only and is not to scale. The position and size of doors, windows, appliances and other features are approximate.

Crystal Palace | 02038693222 | crystalpalace@winkworth.co.uk

Winkworth

for every step...

[winkworth.co.uk](https://www.winkworth.co.uk)

Winkworth wishes to inform prospective buyers and tenants that these particulars are a guide and act as information only. All our details are given in good faith and believed to be correct at the time of printing but they don't form part of an offer or contract. No Winkworth employee has authority to make or give any representation or warranty in relation to this property. All fixtures and fittings, whether fitted or not are deemed removable by the vendor unless stated otherwise and room sizes are measured between internal wall surfaces, including furnishings.