



GIPSY HILL, SE19
£325,000 LEASEHOLD

**A STUNNING PERIOD FLAT IN GIPSY HILL CLOSE
TO LOCAL PARKS AND CRYSTAL PALACE
TRIANGLE**

DESCRIPTION:

An outstanding one double bedroom period conversion for sale, on this convenient street close to local amenities, greenspaces and transport links of Gipsy Hill and Crystal Palace Triangle.

This highly popular area is well-known and has great access to trendy bars, pubs and restaurants, all within walking distance and good connectivity into central London.

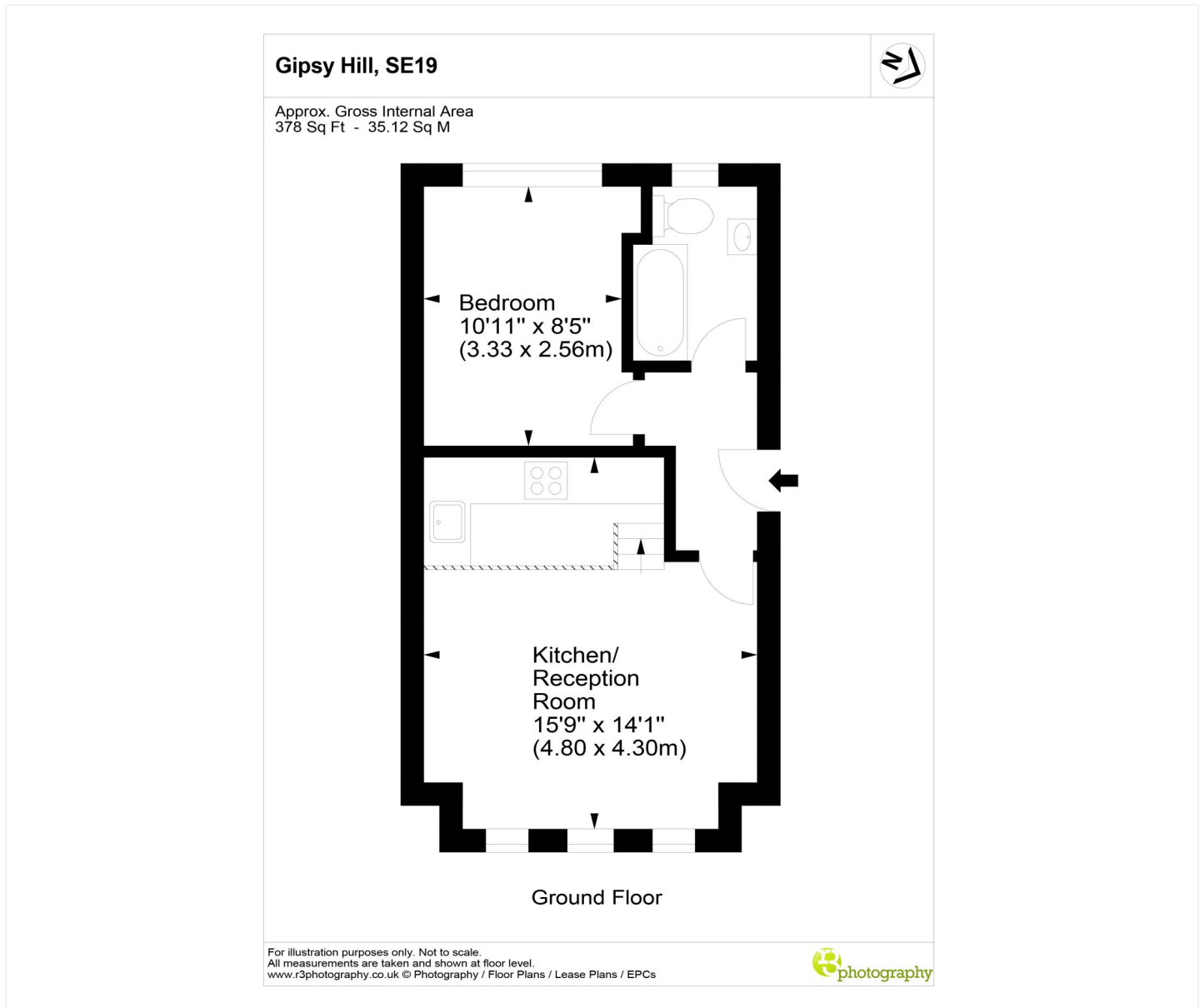

This floorplan is for illustration purposes only and is not to scale. The position and size of doors, windows, appliances and other features are approximate.