



RYE HILL PARK, PECKHAM RYE, LONDON, SE15  
£425,000 LEASEHOLD

A LARGE TWO DOUBLE BEDROOM, SPLIT-  
LEVEL FLAT SITUATED IN A SOUGHT-AFTER  
LOCATION IN SE15.

Dulwich | 020 8299 2722 | [dulwich@winkworth.co.uk](mailto:dulwich@winkworth.co.uk)

Tenure Leasehold | Council Tax Band B – London Borough of Southwark | Service  
Charge £1844 pa | Ground Rent £10 pa

[winkworth.co.uk](http://winkworth.co.uk)

**Winkworth**

See things differently



## DESCRIPTION:

A large two double bedroom, split-level flat situated in a sought-after location in SE15. This large two double bedroom flat is situated on Rye Hill Park, overlooking Peckham Rye park and within very easy access of the hustle and bustle of both Lordship Lane and Bellenden Road. Comprising two large doubles, a large reception with engineered wood flooring and lots of natural light and leading onto a private balcony. The kitchen is separate and boasts built in appliances and all finished to a high standard. Further benefits include large communal gardens and transport links, fantastically positioned at Peckham Rye for the overground, Nunhead for direct links to Victoria and East Dulwich for London Bridge.

## AT A GLANCE

- Two Double Bedrooms
- Large Reception Room
- Modern Kitchen
- Modern Bathroom
- Split Level Flat
- Private Balcony
- Communal Garden
- Great Transport Links





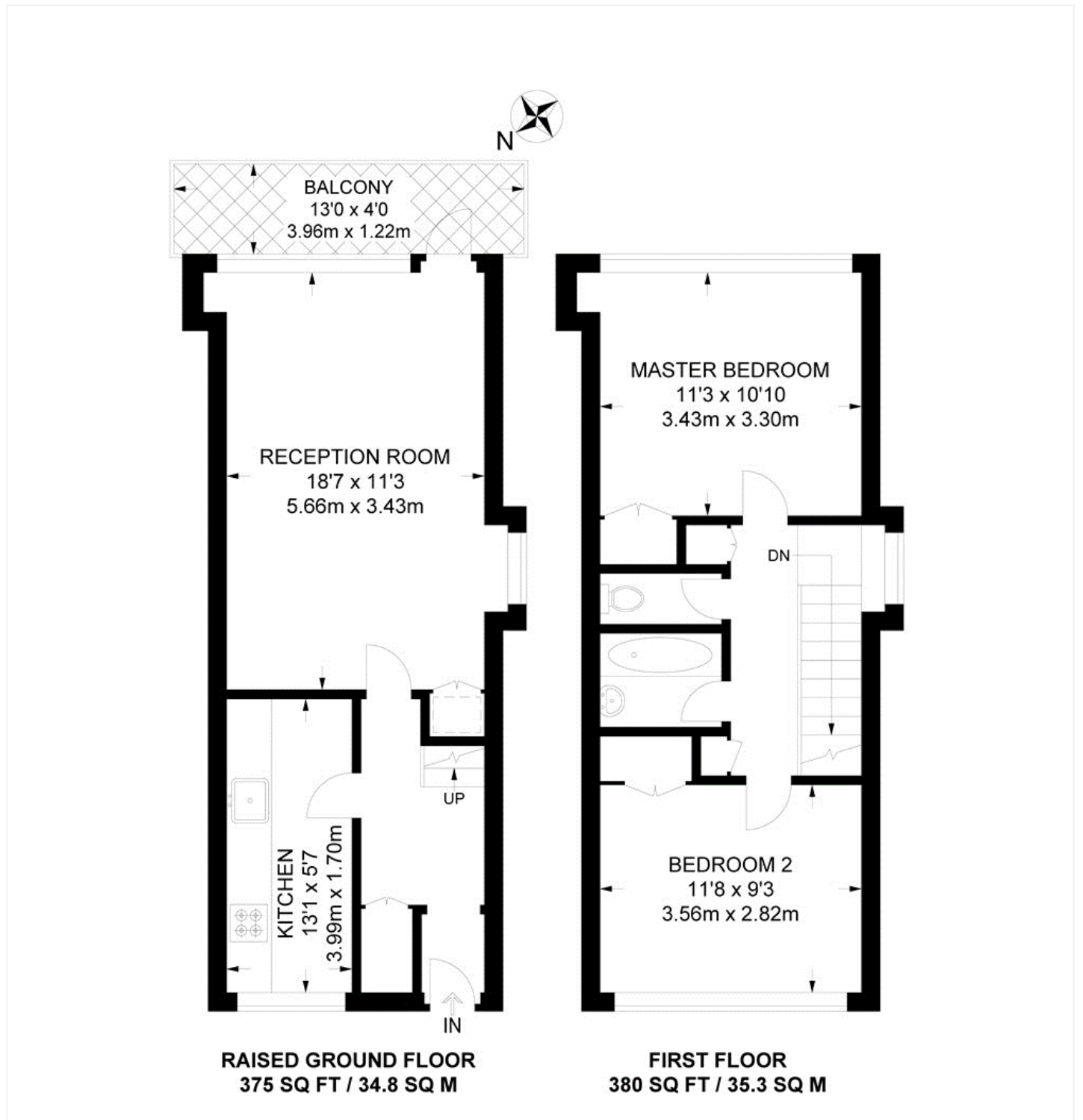

This floorplan is for illustration purposes only and is not to scale. The position and size of doors, windows, appliances and other features are approximate.

Dulwich | 020 8299 2722 | dulwich@winkworth.co.uk



winkworth.co.uk

See things differently

Winkworth wishes to inform prospective buyers and tenants that these particulars are a guide and act as information only. All our details are given in good faith and believed to be correct at the time of printing but they don't form part of an offer or contract. No Winkworth employee has authority to make or give any representation or warranty in relation to this property. All fixtures and fittings, whether fitted or not are deemed removable by the vendor unless stated otherwise and room sizes are measured between internal wall surfaces, including furnishings.