



CHESTERTON ROAD, LONDON, W10
£2,145 PER MONTH

ONE BEDROOM APARTMENT ON THE RAISED GROUND FLOOR OF A GORGEOUS PERIOD BUILDING

North Kensington | 020 7792 5000 | northkensington@winkworth.co.uk

Winkworth

for every step...

winkworth.co.uk



DESCRIPTION:

A gorgeous one bedroom raised ground floor apartment situated in the heart of Ladbroke Grove on the sought after Chesterton Road. The property offers stunning period features, with high ceilings and a good amount of natural light. Comprises a separate modern kitchen, bright spacious reception room, large double bedroom and a bathroom.

Chesterton Road is a lovely tree-lined residential street offering quick access to a number of transport links and the trendy gastro bars, restaurants and shops of Portobello Road.

AT A GLANCE

- GREAT LOCATION
- STUNNING TREE LINED RESIDENTIAL ROAD
- CLOSE TO TRANSPORT LINKS
- CLOSE TO PORTOBELLO ROAD
- SPACIOUS



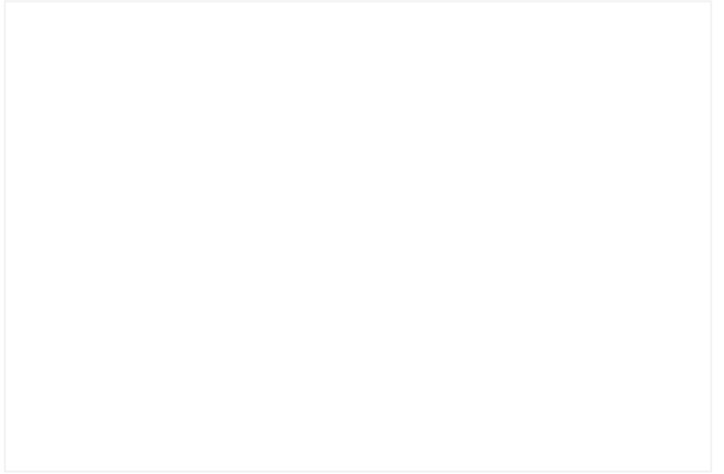
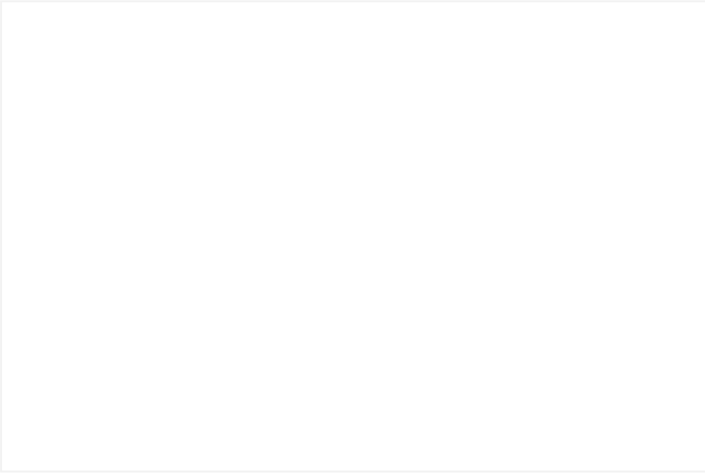
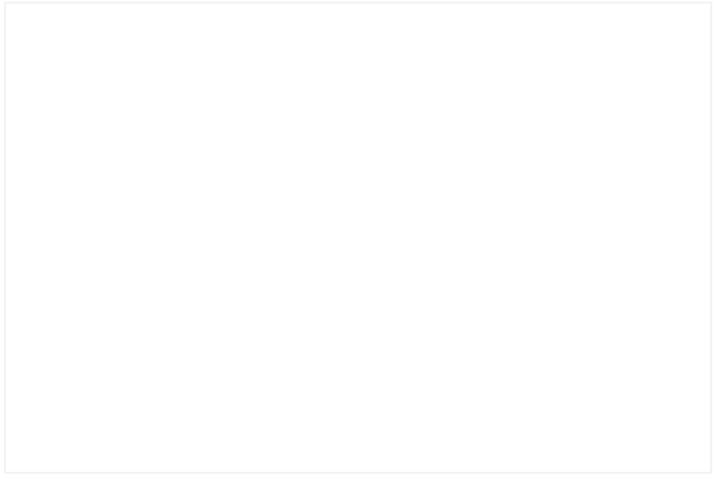

Chesterton Road

Approx. Gross Internal Area 505 Sq Ft - 46.92 Sq M

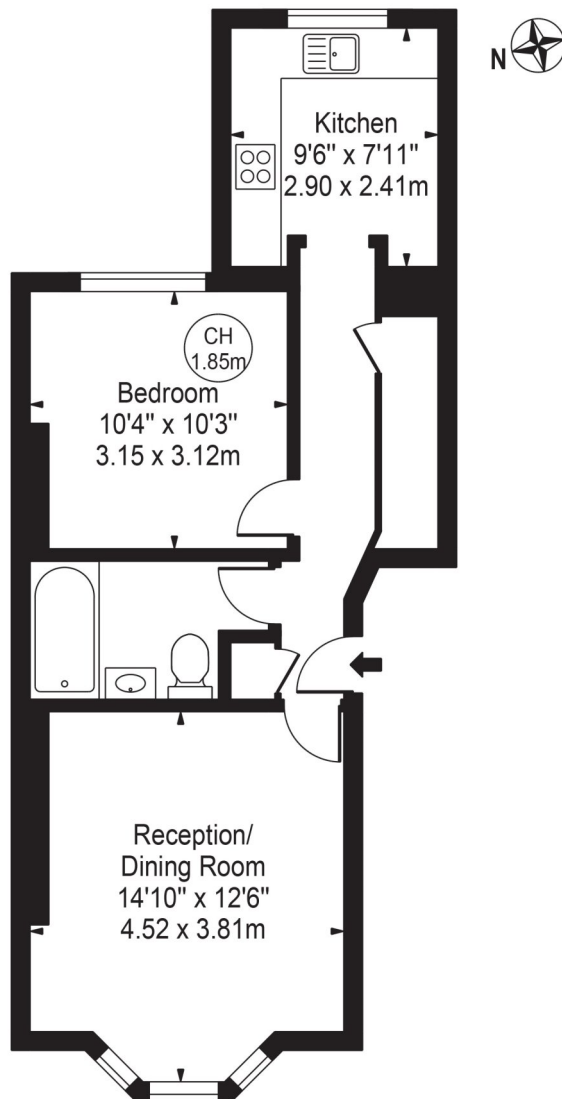

Ground Floor

For Illustration Purposes Only - Not To Scale

This floor plan should be used as a general outline for guidance only and does not constitute in whole or in part an offer or contract. Any intending purchaser or lessee should satisfy themselves by inspection, searches, enquiries and full survey as to the correctness of each statement. Any areas, measurements or distances quoted are approximate and should not be used to value a property or be the basis of any sale or let.

Copyright Morriarti Photography & Design LTD

This floorplan is for illustration purposes only and is not to scale. The position and size of doors, windows, appliances and other features are approximate.

North Kensington | 020 7792 5000 | northkensington@winkworth.co.uk

Winkworth

for every step...

winkworth.co.uk

Winkworth wishes to inform prospective buyers and tenants that these particulars are a guide and act as information only. All our details are given in good faith and believed to be correct at the time of printing but they don't form part of an offer or contract. No Winkworth employee has authority to make or give any representation or warranty in relation to this property. All fixtures and fittings, whether fitted or not are deemed removable by the vendor unless stated otherwise and room sizes are measured between internal wall surfaces, including furnishings.