

Sloane Court East, London, SW3  
£1,150,000 *LEASEHOLD*

2  1  2 



Winkworth Knightsbridge & Chelsea  
020 7589 6616 | [knightsbridge@winkworth.co.uk](mailto:knightsbridge@winkworth.co.uk)

**Winkworth**  
for every step...

## Turnkey Chelsea home with walk-in wardrobe, porter and prime SW3 address

---

### ABOUT THIS FLAT

This lower ground floor apartment in Sloane Court East offers 975 sq. ft. of well-planned living space in one of Chelsea's most sought-after addresses.

Recently refurbished throughout, the flat is presented in turnkey condition with a clean, modern finish that works well within the character of a handsome period building. The accommodation is generous and practical. A bright reception and dining area sits at the heart of the property, with a sleek fitted kitchen designed with both storage and style in mind. The principal bedroom is particularly impressive, featuring an en suite bathroom and a walk-in wardrobe, while

the second double bedroom is served by a further bathroom. Both rooms are finished with the same attention to detail as the main living spaces. The building benefits from a porter, adding security and convenience. Outside your front door, Sloane Court East puts you within a short walk of Sloane Square, the boutiques and cafés of King's Road, and the world-class shopping of Knightsbridge. Hyde Park and South Kensington's museums are also close by, making this an ideal London home or pied-à-terre.

### KEY FEATURES

- 2 bedrooms
- 1 reception room
- 2 bathrooms
- 975 Square Feet
- Lower ground floor





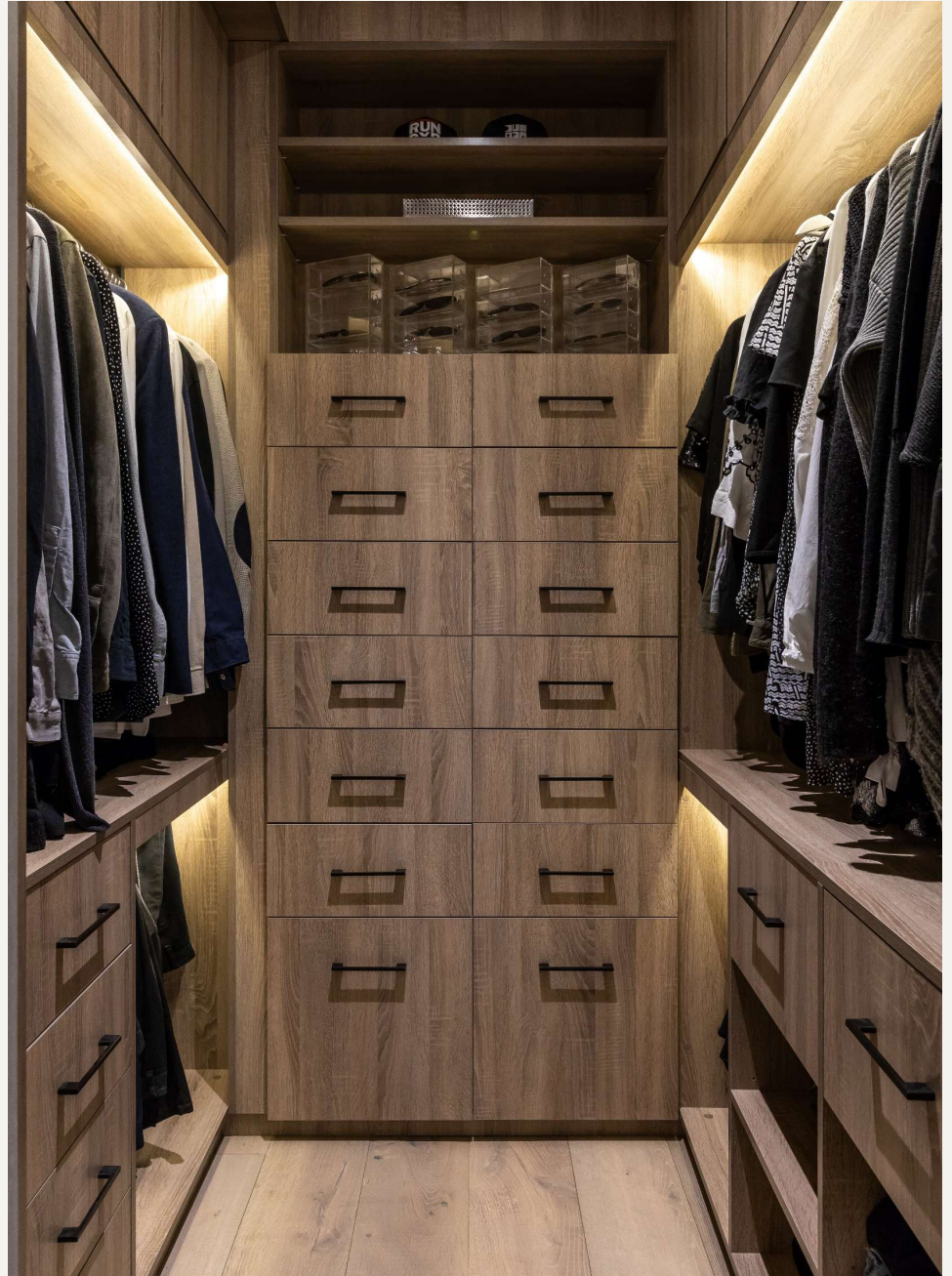





FINER DETAILS

- 2 bedrooms
- 1 reception room
- 2 bathrooms
- 975 Square Feet
- Lower ground floor

Score	Energy rating	Current	Potential
92+	A		
81-91	B		
69-80	C	76 C	76 C
55-68	D		
39-54	E		
21-38	F		
1-20	G		

SLOANE COURT EAST, SW6

Approximate gross internal area  
975 sq ft / 90.58 sq m

Key :  
CH - Ceiling Height

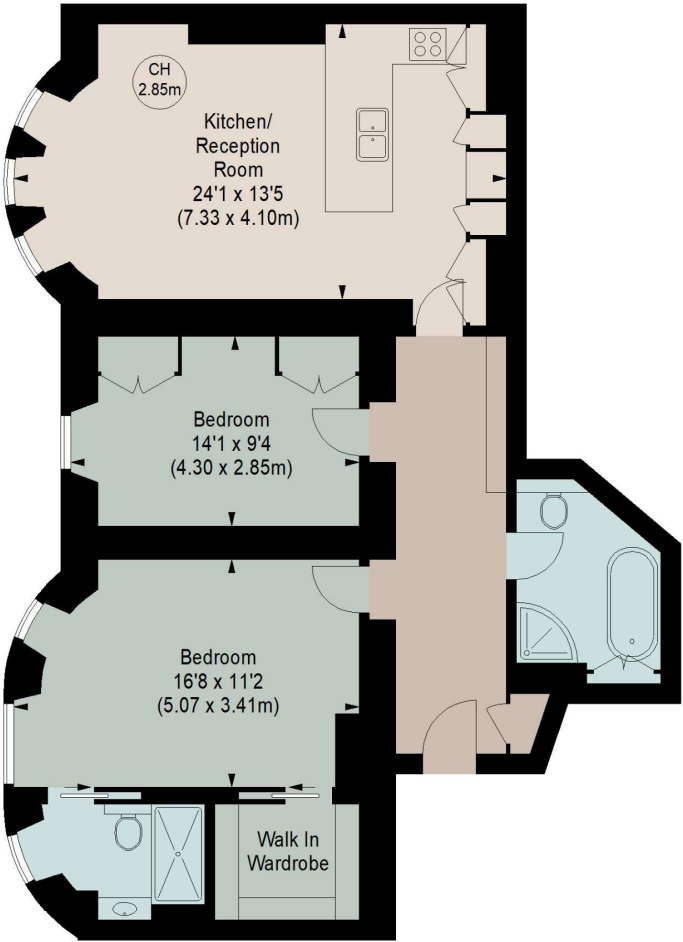

LOWER GROUND FLOOR

Although every attempt has been made to ensure accuracy, all measurements are approximate.  
This floorplan is for illustrative purposes only and not to scale.  
Measured in accordance with RICS standards.