



BULLHEAD ROAD, HERTFORDSHIRE, WD6
OFFERS IN EXCESS OF £600,000 FREEHOLD

THREE BEDROOM SEMI DETACHED HOUSE LOCATED ON THE SOUTH SIDE OF BOREHAMWOOD

Borehamwood | 020 8953 8899 | borehamwood@winkworth.co.uk



DESCRIPTION:

Located on the South side of Borehamwood and just a short walk from the highly regarded Monksmead primary and Yavneh Primary and Secondary Schools is this beautifully presented three bedroom semi-detached family house.

Comprising of a through lounge, kitchen diner and downstairs shower room/wc to the ground floor with three bedrooms and a family bathroom located on the first floor.

Externally there is a secluded rear garden complete with garden shed and off street parking for 2 cars.

Offered in good decorative order viewings come highly recommended.

AT A GLANCE

- 3 Bedrooms
- South Borehamwood
- Secluded Rear Garden
- Off Street Parking
- Gas Central Heating
- Double Glazed





Bullhead Road Borehamwood, WD6 1RL
Gross Internal Area 883 sq ft /82 sq metres

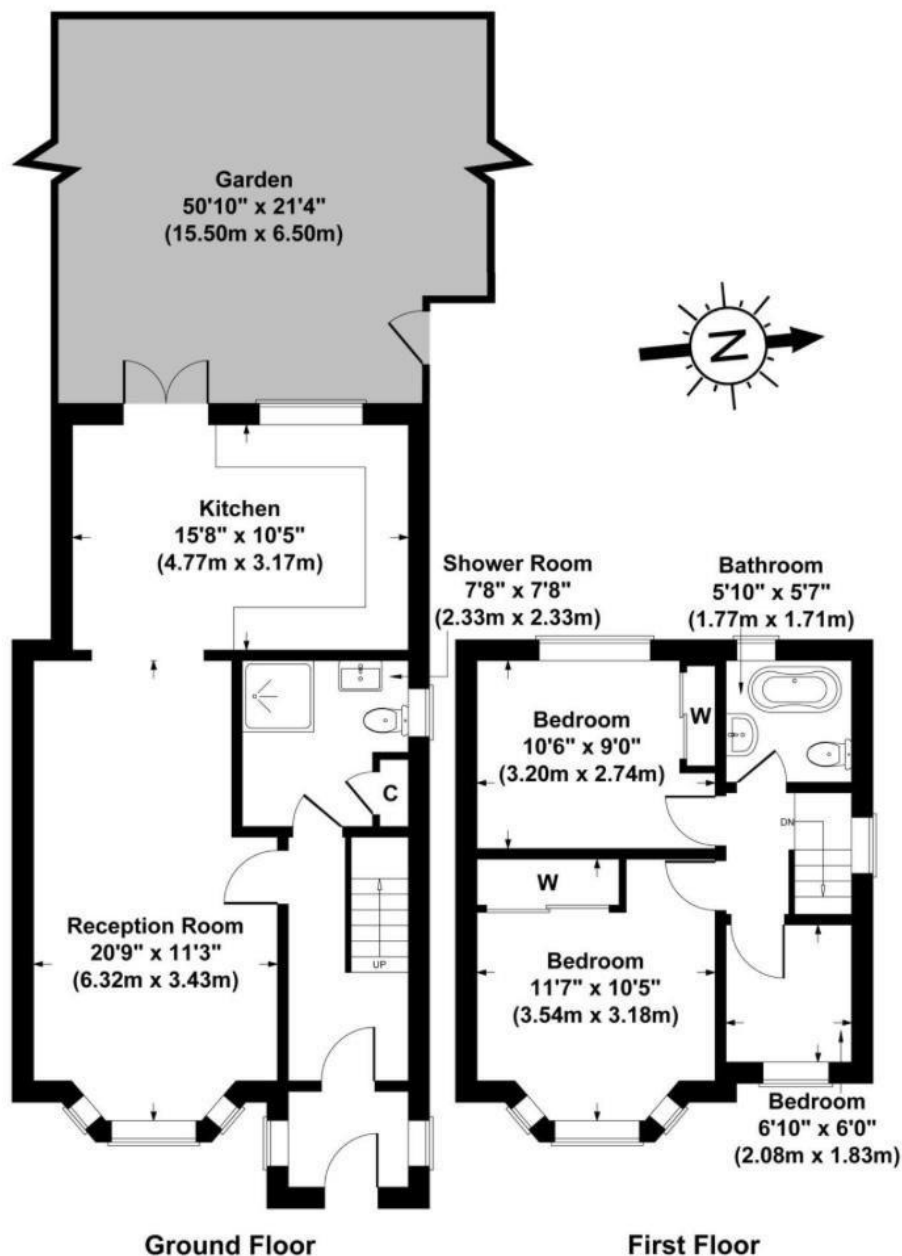

All measurements of walls, doors, windows, fittings and appliances, including their size and location, are shown as standard sizes and therefore cannot be regarded as a representation by the seller.

This floorplan is for illustration purposes only and is not to scale. The position and size of doors, windows, appliances and other features are approximate.

Score	Energy rating	Current	Potential
92+	A		
81-91	B		
69-80	C		
55-68	D		
39-54	E		
21-38	F		
1-20	G		

Tenure: Freehold

Term: 0 year and 0 months

Service Charge: £0 per annum

Ground Rent: £ 0 Annually (subject to increase)

Council Tax Band: D

Where no figures are shown, we have been unable to ascertain the information. All figures that are shown were correct at the time of printing.