



11 Silverwood Rise, Romsey, SO51 7AD

Winkworth



LOVELY FAMILY HOME

Silverwood Rise is situated in a quiet location on the outskirts of Romsey, many wonderful walks can be found on the doorstep. Romsey itself is a delightful old market town that has retained much of its original character and provides an excellent range of amenities for everyday needs including individual shops, schools, leisure facilities, doctors and dentist surgeries, restaurants and public houses. Romsey also has a local railway station connecting with mainline services to London. The M27 can be accessed at junction 3, a short drive away, whilst the major centres of Salisbury, Southampton, Winchester and Portsmouth are all easily accessed.

11 Silverwood Rise is a beautifully presented, modern two-bedroom semi-detached home in a lovely location. Local amenities, within a 10-minute walk, include a family friendly pub and convenience store. Maintained to a very high standard the property offers two bedrooms, living room, kitchen/dining room and conservatory. As you enter the property the spacious hallway leads to all principal ground floor rooms, the contemporary kitchen/dining room to the front elevation, is fitted with a wide range of base and eye level units and is large enough to accommodate a dining table. The sitting room leads onto a conservatory which overlooks the rear garden. To complete the ground floor accommodation is a cloak room. To the first floor are two bedrooms, and a contemporary family bathroom.

As you approach the property there is allocated parking for two vehicles. The rear garden offers a patio/decked area, perfect for entertaining. The remainder of the garden is mainly laid to lawn with raised flower beds and a useful garden shed.

*The purchase price is 75% of the value with no rent to be paid on the remaining 25% Additional amounts can be purchased at any time up to the full 100%



Winkworth

**Address: 11 Silverwood Rise,
Romsey SO51 7AD**

**Council Tax – 'D'
75% Share as per details.**



GROUND FLOOR
44.1 sq.m. (475 sq.ft.) approx.



LEVEL 1
37.4 sq.m. (402 sq.ft.) approx.

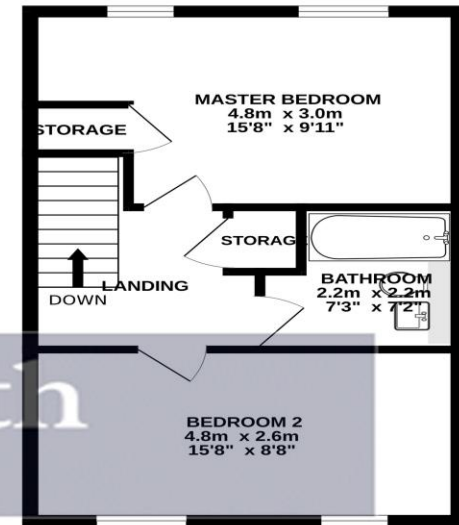

SILVERWOOD RISE, ROMSEY
TOTAL FLOOR AREA: 81.5 sq.m. (877 sq.ft.) approx.
Measurements are approximate. Not to scale. Illustrative purposes only.
Made with Metropix ©2023

winkworth.co.uk/romsey

Winkworth Romsey

18 Market Place, Romsey, Hampshire, SO51 8NA
01794 511911 | romsey@winkworth.co.uk

winkworth.co.uk/romsey

Winkworth Winchester

2 Black Swan Buildings, Southgate Street,
Winchester, Hampshire, SO23 9DT
01962 866777 | winchester@winkworth.co.uk

Winkworth Mayfair & Country House Department

11 Berkeley Street, Mayfair, London, W1J 8DS
020 7871 0589 | countryhouse@winkworth.co.uk

Winkworth

See things differently