



ERASMUS STREET, UK, SW1P

£465,000

LEASEHOLD

At a glance...

- Double Bedroom
- Open Plan Kitchen / Reception
- Bathroom
- Storage
- Ground Floor

Winkworth

for every step...



Energy Efficiency Rating		
	Current	Potential
Very energy efficient - lower running costs		
(92+) A		
(81-91) B		
(69-80) C		80
(55-68) D		
(39-54) E	47	
(21-38) F		
(1-20) G		
Not energy efficient - higher running costs		
England, Scotland & Wales	EU Directive 2002/91/EC	

ERASMUS STREET, UK, SW1P

£465,000

LEASEHOLD

A superb, one double bedroom apartment located in the highly desirable Millbank Estate in the heart of Westminster. The property would make an ideal first time buy, rental investment or pied-a-terre and is brought to the market with no onward chain.

Presented in excellent decorative order throughout, accommodation comprises a generous open plan reception with space to dine and entertain, double bedroom, modern bathroom and an abundance of built-in storage.

Turner House is located on Erasmus Street and ideally positioned for the Tate Britain and the landscaped Millbank Gardens. The convenient location provides easy access to the local shops, cafes and restaurants in Westminster, Victoria, Pimlico and St James's.

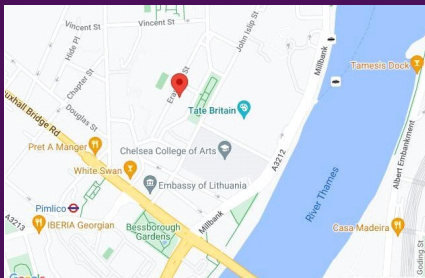

winkworth wishes to inform prospective buyers and tenants that these particulars are a guide and act as information only. All our details are given in good faith and believed to be correct at the time of printing but they don't form part of an offer or contract. No Winkworth employee has authority to make or give any representation or warranty in relation to this property. All fixtures and fittings, whether fitted or not are deemed removable by the vendor unless stated otherwise and room sizes are measured between internal wall surfaces - including fire-chimneys.

Turner House, SW1P



Approx. Gross Internal Area
440 Sq Ft - 40.88 Sq M

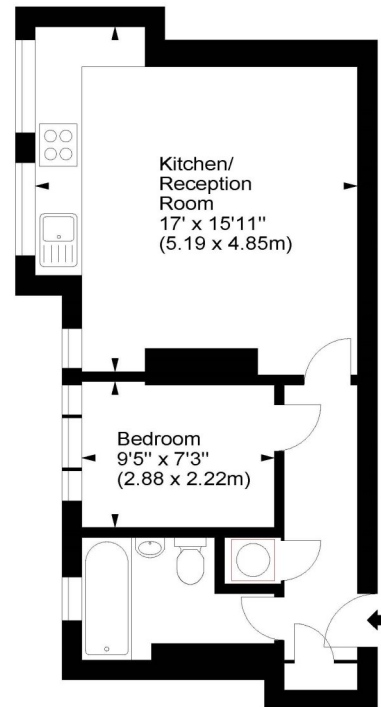

Ground Floor

For illustration purposes only. Not to scale.
All measurements are taken and shown at floor level.
www.r3photography.co.uk © Photography / Floor Plans / Lease Plans / EPCs



Pimlico & Westminster

020 7828 1786

pimlico@winkworth.co.uk

winkworth.co.uk/pimlico-westminster

Winkworth

for every step...