



ASHBOURNE GROVE, EAST DULWICH, LONDON, SE22
£1,250,000 FREEHOLD

**PRESENTED TO THE MARKET IS THIS
 STUNNING THREE BEDROOM SEMI
 DETACHED HOUSE IN THE HEART OF SE22.**

Dulwich | 020 8299 2722 | dulwich@winkworth.co.uk

Tenure Freehold | Council Tax Band F – London Borough of Southwark | Service Charge
 TBC | Ground Rent TBC

Winkworth

winkworth.co.uk

See things differently



DESCRIPTION:

Presented to the market is this stunning three bedroom semi-detached house in the heart of SE22. Located on the ever sought after road Ashbourne Grove, the property boasts off street parking and side access to the sizeable south facing garden. The property comprises of three double bedrooms, three reception rooms as well as two family sized bathrooms.

With massive potential to extend this is the perfect opportunity for those looking to put their own stamp on an already stunning family home. Easy links to London bridge can be found via East Dulwich Station which is a short walk from the property. For more links, a short bus ride from Lordship lane will take you to Denmark Hill.

AT A GLANCE

- Three Double Bedrooms
- Three Reception Rooms
- Large Kitchen/Diner
- Two Family Sized Bathrooms
- Large South-Facing Rear Garden
- Potential To Extend (STPP)
- Fantastic Location





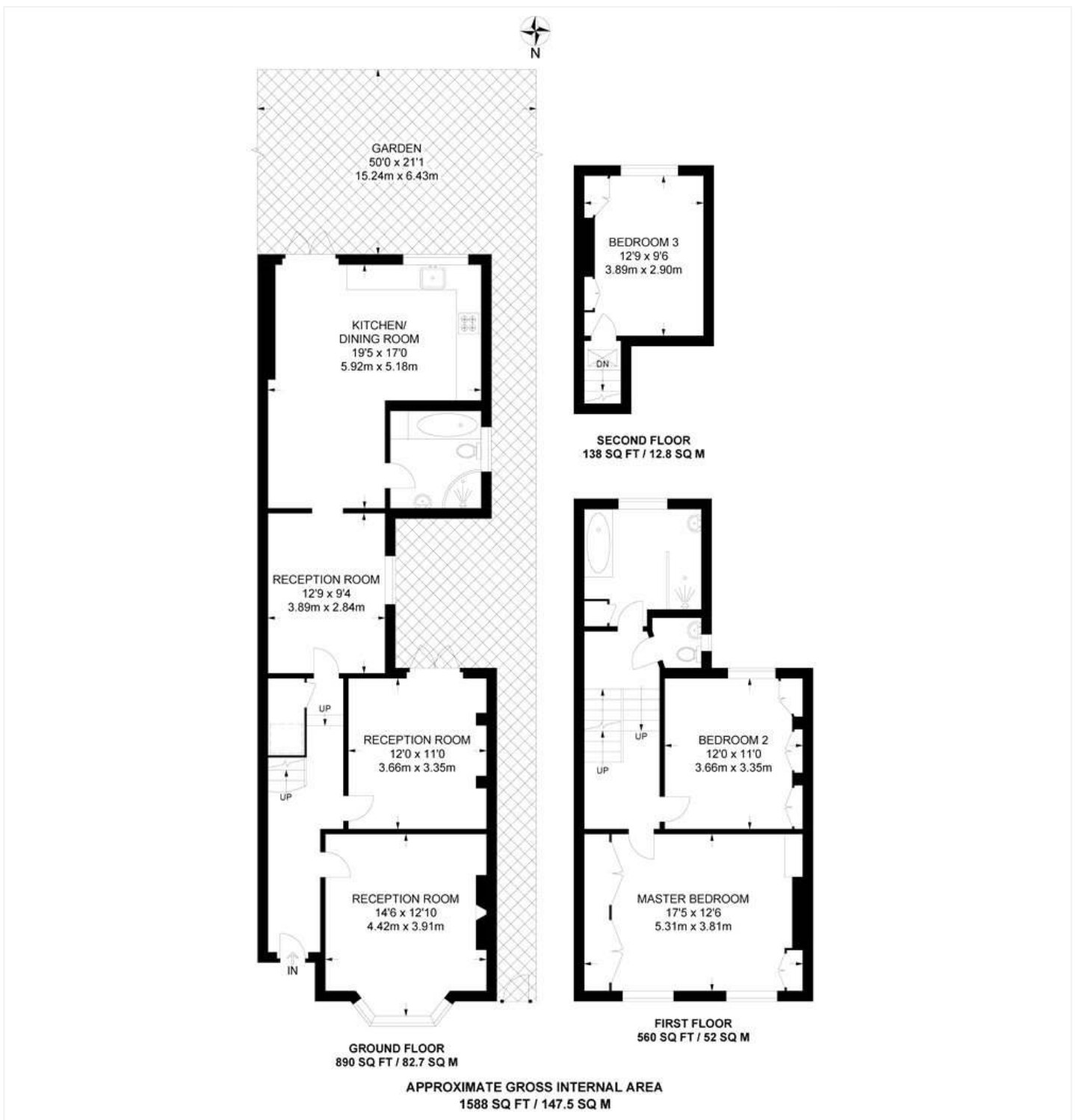

This floorplan is for illustration purposes only and is not to scale. The position and size of doors, windows, appliances and other features are approximate.

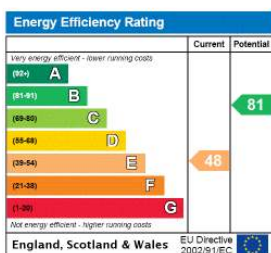

Dulwich | 020 8299 2722 | dulwich@winkworth.co.uk

Winkworth

winkworth.co.uk

See things differently

Winkworth wishes to inform prospective buyers and tenants that these particulars are a guide and act as information only. All our details are given in good faith and believed to be correct at the time of printing but they don't form part of an offer or contract. No Winkworth employee has authority to make or give any representation or warranty in relation to this property. All fixtures and fittings, whether fitted or not are deemed removable by the vendor unless stated otherwise and room sizes are measured between internal wall surfaces, including furnishings.