



ANERLEY PARK, PENGE, LONDON, SE20
£1,250 PER MONTH UNFURNISHED

A TWO DOUBLE BEDROOM FLAT WITH PRIVATE BALCONY

Crystal Palace | 02038693222 | crystalpalace@winkworth.co.uk

Tenant Fees Apply: Details of fees for tenant referencing, tenancy agreement admin fees and renewal fees are available on the Winkworth website and the link can be found with the displayed rent for the property. Tenants should ensure they are fully conversant with these upfront fees and other costs that are involved at the outset of the tenancy before making an offer to rent and your local Winkworth office will provide written details upon request.

winkworth.co.uk

Winkworth

for every step...



DESCRIPTION:

Located on the desirable Anerley Park we are delighted to bring to the market this two bedroom top floor flat. The accommodation comprises; open plan kitchen/reception, two double bedrooms and bathroom. The property further benefits from a private balcony/terrace, use of communal garden and off street parking on a first come first serve basis. The property is located only moments from Penge West station as well as Crystal Palace park and station.

Winkworth

for every step...



Winkworth

for every step...

Anerley Park, SE20

Approx. Gross Internal Floor Area 676 sq. ft / 62.82 sq. m (Including Restricted Height Area)

Approx. Gross Internal Floor Area 650 sq. ft / 60.40 sq. m (Excluding Restricted Height Area)

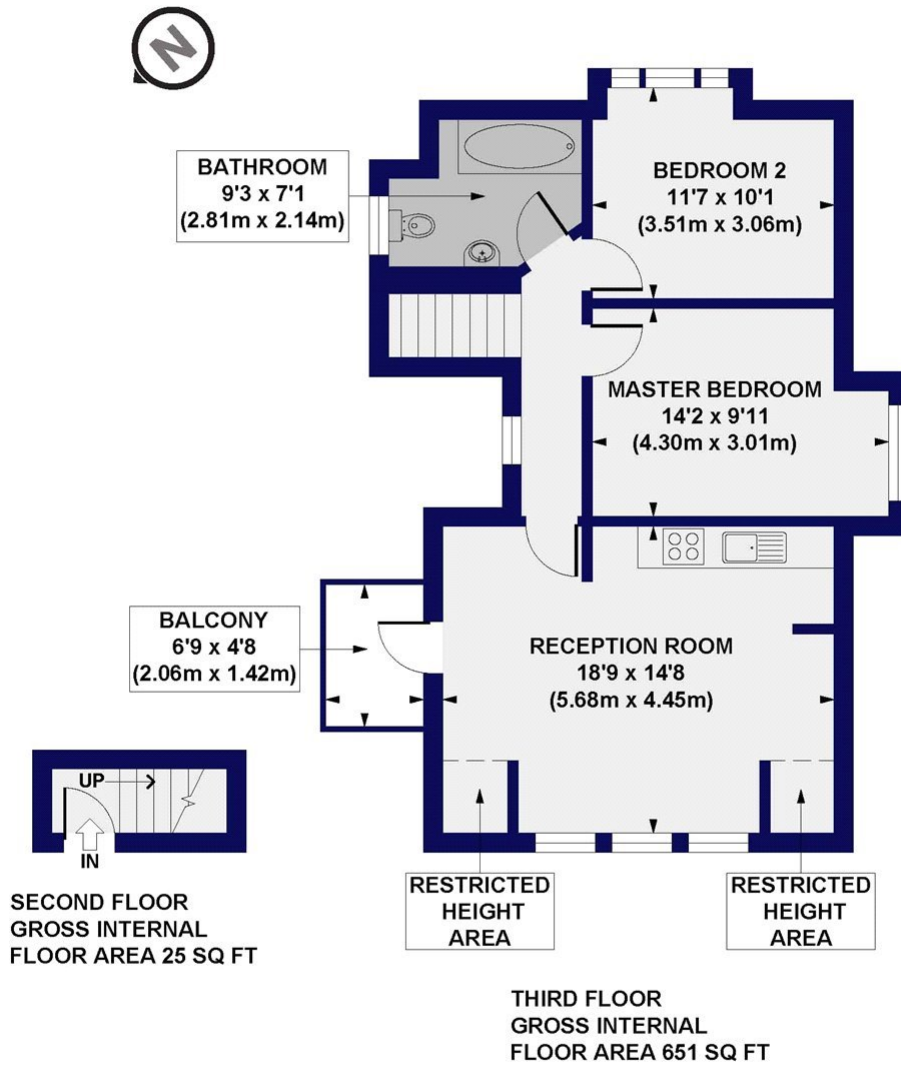

All measurements of walls, doors, windows, fittings and appliances, including their size and location, are shown as standard sizes and do not constitute any warranty or representation by the seller, their agent or CP Creative. Any intending purchaser must satisfy himself by inspection or otherwise as to the correctness of the information contained in these plans. This plan is for illustrative purposes only and should be used as such by any prospective purchasers.

Winkworth

This floorplan is for illustration purposes only and is not to scale. The position and size of doors, windows, appliances and other features are approximate.

Crystal Palace | 02038693222 | crystalpalace@winkworth.co.uk

Winkworth

for every step...

winkworth.co.uk

Winkworth wishes to inform prospective buyers and tenants that these particulars are a guide and act as information only. All our details are given in good faith and believed to be correct at the time of printing but they don't form part of an offer or contract. No Winkworth employee has authority to make or give any representation or warranty in relation to this property. All fixtures and fittings, whether fitted or not are deemed removable by the vendor unless stated otherwise and room sizes are measured between internal wall surfaces, including furnishings.