



GLENWOOD AVENUE, NW9
£650,000 OIEO (OFFERS IN EXCESS OF) FREEHOLD

TWO BEDROOM DETACHED BUNGALOW - WELSH HARP LOCATION

Kingsbury | 020 8204 0000 | kingsbury@winkworth.co.uk

Winkworth

for every step...

winkworth.co.uk



Winkworth
for every step...

DESCRIPTION:

A well sized detached bungalow situated in Glenwood Avenue, Kingsbury. The property has been fondly loved through generations and is ready for a new family to make their own and put their personal modern mark on. On offer are two double bedrooms, a well-lit lounge, adjoining dining room, a simple kitchen, a compact utility room, a basic bathroom, convenient space saving garage, and a stunning, lovingly maintained rear garden hosting an abundance of greenery and outdoor living space. Glenwood Avenue is located within the "Welsh Harp Reservoir" residence - home to boating/sailing clubs and lovely views across the waters. Local shopping amenities and bus routes can be found on Church Lane, with a wider range easily reachable in close by Hendon, Kingsbury, Colindale, and Wembley all also benefiting from London Underground and Thameslink links into the city. There are numerous places of worship, recreation grounds and well-established schools in close proximity. An internal viewing is a must. STPP (Subject to planning permission) you can also develop the rear/lot of the property



Winkworth
for every step...



Winkworth
for every step...

Winkworth

for every step...



Winkworth

for every step...

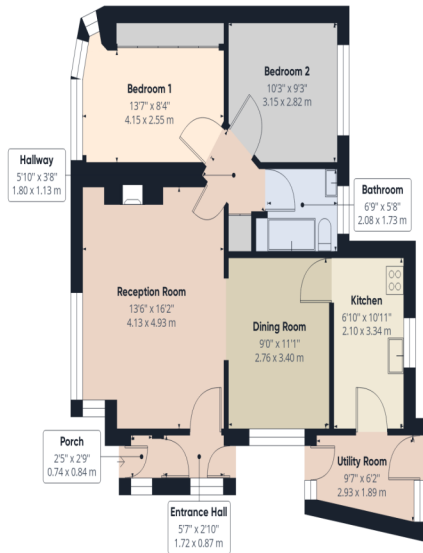

Ground Floor Building 1

Approximate total area¹

1100.79 ft²

102.27 m²



Ground Floor Building 2

(1) Excluding balconies and terraces

While every attempt has been made to ensure accuracy, all measurements are approximate, not to scale. This floor plan is for illustrative purposes only.

GIRAFFE360

This floorplan is for illustration purposes only and is not to scale. The position and size of doors, windows, appliances and other features are approximate.

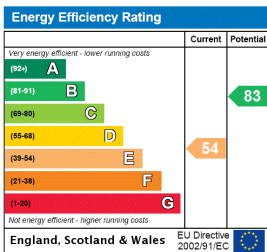

Kingsbury | 020 8204 0000 | kingsbury@winkworth.co.uk



for every step...

winkworth.co.uk

Winkworth wishes to inform prospective buyers and tenants that these particulars are a guide and act as information only. All our details are given in good faith and believed to be correct at the time of printing but they don't form part of an offer or contract. No Winkworth employee has authority to make or give any representation or warranty in relation to this property. All fixtures and fittings, whether fitted or not are deemed removable by the vendor unless stated otherwise and room sizes are measured between internal wall surfaces, including furnishings.