



KINGSWOOD PARK, LONDON, N3
OFFERS OVER £2,000,000 FREEHOLD

A FIVE BEDROOM, DOUBLE FRONTED, DETACHED FAMILY HOME, SET IN A QUIET CUL-DE-SAC IN THE MUCH SOUGHT AFTER CHURCH END AREA OF FINCHLEY.

Finchley | 020 8349 3388 | finchley@winkworth.co.uk

Winkworth

for every step...

winkworth.co.uk



DESCRIPTION:

Set in a quiet cul-de-sac off Hendon Avenue, we are pleased to offer this well-presented and extended double fronted detached family home, ideally located for local amenities, transport links and good Ofsted rated schools, as well as recreational parkland, such as Dollis Valley Green Walk, and Stephens House & Gardens. The ground floor comprises of a spacious entrance hallway, through-lounge, front reception room, fully fitted kitchen, utility room, downstairs WC, and rear garden.

To the first floor there are five double bedrooms (with an en-suite to primary bedroom) and family bathroom. Further benefits include an integral garage, external storage area, side access, ample off street parking and potential to extend further (stpp).

AT A GLANCE

- Desirable Church End location
- Double Fronted Detached family home
- Through-lounge
- Additional Reception Room
- Fully fitted kitchen
- Five bedrooms
- Off street parking
- Garage





Kingswood Road, N3

Approx. Gross Internal Floor Area 2285 sq. ft / 212.34 sq. m (Including Garage & Storage)

Approx. Gross Internal Floor Area 2027 sq. ft / 188.34 sq. m (Excluding Garage & Storage)

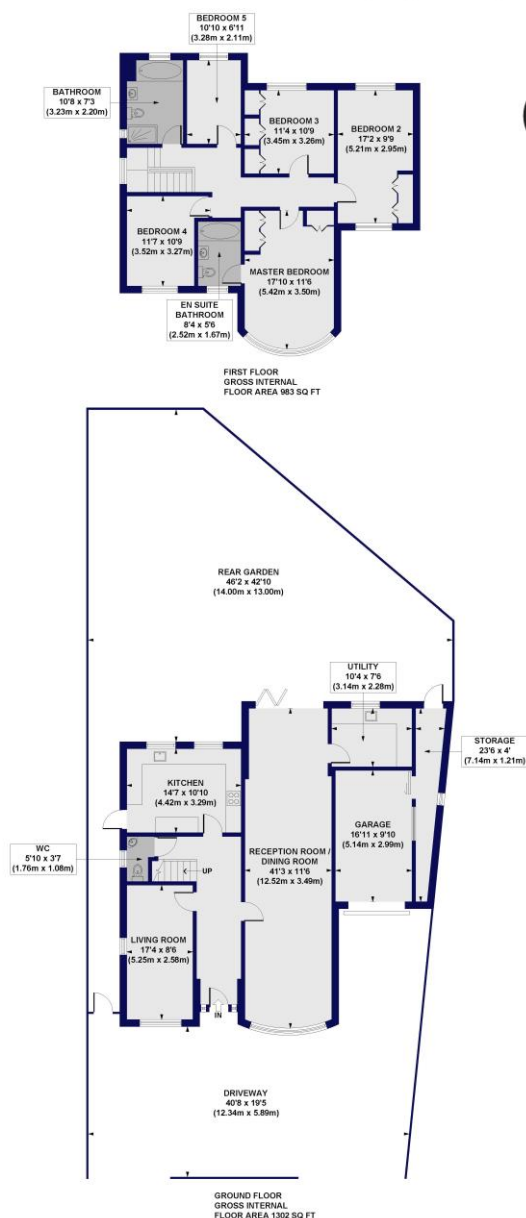

All measurements of walls, doors, windows, fittings and appliances, including their size and location, are shown as standard sizes and do not constitute any warranty or representation by the seller, their agent or CP Creative. Any intending purchaser must satisfy himself by inspection or otherwise as to the correctness of the information contained in these plans. This plan is for illustrative purposes only and should be used as such by any prospective purchasers.

Winkworth

This floorplan is for illustration purposes only and is not to scale. The position and size of doors, windows, appliances and other features are approximate.

Tenure: Freehold

Council Tax Band: G

Where no figures are shown, we have been unable to ascertain the information. All figures that are shown were correct at the time of printing.

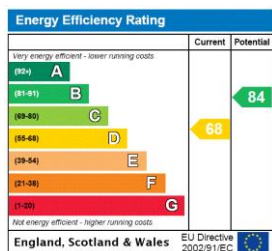

Finchley | 020 8349 3388 | finchley@winkworth.co.uk

winkworth.co.uk

Winkworth wishes to inform prospective buyers and tenants that these particulars are a guide and act as information only. All our details are given in good faith and believed to be correct at the time of printing but they don't form part of an offer or contract. No Winkworth employee has authority to make or give any representation or warranty in relation to this property. All fixtures and fittings, whether fitted or not are deemed removable by the vendor unless stated otherwise and room sizes are measured between internal wall surfaces, including furnishings.

Winkworth

for every step...