



DOWNING COURT, BENNINGTON DRIVE, BOREHAMWOOD, HERTFORDSHIRE, WD6
£1,500 PER MONTH PART FURNISHED

THIS WELL-PRESENTED TWO DOUBLE BEDROOM FIRST FLOOR FLAT LOCATED IN A POPULAR DEVELOPMENT

Borehamwood | 020 8953 8899 | borehamwood@winkworth.co.uk

Tenant Fees Apply: Details of fees for tenant referencing, tenancy agreement admin fees and renewal fees are available on the Winkworth website and the link can be found with the displayed rent for the property. Tenants should ensure they are fully conversant with these upfront fees and other costs that are involved at the outset of the tenancy before making an offer to rent and your local Winkworth office will provide written details upon request.

winkworth.co.uk

Winkworth

for every step...



DESCRIPTION:

This well-presented two bedroom first floor flat is located in a popular development off Gateshead Road. Benefitting from two double bedrooms, bright lounge/diner, modern fitted kitchen and family bathroom. The property includes double glazing, gas heating and off-street parking. Available from 2nd September '23 on a furnished or part furnished basis, viewings are highly recommended.

Winkworth

for every step...



Winkworth

for every step...

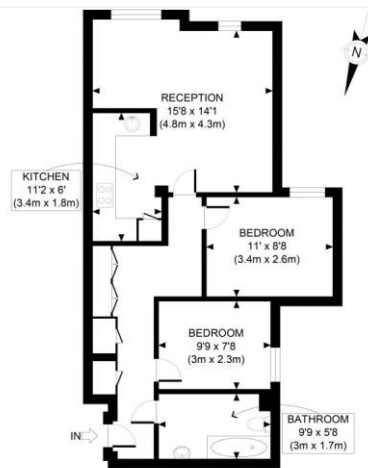

Ref: Copyright **photoplan** 

Disclaimer: Floor plan measurements are approximate and are for illustrative purposes only. While we do not doubt the floor plan accuracy and completeness, you or your advisors should conduct a careful, independent investigation of the property in respect of monetary valuation

This floorplan is for illustration purposes only and is not to scale. The position and size of doors, windows, appliances and other features are approximate.

Energy Efficiency Rating		
	Current	Potential
Very energy efficient - lower running costs		
(92-100) A		
(81-91) B	81	81
(69-80) C		
(55-68) D		
(39-54) E		
(21-38) F		
(1-20) G		
Not energy efficient - higher running costs		
England, Scotland & Wales EU Directive 2002/91/EC 		

Borehamwood | 020 8953 8899 | borehamwood@winkworth.co.uk

Winkworth

for every step...

winkworth.co.uk

Winkworth wishes to inform prospective buyers and tenants that these particulars are a guide and act as information only. All our details are given in good faith and believed to be correct at the time of printing but they don't form part of an offer or contract. No Winkworth employee has authority to make or give any representation or warranty in relation to this property. All fixtures and fittings, whether fitted or not are deemed removable by the vendor unless stated otherwise and room sizes are measured between internal wall surfaces, including furnishings.