



WILD CLOSE, READING, BERKSHIRE, RG6 4JQ
£1,200 PER MONTH UNFURNISHED

**FIRST FLOOR, TWO DOUBLE BEDROOM,
UNFURNISHED MAISONETTE IN LOWER
EARLEY.**

Reading | 0118 4022 300 | reading@winkworth.co.uk

Winkworth

for every step...

winkworth.co.uk



DESCRIPTION:

Two bedroom first floor maisonette positioned in a quiet location of Lower Earley. The property comprises two double bedrooms, a spacious reception room, separate kitchen and a three piece bathroom. Additional benefits include off road residents parking. The property is located close to local bus routes and has good access to the M4 and A329M. Available 29th September 2025. Unfurnished.

AT A GLANCE

- Two bedroom maisonette
- First floor
- Quiet location in Lower Earley
- Council tax band C
- Off road residents parking
- Available 29th September
- Unfurnished



GROUND FLOOR
35 sq.ft. (3.3 sq.m.) approx.

1ST FLOOR
552 sq.ft. (51.3 sq.m.) approx.

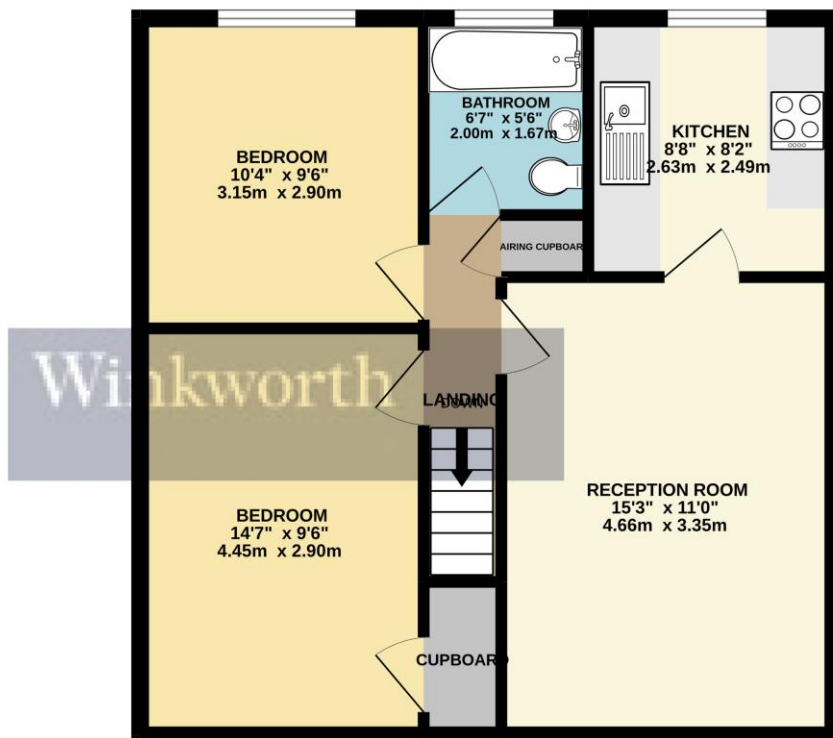

TOTAL FLOOR AREA : 587 sq.ft. (54.6 sq.m.) approx.
Whilst every attempt has been made to ensure the accuracy of the floorplan contained here, measurements of doors, windows, rooms and any other items are approximate and no responsibility is taken for any error, omission or mis-statement. This plan is for illustrative purposes only and should be used as such by any prospective purchaser. The services, systems and appliances shown have not been tested and no guarantee as to their operability or efficiency can be given.
Made with Metropix ©2022

This floorplan is for illustration purposes only and is not to scale. The position and size of doors, windows, appliances and other features are approximate.

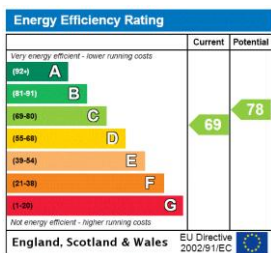

Deposit: £1,384.62

Holding Deposit: £276.92

Council Tax Band: C

Where no figures are shown, we have been unable to ascertain the information. All figures that are shown were correct at the time of printing.

Reading | 0118 4022 300 | reading@winkworth.co.uk

winkworth.co.uk

Winkworth wishes to inform prospective buyers and tenants that these particulars are a guide and act as information only. All our details are given in good faith and believed to be correct at the time of printing but they don't form part of an offer or contract. No Winkworth employee has authority to make or give any representation or warranty in relation to this property. All fixtures and fittings, whether fitted or not are deemed removable by the vendor unless stated otherwise and room sizes are measured between internal wall surfaces, including furnishings.

