



**BARNETTS COURT, CORBINS LANE, HARROW, MIDDLESEX, HA2**

**£100,000 LEASEHOLD**

**OVER 60'S ONLY!**

Tenure: Leasehold - Approximately 63 Years Remaining

Ground Rent: Peppercorn

Service Charge: £2,250.00 Per Annum

Council Tax Band: C (London Borough of Harrow)

EPC Rating: D

Harrow | 020 8861 3933 | harrow@winkworth.co.uk

**Winkworth**

for every step...

*winkworth.co.uk*



#### **DESCRIPTION:**

Winkworth Harrow are delighted to introduce this charming One Bedroom Retirement Flat in the heart of South Harrow. Barnetts Court provides a safe haven for those over 60 years of age, looking to begin their retirement in a tranquil, yet central location.

The apartment comprises a bright and airy reception room, a convenient fully fitted kitchen and a modern bathroom, complete with walk in shower.

Offered for sale with no ground rent, approximately 63 years of unexpired leasehold Barnetts Court offers warden assisted living and round the clock assistance, if needed.

Further benefits include a resident's lounge, unreserved parking to the front, laundry room and a warden's office.

Located on Corbins Lane, South Harrow's plethora of local shopping, dining and leisure facilities are only a stones throw away. South Harrow underground Station is conveniently located a mere 500 yards from the development.

Book your viewing now to avoid disappointment.





# Barnetts Court, Corbins Lane, HA2 8EU

Approx Gross Internal Area = 41.2 sq m / 443 sq ft

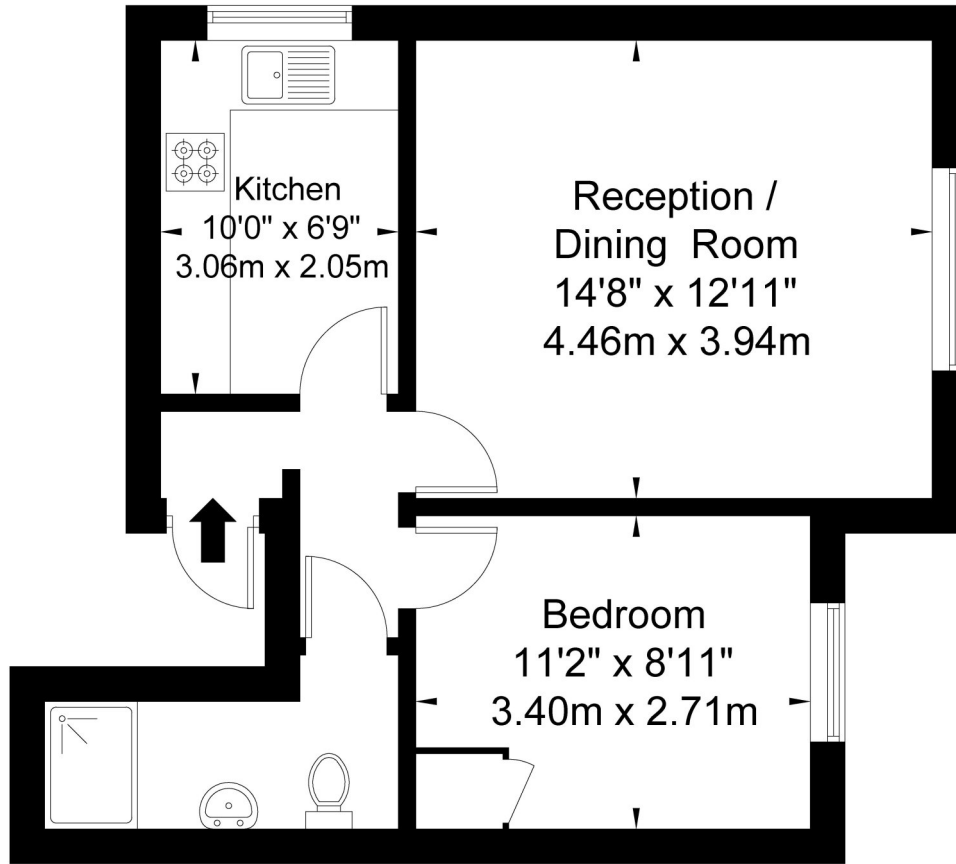
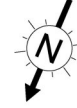

First Floor

Ref

Copyright **BLEU  
PLAN**

The Floor plan is not to scale and measurements and areas shown are approximate and therefore should be used for illustrative purposes only. The plan has been prepared in accordance with the RICS code of Measuring Practice and whilst we have confidence in the information produced it must not be relied on. If there is any aspect of particular importance, you should carry out or commission your own inspection of the property.  
Copyright @ BLEUPLAN

This floorplan is for illustration purposes only and is not to scale. The position and size of doors, windows, appliances and other features are approximate.

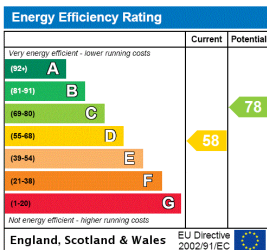

Harrow | 020 8861 3933 | harrow@winkworth.co.uk

for every step...

winkworth.co.uk

Winkworth wishes to inform prospective buyers and tenants that these particulars are a guide and act as information only. All our details are given in good faith and believed to be correct at the time of printing but they don't form part of an offer or contract. No Winkworth employee has authority to make or give any representation or warranty in relation to this property. All fixtures and fittings, whether fitted or not are deemed removable by the vendor unless stated otherwise and room sizes are measured between internal wall surfaces, including furnishings.