



GREENSIDE, BOREHAMWOOD, WD6

£450,000 FREEHOLD

A CHAIN FREE THREE BEDROOM SEMI DETACHED FAMILY HOUSE WITH GARAGE.

Borehamwood | 020 8953 8899 | borehamwood@winkworth.co.uk



DESCRIPTION:

Marketed for the first time since its construction in circa 1990 is this Chain Free Three Bedroom semi detached house with Southerly rear garden backing parkland.

In need of updating, the property currently provides in excess of 900 square feet of well proportioned accommodation and offers scope to extend, subject to the usual planning consents.

Located close to several "Good" Ofsted rated schools including Woodlands and Cowley Hill Primary schools and within easy of local shops and bus routes the property is an ideal family home.

AT A GLANCE

- 3 Bedrooms
- Chain Free
- Southerly Rear Garden Backing Parkland
- Gas Central Heating
- Double Glazed
- Garage
- Guest WC
- 902 Square Feet





Approximate Gross Internal Area
(Including External Store) = 83.8 sq m / 902 sq ft
Garage = 11.6 sq m / 125 sq ft
Total = 95.4 sq m / 1027 sq ft

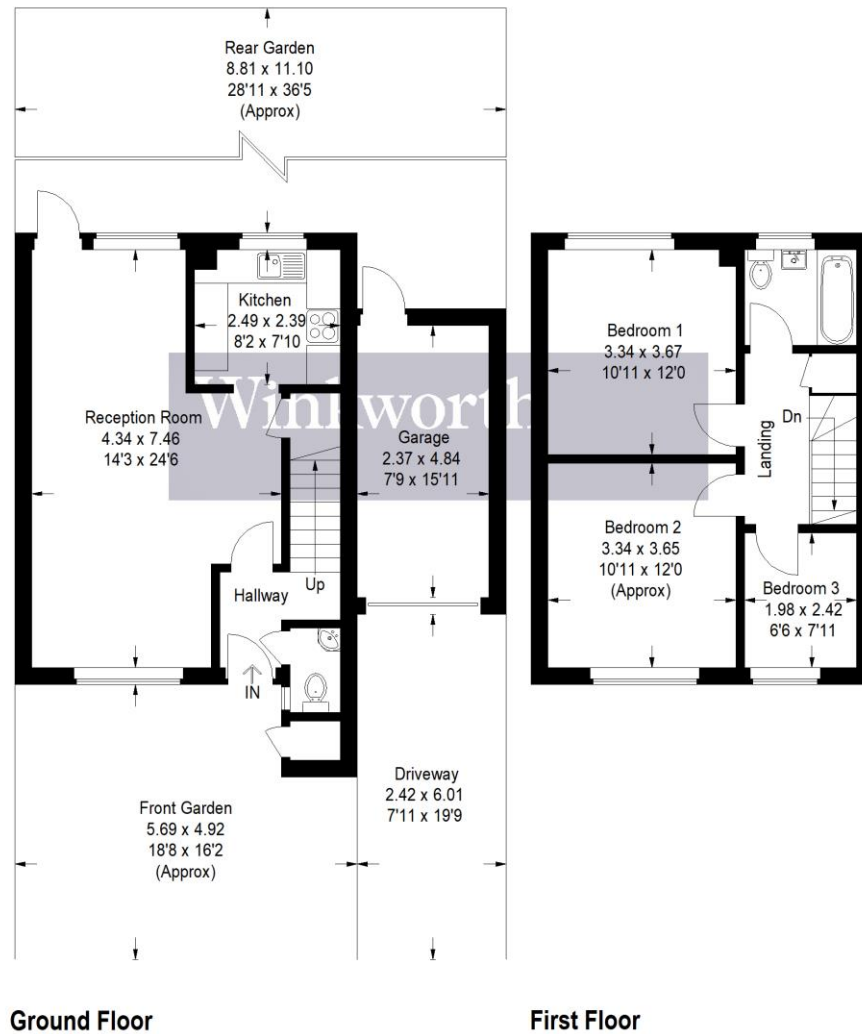
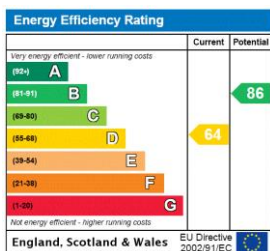

Illustration for identification purposes only, measurements are approximate, not to scale. Winkworth © 2021 (ID805342)

This floorplan is for illustration purposes only and is not to scale. The position and size of doors, windows, appliances and other features are approximate.



Borehamwood | 020 8953 8899 | borehamwood@winkworth.co.uk