



VESAGE COURT, 8A LEATHER LANE, LONDON, EC1N
£450,000 LEASEHOLD

**A ONE BEDROOM APARTMENT ON THE EIGHT
FLOOR OF VESAGE COURT, ON LEATHER LANE.**

Clerkenwell | 020 7405 1288 | clerkenwell@winkworth.co.uk

Winkworth

for every step...

winkworth.co.uk



DESCRIPTION:

The property comprises open-plan kitchen/living area with balcony, large double bedroom with sliding doors opening onto the lounge, separate study/storage room and a bathroom.

Vesage Court is an ex-Local Authority building, built in the 1970s. The property is walking distance to Fleet Street, the City, St Bartholomew's Hospital, Barrister's Chambers at Gray's Inn Gardens, Law Courts, University of London campuses, London School of Economics and King's College.

Farringdon and Chancery Lane tube stations are within 0.3 miles of the property.

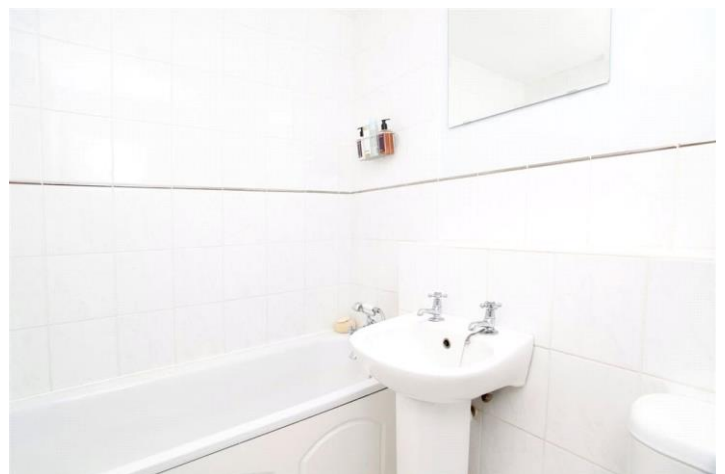

Winkworth

for every step...



Winkworth

for every step...

Leather Lane, EC1N

Approximate Gross Internal Area :-
49 sq m / 527 sq ft

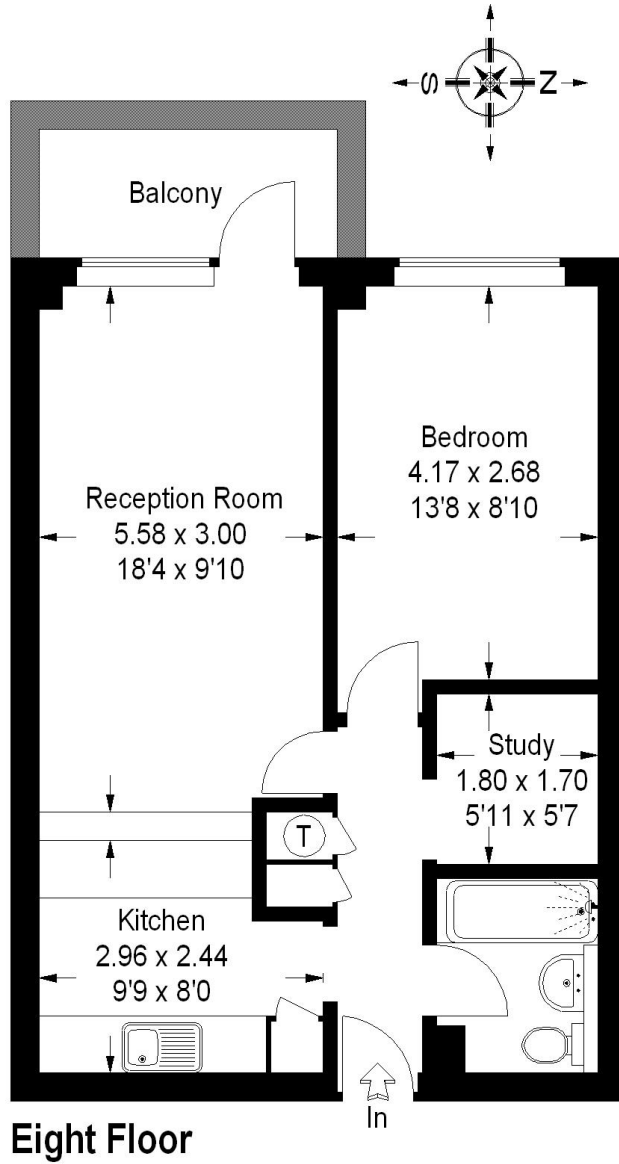

Eight Floor

FLOORPLANZ © 2012 0845 6344080 Ref 96598

This plan is for layout guidance only. Not drawn to scale unless stated. Windows & door openings are approximate. Whilst every care is taken in the preparation of this plan, please check all dimensions, shapes & compass bearings before making any decisions reliant upon them.

This floorplan is for illustration purposes only and is not to scale. The position and size of doors, windows, appliances and other features are approximate.

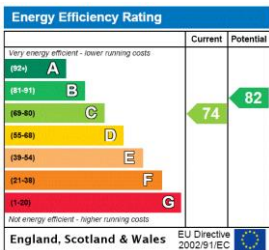

Clerkenwell | 020 7405 1288 | clerkenwell@winkworth.co.uk

for every step...

winkworth.co.uk

Winkworth wishes to inform prospective buyers and tenants that these particulars are a guide and act as information only. All our details are given in good faith and believed to be correct at the time of printing but they don't form part of an offer or contract. No Winkworth employee has authority to make or give any representation or warranty in relation to this property. All fixtures and fittings, whether fitted or not are deemed removable by the vendor unless stated otherwise and room sizes are measured between internal wall surfaces, including furnishings.