



**AVANTGARDE TOWER, 1 AVANTGARDE PLACE, LONDON, E1**  
**£750 PER WEEK FURNISHED**

**A HIGHLY DESIRABLE TWO BEDROOM TWO  
 BATHROOM APARTMENT WITH UNBEATABLE VIEWS  
 OF THE CITY.**

**Shoreditch** | 020 7749 7650 | [shoreditch@winkworth.co.uk](mailto:shoreditch@winkworth.co.uk)

Tenant Fees Apply: Details of fees for tenant referencing, tenancy agreement admin fees and renewal fees are available on the Winkworth website and the link can be found with the displayed rent for the property. Tenants should ensure they are fully conversant with these upfront fees and other costs that are involved at the outset of the tenancy before making an offer to rent and your local Winkworth office will provide written details upon request.

[winkworth.co.uk](http://winkworth.co.uk)

**Winkworth**

See things differently



## DESCRIPTION:

An outstanding fourteenth floor apartment in the Avant Garde Tower moments from Shoreditch High Street Station and benefitting from triple aspect panoramic views of the City from the stylish living space. The master bedroom and living room have large balconies facing the Square Mile where you can enjoy summer evenings watching the City below. The property comprises two double bedrooms, two bathrooms and a high quality fitted kitchen with granite work tops and the apartment has a comfort cooling system. The building enjoys a resident's lounge, 24hr concierge service and a communal gym.

Located just 100m from Shoreditch High Street Station and comfortable walking distance to the Square Mile and Liverpool Street Station. Hoxton Square is nearby as are all the fashionable aspects of Shoreditch.

**Winkworth**



Winkworth



## Avant Garde Tower, E1

Approx. Gross Internal Area 792 sq. ft / 73.60 sq. m

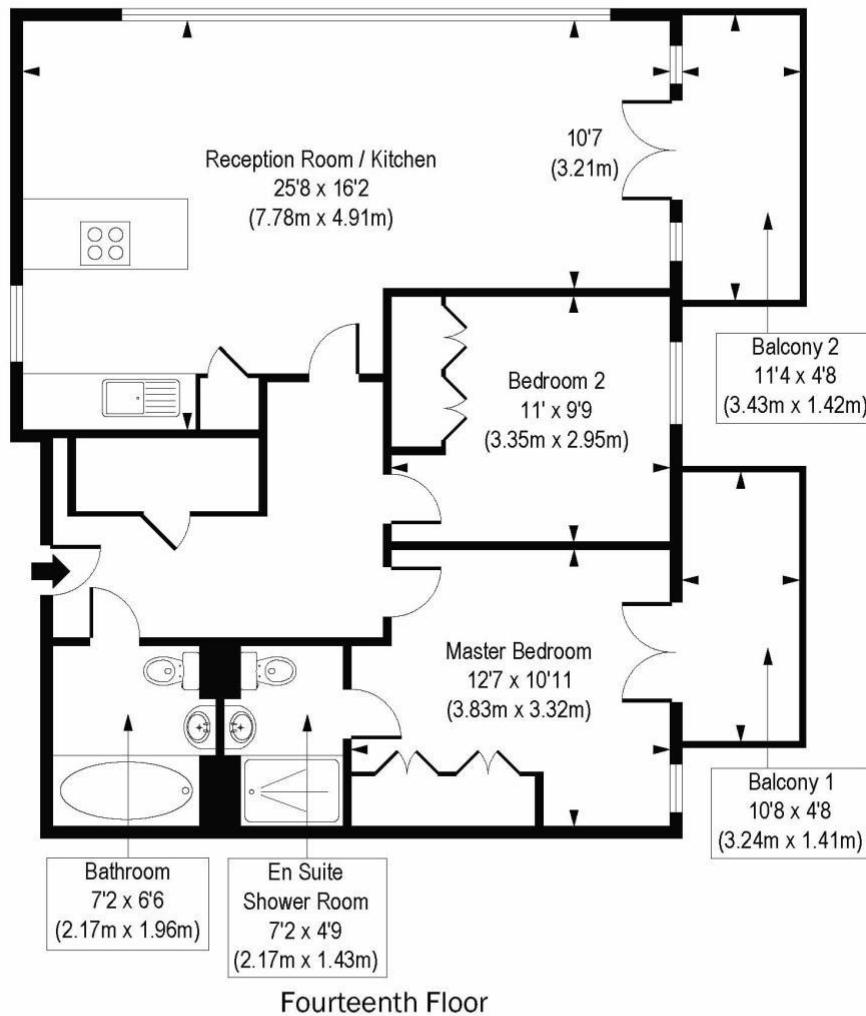

COMPLIANT WITH RICS CODE OF MEASURING PRACTICE Floorplan is for illustrative purposes only and is not to scale. Every attempt has been made to ensure the accuracy of the floorplan shown, however all measurements, fixtures, fittings and data shown are an approximate interpretation for illustrative purposes only. Liability for errors, omissions or mis-statement through negligence or otherwise is hereby excluded.

This floorplan is for illustration purposes only and is not to scale. The position and size of doors, windows, appliances and other features are approximate.

Shoreditch | 020 7749 7650 | [shoreditch@winkworth.co.uk](mailto:shoreditch@winkworth.co.uk)

**Winkworth**

[winkworth.co.uk](http://winkworth.co.uk)

See things differently

Winkworth wishes to inform prospective buyers and tenants that these particulars are a guide and act as information only. All our details are given in good faith and believed to be correct at the time of printing but they don't form part of an offer or contract. No Winkworth employee has authority to make or give any representation or warranty in relation to this property. All fixtures and fittings, whether fitted or not are deemed removable by the vendor unless stated otherwise and room sizes are measured between internal wall surfaces, including furnishings.