



LAWFORD COURT, ELSTREE, BOREHAMWOOD, WD6
£339,950 LEASEHOLD

A TWO DOUBLE BEDROOM TWO BATHROOM GROUND FLOOR APARTMENT WITH ALLOCATED PARKING

Borehamwood | 020 8953 8899 | borehamwood@winkworth.co.uk



DESCRIPTION:

Constructed approx. ten years ago by the highly regarded developers Fairview Homes is this two double bedroom, two bathroom (one ensuite) ground floor apartment

Situated on the sought after "Vantage" development the property, benefits from a balcony and allocated parking space.

Located within walking distance of both Borehamwood town centre and Thameslink station, with its quick and convenient service into central London, the apartment would be ideal for first time buyers, downsizers and investors alike.



Approximate Gross Internal Area = 62.9 sq m / 677 sq ft

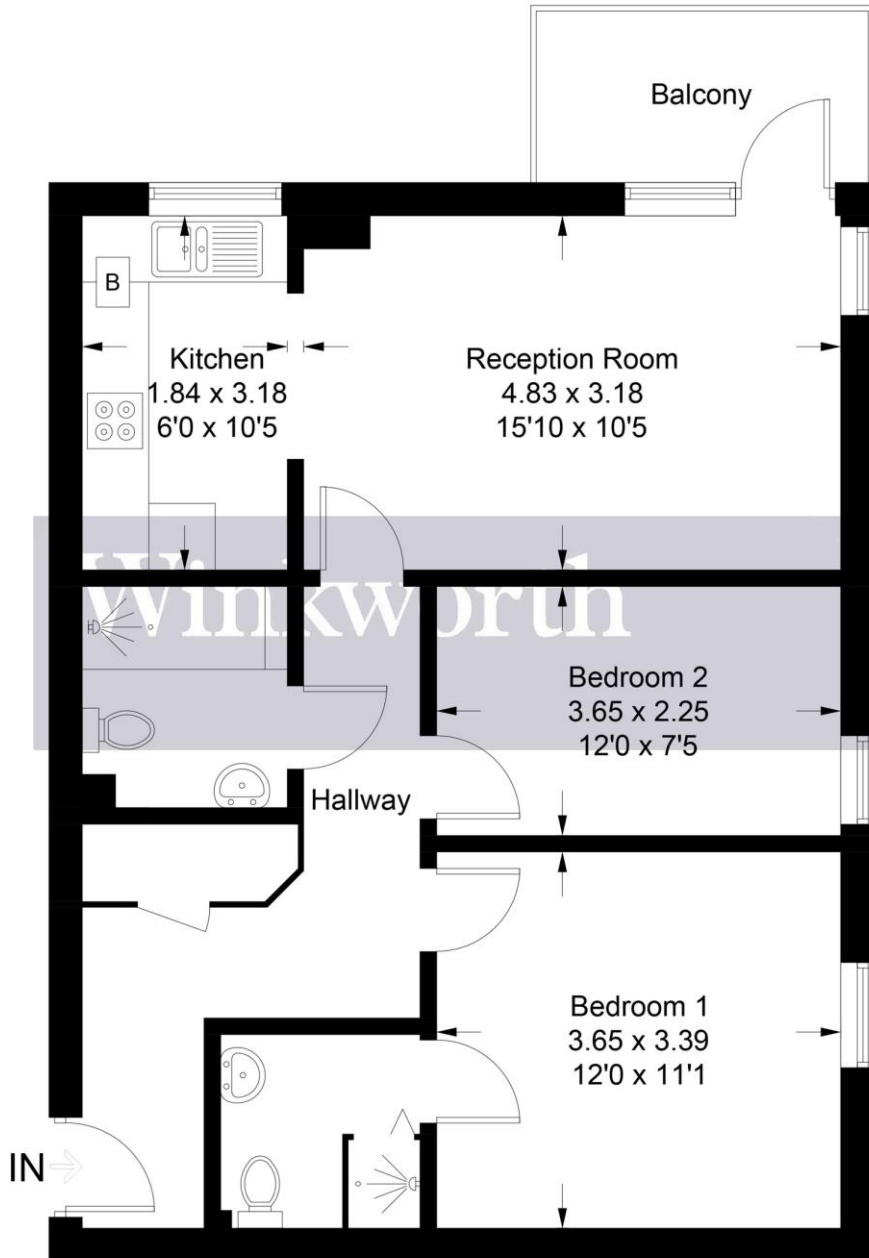
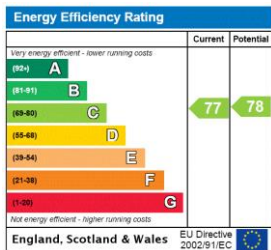

Illustration for identification purposes only, measurements are approximate, not to scale. Winkworth © 2023 (ID1016992)

This floorplan is for illustration purposes only and is not to scale. The position and size of doors, windows, appliances and other features are approximate.



- Tenure:** Leasehold
- Term:** Expires - 24/12/2137
- Service Charge:** £1453.86 per annum
- Ground Rent:** £ 298.76 Annually (subject to increase)
- Council Tax Band:** D

Where no figures are shown, we have been unable to ascertain the information. All figures that are shown were correct at the time of printing.