



BITTACY HILL, LONDON, NW7
£560,000 LEASEHOLD

TWO DOUBLE BEDROOM FIRST FLOOR PURPOSE BUILT APARTMENT

Finchley | 020 8349 3388 | finchley@winkworth.co.uk

Winkworth

for every step...

winkworth.co.uk



DESCRIPTION:

Offered for sale is this well presented, two double bedroom, first floor purpose built apartment - set within a popular modern development situated within a stone's throw away from Mill Hill East Tube Station and local shopping facilities. The property benefits from having en-suite to master bedroom, modern fitted kitchen, underfloor heating, private balcony, communal gardens, and secured underground parking.

An internal viewing is Highly recommended

AT A GLANCE

- Two Double Bedrooms
- En-Suite to Master Bedroom
- Private Balcony
- Underfloor Heating
- Underground Parking
- Modern Decor





Winkworth



Winkworth



Winkworth



Winkworth



Winkworth

Foxglove Apartments, Bittacy Hill, NW7
Approx. Gross Internal Floor Area 869 sq. ft / 77.67 sq. m

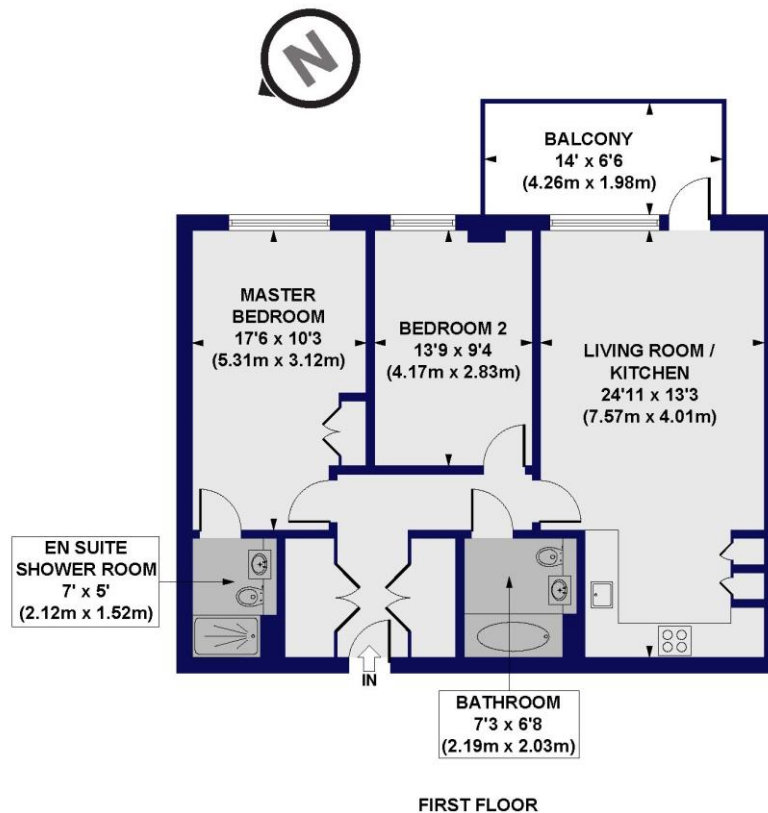

All measurements of walls, doors, windows, fittings and appliances, including their size and location, are shown as standard sizes and do not constitute any warranty or representation by the seller, their agent or CP Creative. Any intending purchaser must satisfy himself by inspection or otherwise as to the correctness of the information contained in these plans. This plan is for illustrative purposes only and should be used as such by any prospective purchasers.

Winkworth

This floorplan is for illustration purposes only and is not to scale. The position and size of doors, windows, appliances and other features are approximate.

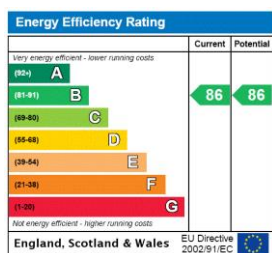

Tenure: Leasehold

Term: 992 years

Service Charge: £2777.75 PA

Ground Rent: £555 (subject to increase)

Where no figures are shown, we have been unable to ascertain the information. All figures that are shown were correct at the time of printing.

Winkworth

Finchley | 020 8349 3388 | finchley@winkworth.co.uk

for every step...

winkworth.co.uk

Winkworth wishes to inform prospective buyers and tenants that these particulars are a guide and act as information only. All our details are given in good faith and believed to be correct at the time of printing but they don't form part of an offer or contract. No Winkworth employee has authority to make or give any representation or warranty in relation to this property. All fixtures and fittings, whether fitted or not are deemed removable by the vendor unless stated otherwise and room sizes are measured between internal wall surfaces, including furnishings.