

FUSION COURT, SCLATER STREET, LONDON, E1
£575,000 LEASEHOLD

AN ASTOUNDING ONE BEDROOM ULTRA-MODERN APARTMENT IN THE HIGHLY DESIRABLE FUSION BUILDING

Shoreditch | 020 7749 7650 | shoreditch@winkworth.co.uk

Winkworth



DESCRIPTION:

A fantastic double bedroom apartment with private balcony available on the third floor of this modern development. The property comprises a wide entrance hall with large storage cupboard, master bedroom with built in wardrobe, family bathroom with white three-piece suite. Furthermore, there is an open plan kitchen/reception room with built in appliances including; fridge/freezer, washer dryer, dishwasher, electric hob/oven, microwave and beautiful worktops. The flat also benefits from west-facing private balcony which leads off from the living room.

The development features a large communal landscaped roof garden and bicycle storage. Other features of the property include underfloor heating in the bathroom, video entry phone system, Smeg kitchen appliances and luxurious finishing's throughout. Located just off Brick Lane this property is ideally placed with an array of boutique shops, cafes, pop ups, bars and restaurants on your doorstep. Bethnal Green Road, Commercial Street, Spitalfields Market and Columbia Road are also all within easy walking distance putting you right in the centre of everything Shoreditch. Shoreditch High Street station is a short walk away and Liverpool Street and Aldgate East are a short stroll away offering fantastic access across the City.

Winkworth



Winkworth

Fusion Court, Sclater Street, E1
 Approx. Gross Internal Floor Area 606 sq. ft / 56.26 sq. m

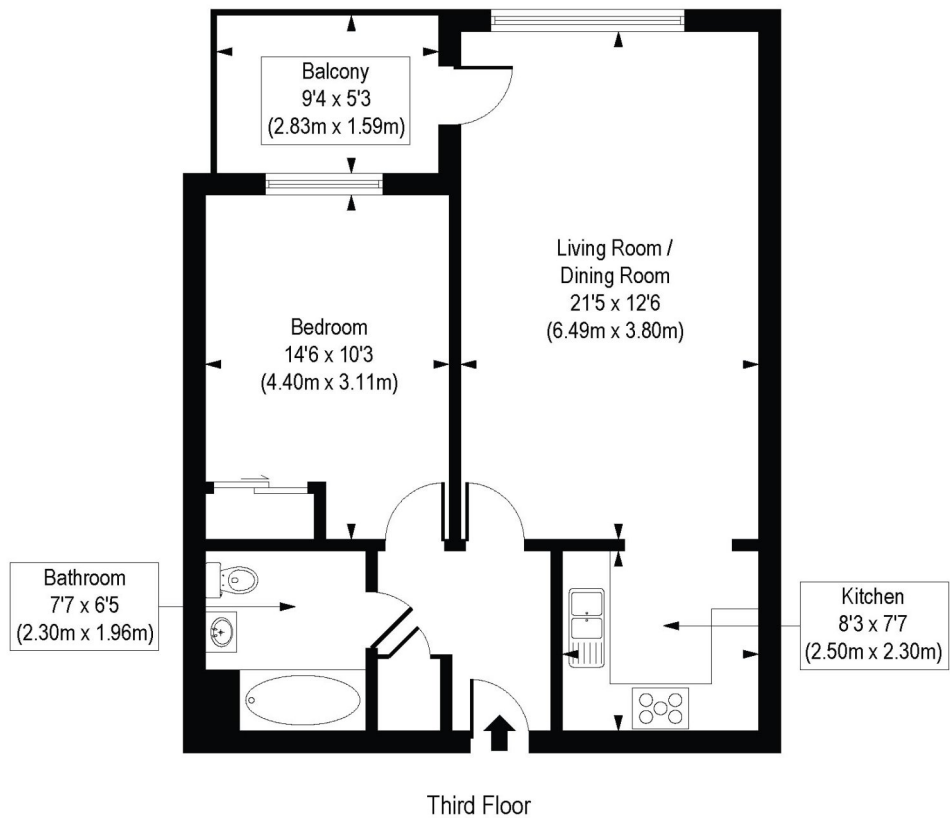
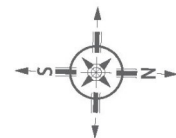

COMPLIANT WITH RICS CODE OF MEASURING PRACTICE. Floorplan is for illustrative purposes only and is not to scale. Every attempt has been made to ensure the accuracy of the floorplan shown, however all measurements, fixtures, fittings and data shown are an approximate interpretation for illustrative purposes only. Liability for errors, omissions or mis-statement through negligence or otherwise is hereby excluded.

This floorplan is for illustration purposes only and is not to scale. The position and size of doors, windows, appliances and other features are approximate.

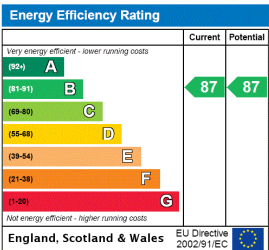

Shoreditch | 020 7749 7650 | shoreditch@winkworth.co.uk

winkworth.co.uk

See things differently

Winkworth wishes to inform prospective buyers and tenants that these particulars are a guide and act as information only. All our details are given in good faith and believed to be correct at the time of printing but they don't form part of an offer or contract. No Winkworth employee has authority to make or give any representation or warranty in relation to this property. All fixtures and fittings, whether fitted or not are deemed removable by the vendor unless stated otherwise and room sizes are measured between internal wall surfaces, including furnishings.