



**FOX LANE, N13**  
**£350,000 LEASEHOLD**

A stunning one bedroom flat set on the first floor of a newly converted grand Edwardian house, situated in a sought-after location on the borders of Palmers Green and Southgate. The property boasts light and airy living accommodation with high corniced ceilings, picture rails, sash windows and beautifully restored cast iron fireplaces. You will find a spacious 15'9x13'5 reception room, an attractive fitted kitchen with brand new appliances, a generously sized double bedroom and an attractive shower room. Offered for sale chain-free and with a new 125 year lease.

Palmers Green | 020 8920 9900 | palmersgreen@winkworth.co.uk



for every step...

**Fox Lane, N13**  
**Approx. Gross Internal Floor Area 470 sq. ft / 43.67 sq. m**

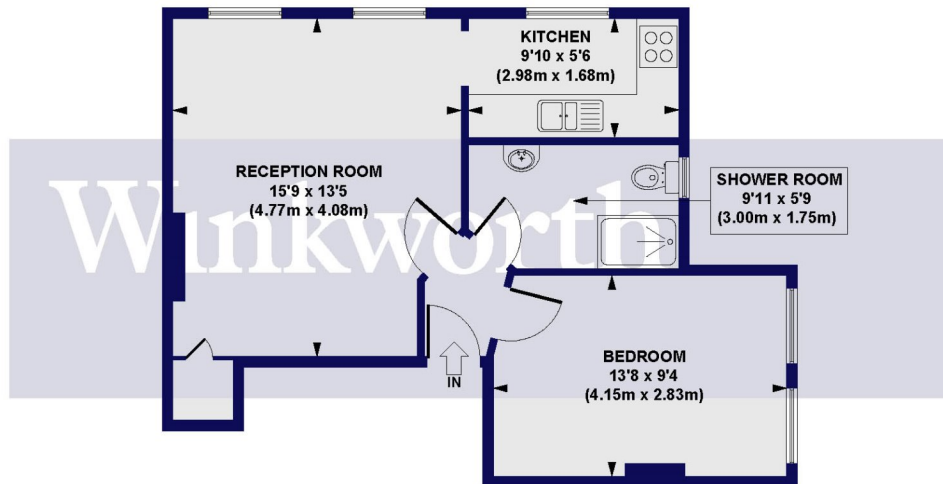

**FIRST FLOOR**

All measurements of walls, doors, windows, fittings and appliances, including their size and location, are shown as standard sizes and do not constitute any warranty or representation by the seller, their agent or CP Creative. Any intending purchaser must satisfy himself by inspection or otherwise as to the correctness of the information contained in these plans.

This floorplan is for illustration purposes only and is not to scale. The position and size of doors, windows, appliances and other features are approximate.

Palmers Green | 020 8920 9900 | [palmsgreen@winkworth.co.uk](mailto:palmsgreen@winkworth.co.uk)

**Winkworth**

for every step...

*winkworth.co.uk*

Winkworth wishes to inform prospective buyers and tenants that these particulars are a guide and act as information only. All our details are given in good faith and believed to be correct at the time of printing but they don't form part of an offer or contract. No Winkworth employee has authority to make or give any representation or warranty in relation to this property. All fixtures and fittings, whether fitted or not are deemed removable by the vendor unless stated otherwise and room sizes are measured between internal wall surfaces, including furnishings.