



KITCHENER ROAD, N17
£485,000 LEASEHOLD

DESCRIPTION:

Nestled on a peaceful one-way street in South Tottenham is this beautifully assembled, two-bedroom ground floor Victorian conversion with private garden.

Harringay | 020 8800 5151 | harringay@winkworth.co.uk

Winkworth

for every step...

winkworth.co.uk

Kitchener Road, N17
 Approx. Gross Internal Floor Area 607 sq. ft / 56.39 sq. m

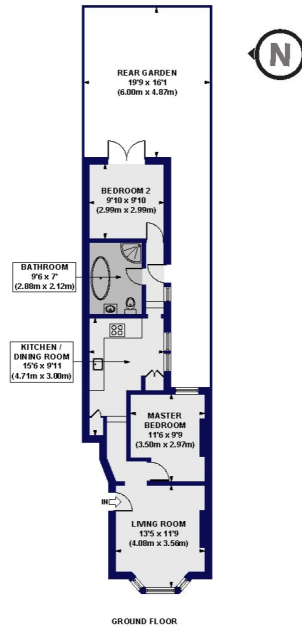

GROUND FLOOR

All measurements of walls, doors, windows, fittings and appliances, including the specification, are given in the floor plan and do not constitute any warranty or representation by the seller, their agent or EPC Provider. Any intended or future modifications to the property are shown as to the current status of the information contained in these plans. This plan is for illustration purposes only and should be used in conjunction with any prospective purchases.

Winkworth

This floorplan is for illustration purposes only and is not to scale. The position and size of doors, windows, appliances and other features are approximate.

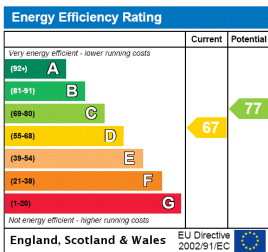

Harringay | 020 8800 5151 | harringay@winkworth.co.uk



for every step...

winkworth.co.uk

winkworth wishes to inform prospective buyers and tenants that these particulars are a guide and act as information only. All our details are given in good faith and believed to be correct at the time of printing but they don't form part of an offer or contract. No winkworth employee has authority to make or give any representation or warranty in relation to this property. All fixtures and fittings, whether fitted or not are deemed removable by the vendor unless stated otherwise and room sizes are measured between internal wall surfaces, including furnishings.