



**BRONDESBURY ROAD, NW6**  
**£2,750 PER MONTH UNFURNISHED**

**CHARMING PERIOD TERRACED GROUND FLOOR APARTMENT LOCATED MOMENTS FROM QUEENS PARK.**

**Kensal Rise & Queens Park | 0208 960 4947 |**  
**kensalrise@winkworth.co.uk**



**for every step...**

*winkworth.co.uk*



## **DESCRIPTION:**

Winkworth are delighted to offer this charming two-bedroom ground floor apartment set within a beautifully maintained period terraced building.

This delightful property boasts a bright and modern interior, making it a truly homely space. The apartment is well maintained, with wooden flooring throughout, many period features as well as built in storage in the living room. The kitchen is fully fitted with all modern appliances, a breakfast bar and through bi-folding doors, residents can enjoy the use of a lovely 61+ft. private garden with patio, adding to the property's appeal.

Situated in a desirable location, this apartment offers easy access to local amenities and transport links, making it an ideal choice for those seeking a peaceful yet convenient lifestyle.

Offered unfurnished\* and available 13/04/24

\*Please note that the kitchen stools will remain.



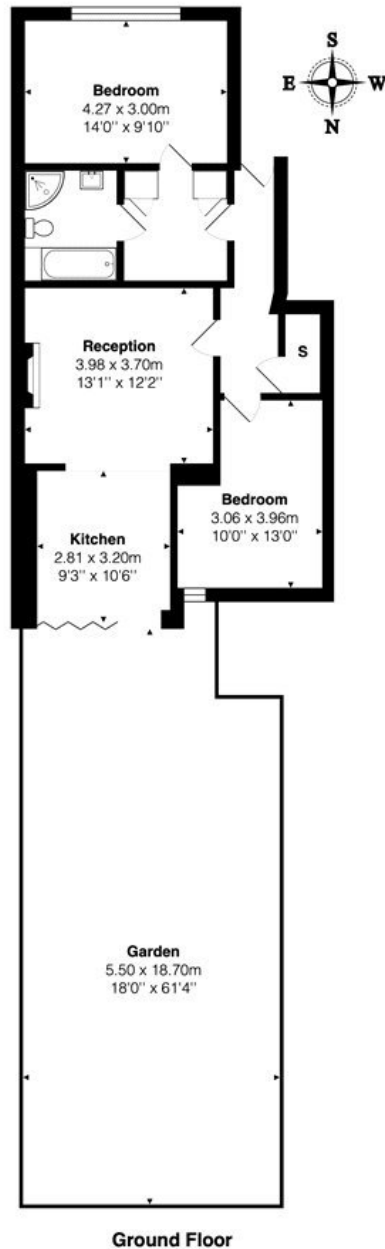

Total Area: 67.0 m<sup>2</sup> ... 721 ft<sup>2</sup> (excluding garden)  
All measurements are approximate and for display purposes only

This floorplan is for illustration purposes only and is not to scale. The position and size of doors, windows, appliances and other features are approximate.

Energy Efficiency Rating		Current	Potential
Very energy efficient - lower running costs			
(92-100)	A		
(81-91)	B		
(69-80)	C	69	76
(55-68)	D		
(39-54)	E		
(21-38)	F		
(1-20)	G		
Not energy efficient - higher running costs			
England, Scotland & Wales		EU Directive 2002/91/EC	

**Deposit:** £3,173.08

**Council Tax Band:** C

where no figures are shown, we have been unable to ascertain the information. All figures that are shown were correct at the time of printing.



Kensal Rise & Queens Park | 0208 960 4947 | kensalrise@winkworth.co.uk

for every step...

winkworth.co.uk

Winkworth wishes to inform prospective buyers and tenants that these particulars are a guide and act as information only. All our details are given in good faith and believed to be correct at the time of printing but they don't form part of an offer or contract. No Winkworth employee has authority to make or give any representation or warranty in relation to this property. All fixtures and fittings, whether fitted or not are deemed removable by the vendor unless stated otherwise and room sizes are measured between internal wall surfaces, including furnishings.