

# ELDEN HOUSE | SW3



Winkworth

# Elden House SW3

RENT: £500.00pw / £2,000.00pcm

- One Bedroom
- One Bathroom
- Terraced upper floor flat (with lift)
- Furnished
- Resident Parking

LOCAL AUTHORITY: Royal Borough of Kensington & Chelsea

COUNCIL TAX BAND: Band E

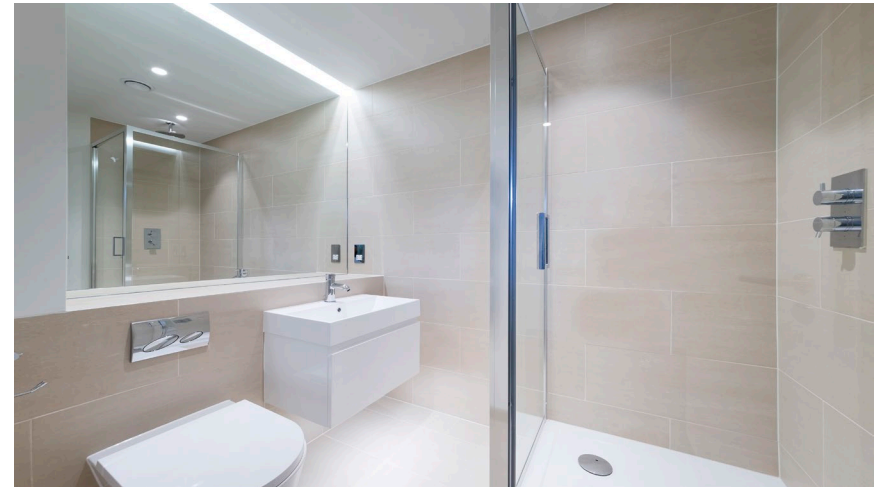

Energy Efficiency Rating		
	Current	Potential
Very energy efficient - lower running costs		
(92+) <b>A</b>		
(81-91) <b>B</b>		<b>84</b>
(69-80) <b>C</b>		
(55-68) <b>D</b>	<b>64</b>	
(39-54) <b>E</b>		
(21-38) <b>F</b>		
(1-20) <b>G</b>		
Not energy efficient - higher running costs		
<b>England, Scotland &amp; Wales</b>	EU Directive 2002/91/EC	

Knightsbridge & Chelsea | 020 7589 6616  
knightsbridge@winkworth.co.uk



for every step...

[winkworth.co.uk](http://winkworth.co.uk)

Winkworth wishes to inform prospective buyers and tenants that these particulars are a guide and act as information only. All our details are given in good faith and believed to be correct at the time of printing but they don't form part of an offer or contract. No Winkworth employee has authority to make or give any representation or warranty in relation to this property. All fixtures and fittings, whether fitted or not are deemed removable by the vendor unless stated otherwise and room sizes are measured between internal wall surfaces, including furnishings.

Elden House  
Fulham Road, SW3

Approximate Gross Internal Area  
35.12 sq m / 378 sq ft

( CH = Ceiling Heights )

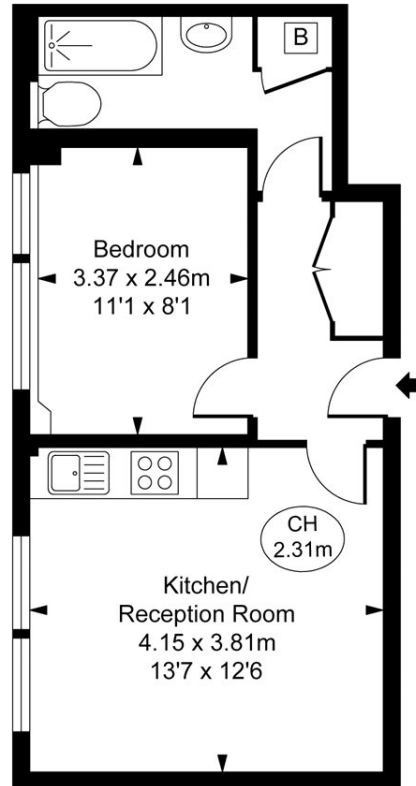

Third Floor