



54 WATERSIDE, QUAYSIDE, EXETER, EX2 8GX

Winkworth



This two bedroom apartment is located in the popular historic Quay side with views over the River Exe. Close to the shops, restaurants and easy access to the city centre. This property is offered with no onward chain and would make a super first home, investment opportunity or if you wish to have a second home in a fantastic location.

At a glance...

- Two Double Bedroom Apartment
- Main Bedroom With Balcony
- Living/Dining Room with Balcony
- Kitchen With Built-in Appliances
- Family Bathroom
- Well Maintained Communal Grounds
- Residence Allocated Parking
- Good Condition Throughout
- Quay Side Location
- Electric, Water & Mains Drainage
- Council Tax Band C
- Exeter City Council
- Lease: 93 Years
- No Ground Rent
- Service Charge £2023.88 per annum

01392 271177 | exeter@winkworth.co.uk

The development is located on the historic Quay side in Exeter set in well maintained communal grounds. A range of some great shops, restaurants and leisure facilities are all offered on the Quay. The city centre is within walking distance.

The Property:

The apartment is located on the upper floor of the building with views over the river and Quay side to the front and communal grounds to the rear. The property offers two double bedrooms, the main bedroom has access to a balcony, fitted kitchen with some built in appliances, living/dining room with access to a balcony with views over the river and Quay side. Family bathroom.

Outside:

Situated on the Quay side and easy access to the city centre. The communal grounds are well maintained with allocated residence parking bays, mature shrubs and bushes and well lit walkways.

Location:

Exeter offers an extensive range of facilities including, excellent city centre shopping, lovely cathedral with stunning grounds, excellent range of restaurants, coffee shops and bars. Exeter also offers extensive sporting and leisure facilities and home to the Exeter Chiefs rugby club. Access to both of Devon's national parks and two coast lines are within a short distance.

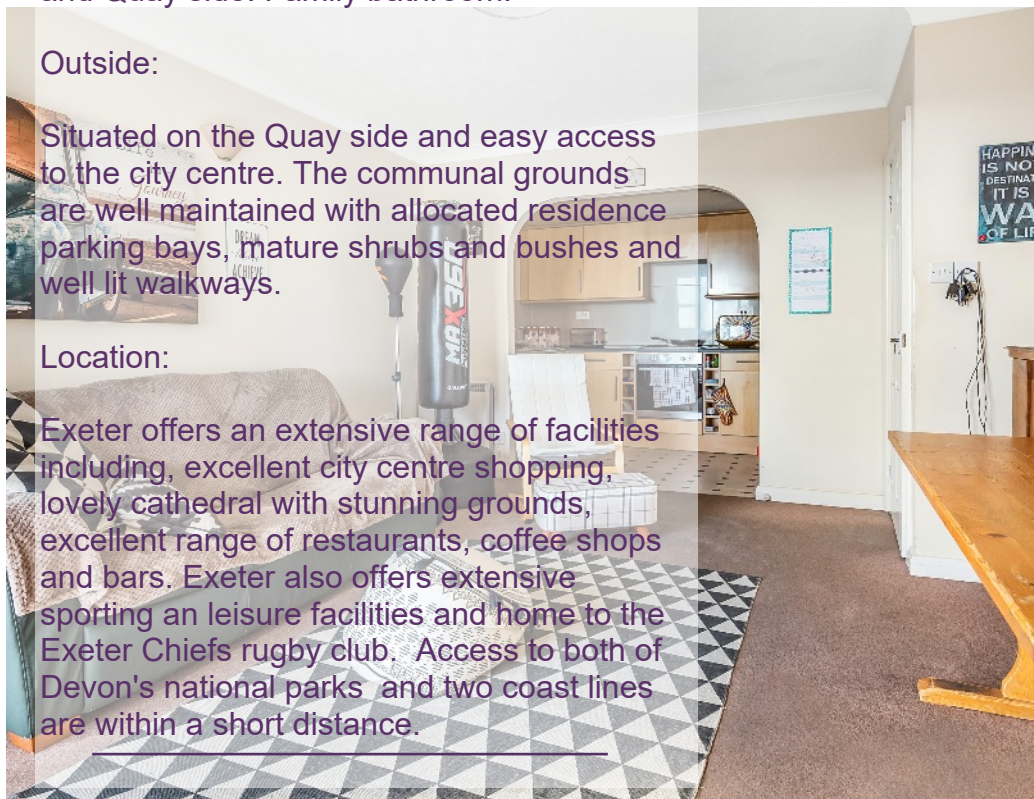

Waterside, Exeter, EX2

Approximate Area = 695 sq ft / 64.6 sq m

For identification only - Not to scale

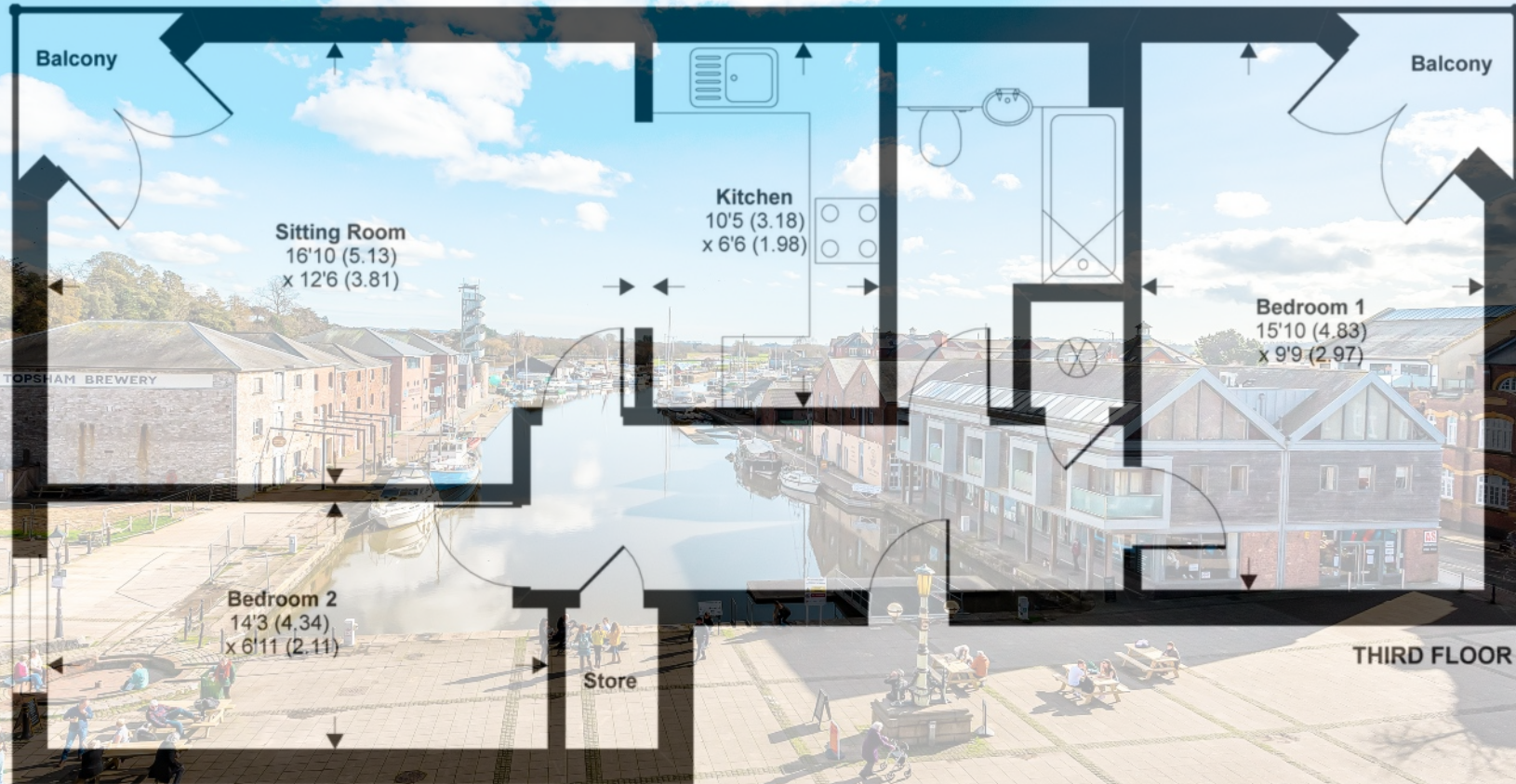

Exeter office

25 Southernhay East, Exeter, EX1 1QP
01392 271177 exeter@winkworth.co.uk

winkworth.co.uk/exeter

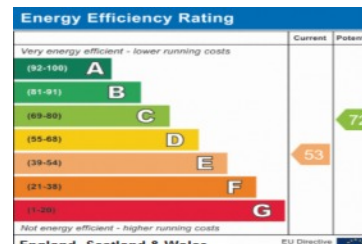

Winkworth

See things differently.

