

FLAT 1, BROMLEY ROAD, BECKENHAM, BR3
£2,000 PER MONTH

TWO BEDROOM GROUND FLOOR APARTMENT, OFF STREET PARKING, CHAIN FREE

Beckenham | 0208 650 1000 | beckenham@winkworth.co.uk

Tenant Fees Apply: Details of fees for tenant referencing, tenancy agreement admin fees and renewal fees are available on the Winkworth website and the link can be found with the displayed rent for the property. Tenants should ensure they are fully conversant with these upfront fees and other costs that are involved at the outset of the tenancy before making an offer to rent and your local Winkworth office will provide written details upon request.



DESCRIPTION:

Two bedroom ground floor apartment with own entrance and off road parking, is offered with no forward chain.

Benefits include and delightful veranda and patio area from the lounge via french doors, bright a spacious lounge and a share of the freehold.





BROMLEY ROAD

APPROXIMATE GROSS INTERNAL FLOOR AREA: 766 SQ FT - 71.13 SQ M

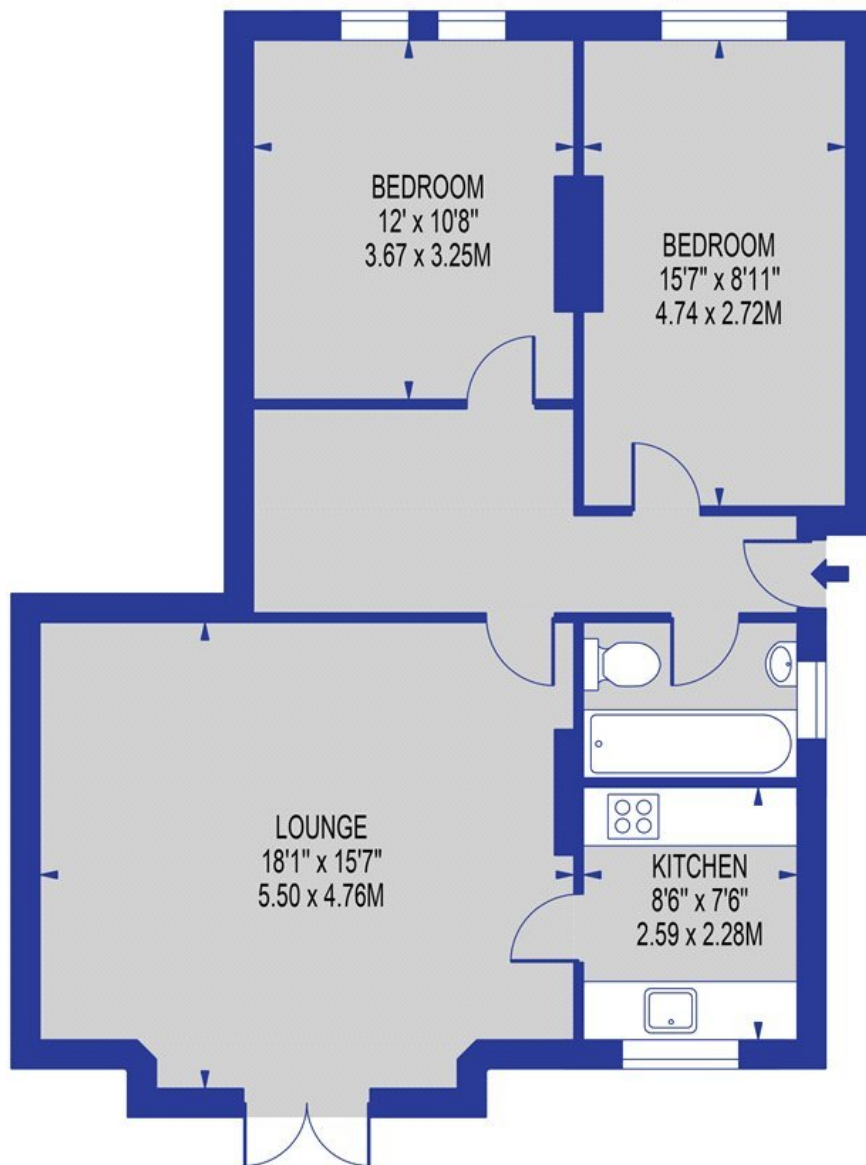

THIS FLOOR PLAN SHOULD BE USED AS A GENERAL OUTLINE FOR GUIDANCE ONLY AND DOES NOT CONSTITUTE IN WHOLE OR IN PART AN OFFER OR CONTRACT. ANY INTENDING PURCHASER OR LESSEE SHOULD SATISFY THEMSELVES BY INSPECTION, SEARCHES, ENQUIRIES AND FULL SURVEY AS TO THE CORRECTNESS OF EACH STATEMENT. ANY AREAS, MEASUREMENTS OR DISTANCES QUOTED ARE APPROXIMATE AND SHOULD NOT BE USED TO VALUE A PROPERTY OR BE THE BASIS OF ANY SALE OR LET.

This floorplan is for illustration purposes only and is not to scale. The position and size of doors, windows, appliances and other features are approximate.

Score	Energy rating	Current	Potential
92+	A		
81-91	B		
69-80	C	69 C	76 C
55-68	D		
39-54	E		
21-38	F		
1-20	G		

Deposit: £0.00

Holding Deposit:

Council Tax Band: B

Where no figures are shown, we have been unable to ascertain the information. All figures that are shown were correct at the time of printing.