

FAIRFIELDS CRESCENT, KINGSBURY, LONDON, NW9  
**£625,000 FREEHOLD**

## SEMI-DETACHED THREE BEDROOM DEVELOPMENT PROJECT

Kingsbury | 020 8204 0000 | [kingsbury@winkworth.co.uk](mailto:kingsbury@winkworth.co.uk)

**Winkworth**

[winkworth.co.uk](http://winkworth.co.uk)

See things differently





**DESCRIPTION:** Winkworth are pleased to present as sole agents this three bedroom semi-detached house located in the ever loved peaceful residence of Fairfields Crescent. This stunning hilltop location offers breath-taking panoramic views of London, but lies unsecluded only 1 mile from Kingsbury Station, and all of the local shops, eateries and amenities Kingsbury has on offer. Local reputable primary and secondary schools, places of worship, beautiful, scenic Roe Green Park and Fryent Country Park are also within close proximity. Offered chain free, this is an outstanding blank canvas for someone in search of a development project, with huge scope to extend both to the rear, and to a large extent to the side. With this amount of external space, the development options are endless (STPP). Internally, there are 2 warm and inviting reception rooms, a lovely kitchen boasting lots of natural light, three homely bedrooms and a family bathroom. The rear garden boasts a great amount of living space as well as a convenient garage. To the front externally, there is off street parking for one car. If you are on the hunt for your forever family home, then this is the perfect property for you. Contact us today to arrange a viewing.



**Winkworth**





Winkworth

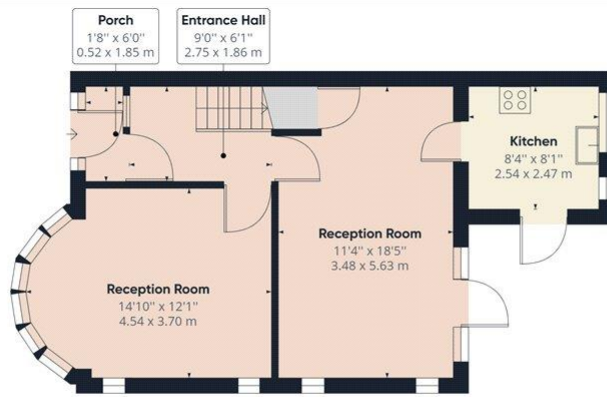

Ground Floor Building 1

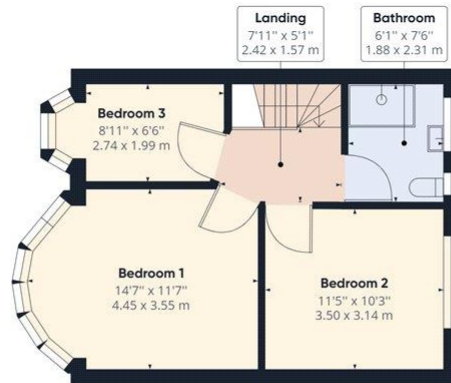

Floor 1 Building 1

Approximate total area<sup>(1)</sup>

955.52 ft<sup>2</sup>  
88.77 m<sup>2</sup>

(1) Excluding balconies and terraces

While every attempt has been made to ensure accuracy, all measurements are approximate, not to scale. This floor plan is for illustrative purposes only.

GIRAFFE360

This floorplan is for illustration purposes only and is not to scale. The position and size of doors, windows, appliances and other features are approximate.

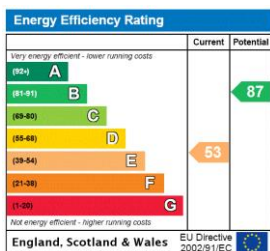

Kingsbury | 020 8204 0000 | kingsbury@winkworth.co.uk

Winkworth

winkworth.co.uk

See things differently

Winkworth wishes to inform prospective buyers and tenants that these particulars are a guide and act as information only. All our details are given in good faith and believed to be correct at the time of printing but they don't form part of an offer or contract. No Winkworth employee has authority to make or give any representation or warranty in relation to this property. All fixtures and fittings, whether fitted or not are deemed removable by the vendor unless stated otherwise and room sizes are measured between internal wall surfaces, including furnishings.