



## Digby Mansions, Hammersmith Bridge Road, W6

£325,000 Leasehold

An unmodernised one bedroom flat on the ground floor of this sought after mansion block, moments from the River.

Reception Room | Kitchen | Bedroom | Bathroom | Cloakroom | 469 Sq Ft / 44 Sq M | Council Tax Band D  
| EPC Rating Band D

**Winkworth**





### LOCATION

Digby Mansions benefits from an enviable position next to both the River Thames and Hammersmith Bridge. The property is ideally located for access to the numerous transport links around Hammersmith, where four Underground lines are on offer, whilst an excellent range of pubs, restaurants and shops are also close to hand.

### DESCRIPTION

The property is in need of total refurbishment, with accommodation comprising entrance hall, bedroom, bathroom, kitchen and reception room.

Lease:- 125 years from 24 June 1991

Service Charge:- tbc

Ground Rent:- tbc







**LOCAL AUTHORITY**  
Hammersmith & Fulham

**TENURE**  
Leasehold 90 years 10 months.

**PRICE:** £325,000 Leasehold



Score	Energy rating	Current	Potential
92+	A		
81-91	B		
69-80	C		77 C
55-68	D	67 D	
39-54	E		
21-38	F		
1-20	G		

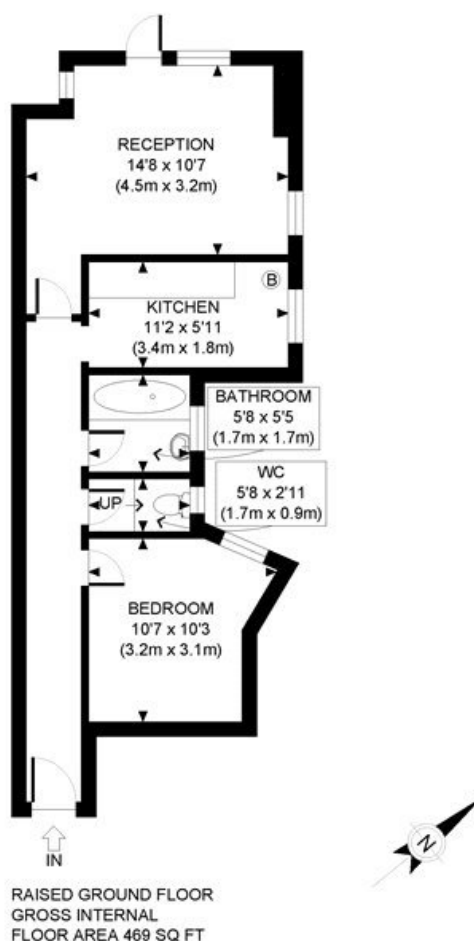

APPROX. GROSS INTERNAL FLOOR AREA: 469 SQ FT/ 44 SQM

**Winkworth**

DIGBY MANSIONS, W6

This plan is for illustrative purposes only and should be used as such by any prospective client. Whilst every attempt has been made to ensure the accuracy of the Floor Plan contained here, measurements of the doors, windows, rooms and any other items are approximate and no responsibility is taken for any errors, omissions, or misstatement. The services, systems and appliances shown have not been tested and no guarantee as to the operability or efficiency can be given.

**PROPERTY PHOTO PLANS**  
END STOP COPY FOR PROPERTY PHOTO PLANS

The displayed square footage is taken from the floor plans with measurements created using the Royal Institute of Chartered Surveyors' Code of Practice for Measuring. These measurements are approximate and included for illustrative purposes only. Winkworth does not make any representation as to the accuracy of these measurements and you should seek to verify them for yourself. Winkworth accept no liability for any loss you may suffer if you rely on these measurements.

Hammersmith | 0207 371 4466 | hammersmith@winkworth.co.uk

**Winkworth**

**for every step...**

Under the Property Misdescriptions Act 1991, these Particulars are a guide and act as information only. All details are given in good faith and are believed to be correct at time of printing. Winkworth give no representation as to their accuracy and potential purchasers or tenants must satisfy themselves by inspection or otherwise as to their correctness. No employee of Winkworth has authority to make or give any representation or warranty in relation to this property.