



Lightsfield Oakley, Basingstoke RG23 7BL

Description

A three bedroom unfurnished semi detached house situated in the popular village of Oakley. The accommodation comprises a modern fitted kitchen and bathroom, with a good size rear garden and there is also a garage for storage in a nearby block. A delightful property offering plenty of space and within walking distance to local amenities and Oakley primary school.

Upon entering the property from the entrance porch you have a hallway which the downstairs accommodation leads off from. To the front there is a downstairs cloakroom followed by the living room to the front and a modern Kitchen/dining room across the back. There are patio doors leading out to a generous size rear garden with a patio and storage shed.

Upstairs there are two double bedrooms and one single bedroom plus a family bathroom with a rainfall shower. There is a garage in a nearby block and parking on the road to the front.



Winkworth

Accommodation

Semi detached house
 Three bedrooms
 Living room
 Kitchen/dining room
 Downstairs cloakroom
 Bathroom
 Garden
 Garage

Under the Property Misdescriptions Act 1991, these Particulars are a guide and act as information only. All details are given in good faith and are believed to be correct at time of printing. Winkworth give no representation as to their accuracy and potential purchasers or tenants must satisfy themselves by inspection or otherwise as to their correctness. No employee of Winkworth has authority to make or give any representation or warranty in relation to this property.

Energy Efficiency Rating		Current	Potential
Very energy efficient - lower running costs			
(92-100) A			
(81-91) B			87
(69-80) C		75	
(55-68) D			
(39-54) E			
(21-38) F			
(1-20) G			
Not energy efficient - higher running costs			
England, Scotland & Wales		EU Directive 2002/91/EC	

GROUND FLOOR
 413 sq.ft. (38.4 sq.m.) approx.

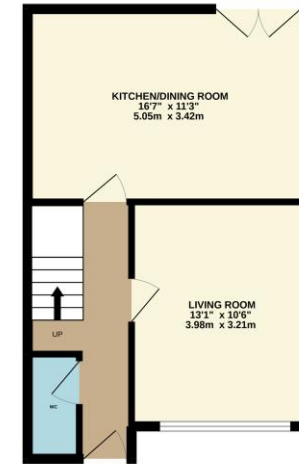

1ST FLOOR
 402 sq.ft. (37.3 sq.m.) approx.

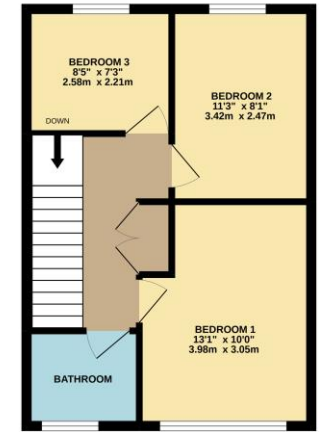

TOTAL FLOOR AREA: 815 sq.ft. (75.7 sq.m.) approx.
 Whilst every attempt has been made to ensure the accuracy of the floorplan contained here, measurements of doors, windows, rooms and any other items are approximate and no responsibility is taken for any errors, omissions or mis-statements. This plan is for illustrative purposes only and should be used as such by any prospective purchaser. The services, fixtures and appliances shown have not been tested and no guarantee as to their operability or efficiency can be given.
 Made with Neopico 02022



Basingstoke Office

10B Church Street, Basingstoke, Hampshire, RG21 7QE
 01256 811730 | basingstoke@winkworth.co.uk
winkworth.co.uk/Basingstoke



See things differently.