



**GREENSIDE, HERTFORDSHIRE, WD6**  
**£450,000 FREEHOLD**

# A THREE BEDROOM, TWO RECEPTION FAMILY HOUSE

Borehamwood | 020 8953 8899 | borehamwood@winkworth.co.uk



### DESCRIPTION:

Discreetly positioned in a quiet turning just off Aycliffe Road is this three bedroom, two reception terraced family house.

Immaculately presented throughout the property offers in excess of 1000 square feet of well-proportioned accommodation which is complimented by a secluded rear garden and off street parking to front.

Located close to several "Good" Ofsted rated schools including Woodlands and Cowley Hill Primary schools and within easy of local shops and bus routes the property makes an ideal family home.

### AT A GLANCE

- 3 Bedrooms
- Quiet Turning
- 1048 Square Feet
- Two Receptions
- Guest Cloakroom
- Off Street Parking
- Garage





Winkworth



Winkworth

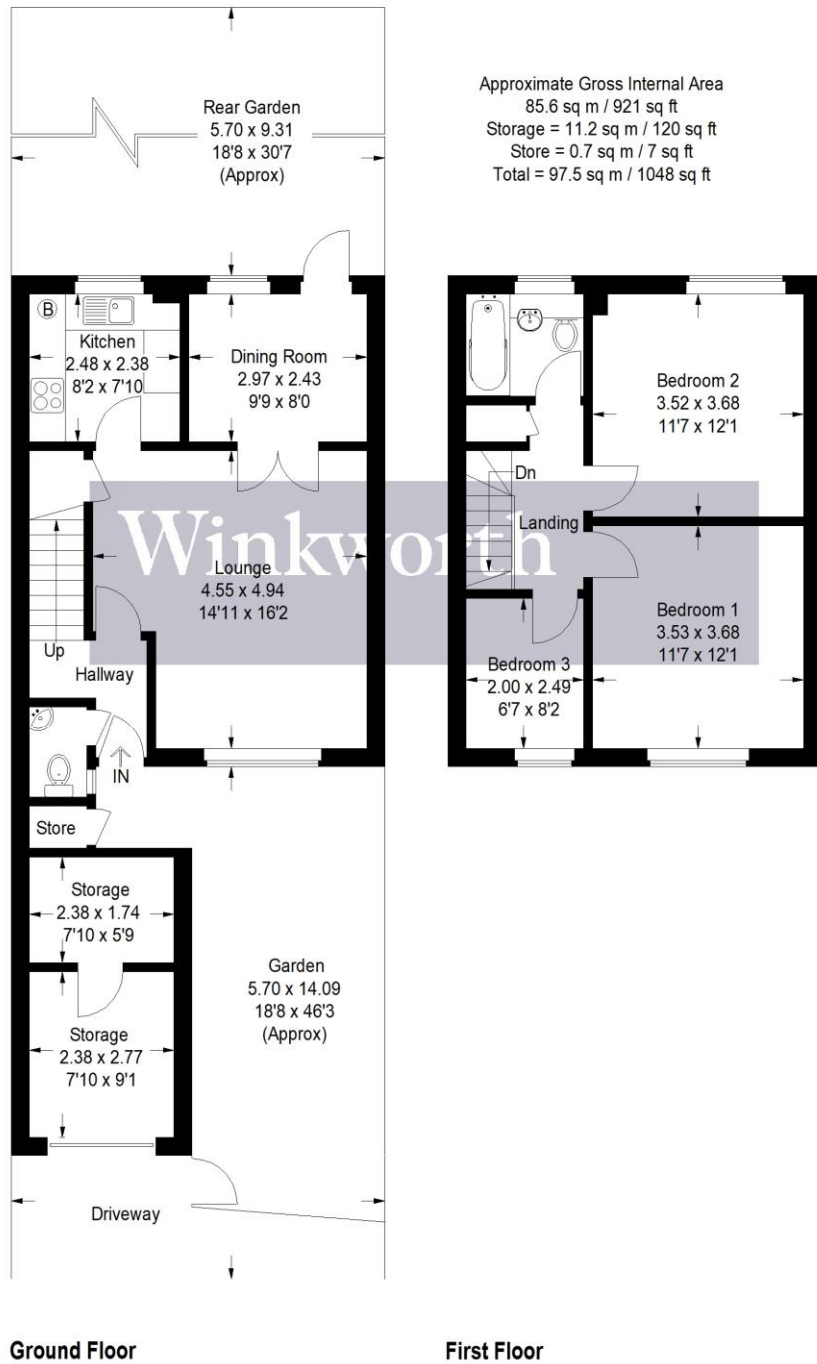

Illustration for identification purposes only, measurements are approximate, not to scale. Winkworth © 2020 (ID 670640)

This floorplan is for illustration purposes only and is not to scale. The position and size of doors, windows, appliances and other features are approximate.

