



47 GREENHAM MILL

NEWBURY RG14 5QW

A modern first floor apartment with balcony.

Situated overlooking the mill stream and a level walk from the town centre. The apartment has security entry system, double bedroom, bathroom, sitting room leading to a balcony and kitchen.

There is one parking space.

This property is let on an AST until Feb 2023 at a rent of £750pcm, giving a 7.2 % gross yield.

AGENTS NOTE:

This property does not have an EWS1 Risk assessment Form, as such prospective buyers are advised to check with their lender as to its suitability for lending.

LEASEHOLD DETAILS

Remaining lease Approx 120 years.

Ground rent £50 per annum.

Service charge £1584 per annum

Block Manager, One Housing Group

A PDF of the lease is available on request.

Energy Rating: C



Winkworth

AT A GLANCE

452 Square feet/ 42 square meters

Double bedroom

Sitting room

Kitchen

Bathroom

Balcony

Parking

UTILITIES

Mains water, electricity and drainage. Electric heating.

Council Tax band B, West Berkshire Council.

EPC Rating C

LEASEHOLD DETAILS

Remaining lease approx 120 years.

Ground rent £50 per annum.

Service charge £1584 per annum

Block Manager, One Housing Group

A PDF of the lease is available on request.

SITUATION

The apartment is situated in Greenham Mill, an island in the River Kennet and is a level walk from the town centre.

DIRECTIONS

Postcode for sat nav RG14 5QW, after turning into Greenham Mill, turn right and block is on the left.

Flat 47 Greenham Mill, Mill Lane, Newbury, RG14 5QW

Approximate Gross Internal Area
42 sq m / 452 sq ft

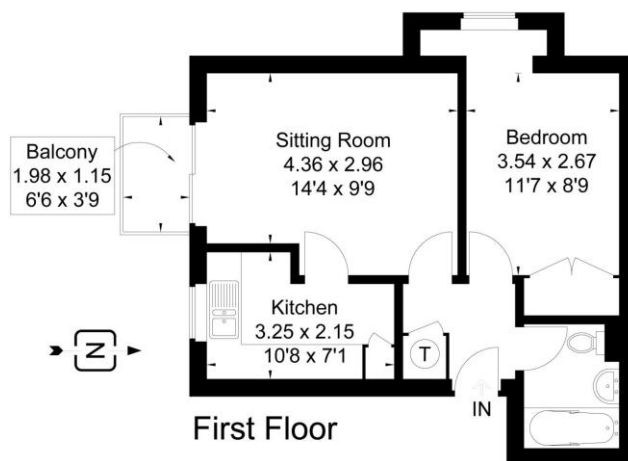

Newbury Office

43 Northbrook Street, Newbury, Berkshire RG14 1DT

01635 552552 | newbury@winkworth.co.uk

winkworth.co.uk/newbury

Winkworth

See things differently.