



FITZWALTERS MEADOW, CANTERBURY, CT3
£315,000 FREEHOLD

Canterbury | 01227 456 645 | canterbury@winkworth.co.uk

Winkworth

for every step...

winkworth.co.uk



DESCRIPTION:

This well-presented property was built by Hillreed Homes. This small and quiet development, which has a lovely community feel to it, is on the edge of the desirable village of Goodnestone.

This charming property has a feeling of spaciousness as you walk into the hallway with cupboard and downstairs cloakroom.

There is a lovely sitting room with a log burner, and double aspect windows through which the sun streams.

The Kitchen/diner is well equipped and spacious with modern units and white goods.

There is enough space for table and chairs and double doors open onto the garden.

Upstairs there are two double bedrooms, both with built in cupboards. The main room has the benefit of an en-suite shower room. The main bathroom is modern in design.

The property is currently tenanted and they are aware the property is being sold. The tenants have lived here for a number of years and, given the choice, would happily continue to stay long term. The property would therefore be a great buy for investment as well. Equally it would be a perfect home for a first time buyer or someone downsizing

Outside is a small, enclosed garden and a traditionally built car port, with enough space for two cars, one under cover.

The village of Goodnestone is a popular village away from the hustle and bustle of the main Cities, but Canterbury is only 7 miles away, and Sandwich a mere 5 miles. The village itself has a 12th Century Church, public house and the delightful Goodnestone Park Gardens which have been tended for generations by the Fitzwalter family.

There are mainline stations within a couple of miles, at Adisham, Aylesham or Snowdown and the A2 is only a short drive away.



ACCOMMODATION

2 Bedrooms
Semi Detached House
Garden
Off Street Parking
Desirable Village Location

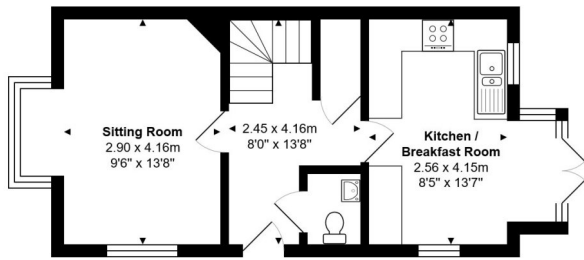

Ground Floor

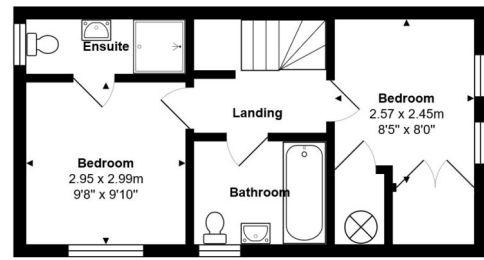

First Floor

Measurements of doors, windows and rooms and any other item are approximate and no responsibility is taken for any error, omission or mis-statement
This plan is for illustrative purpose only .

This floorplan is for illustration purposes only and is not to scale. The position and size of doors, windows, appliances and other features are approximate.

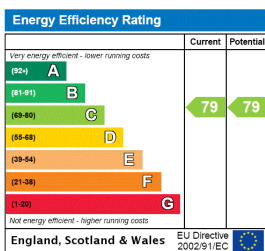

Canterbury | 01227 456 645 | canterbury@winkworth.co.uk



for every step...

winkworth.co.uk

Winkworth wishes to inform prospective buyers and tenants that these particulars are a guide and act as information only. All our details are given in good faith and believed to be correct at the time of printing but they don't form part of an offer or contract. No Winkworth employee has authority to make or give any representation or warranty in relation to this property. All fixtures and fittings, whether fitted or not are deemed removable by the vendor unless stated otherwise and room sizes are measured between internal wall surfaces, including furnishings.