



Amethyst Lane, Berkshire, RG30

£1,350 per month



This well presented two bedroom ground floor flat is located just off the Liebenwood Road within walking distance to Prospect Park. The property benefits from two double bedrooms, living room, kitchen, bathroom, residents parking and communal grounds. Offered unfurnished and available NOW this property would be ideal for a small family or professional couple.

KEY FEATURES

- Ground Floor
- Two Bedroom Apartment
- Unfurnished
- Close To Prospect Park
- Good Transport Links
- Rent: £1350 pcm



Reading

0118 4022 300 | reading@winkworth.co.uk





MATERIAL INFO

Deposit: £1,557.69

Holding Deposit: £311.53

Council Tax Band: C

Approximate total area⁽¹⁾
542 ft²
50.4 m²

(1) Excluding balconies and terraces

Calculations reference the RICS IPMS 3C standard. Measurements are approximate and not to scale. This floor plan is intended for illustration only.

GIRAFFE360

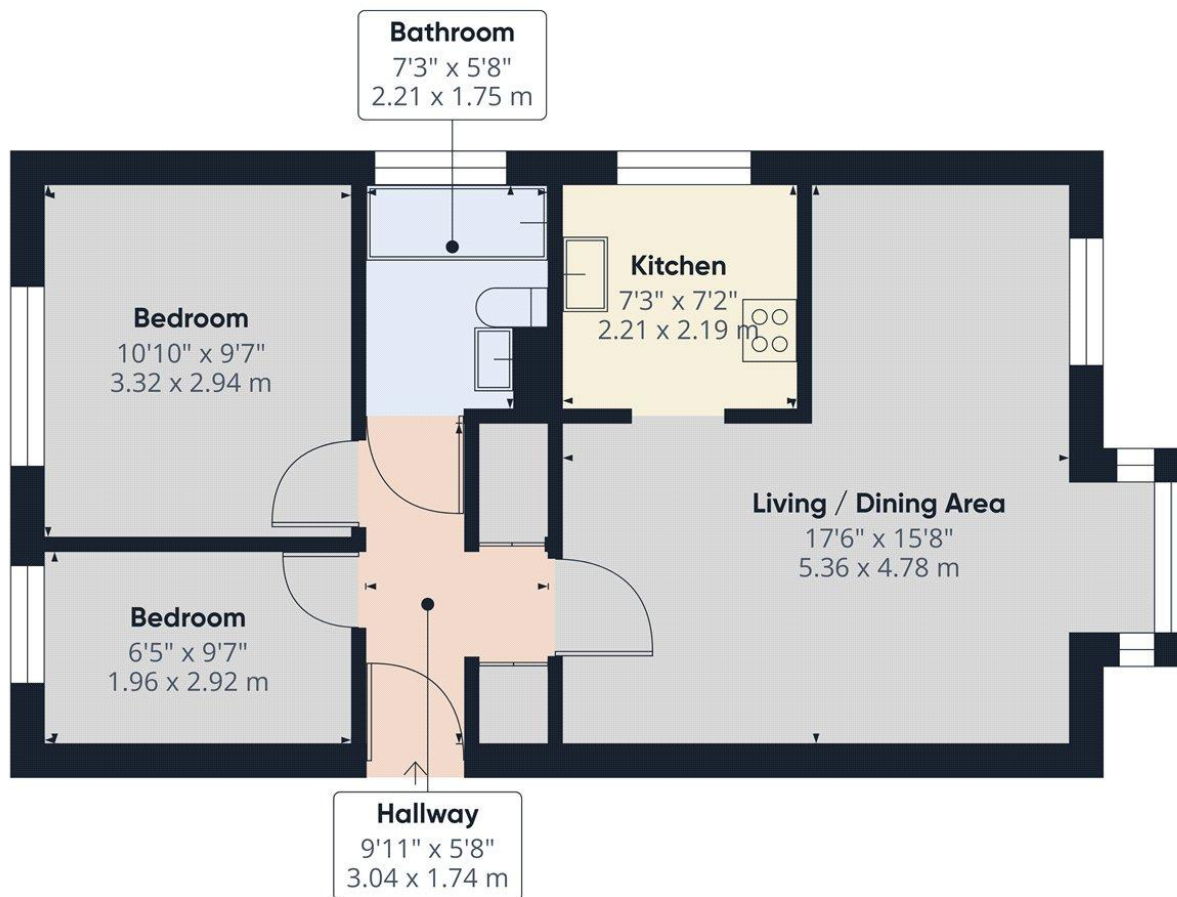

Score	Energy rating	Current	Potential
92+	A		
81-91	B		
69-80	C		75 C
55-68	D	56 D	
39-54	E		
21-38	F		
1-20	G		

For more information, scan the QR code or visit the link below

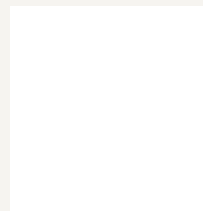

<https://www.winkworth.co.uk/rent/property/REA250917>

Where no figures are shown, we have been unable to ascertain the information. All figures that are shown were correct at the time of printing.

Reading

0118 4022 300 | reading@winkworth.co.uk