



MYDDELTON SQUARE, EC1R  
**£595,000 SHARE OF FREEHOLD**

**Winkworth**



## MYDDELTON SQUARE, EC1R

**A spacious one bedroom, top (third) floor apartment in a Grade II Listed, Georgian terrace on Myddelton Square.**

The property comprises large open plan reception with modern fitted kitchen, large bathroom (with separate bath and shower cubicle) and a double bedroom. The property also benefits from an abundance of natural light, carpet and south facing views over the church square.

Myddelton Square is a Georgian garden square exceptionally located in Clerkenwell close to the amenities of Amwell street and Upper street, the apartment is also conveniently located close to Angel Station and the many bus routes passing by.

Share of Freehold

Service Charge: Approx. £1,028 per annum

Council Tax: Band C







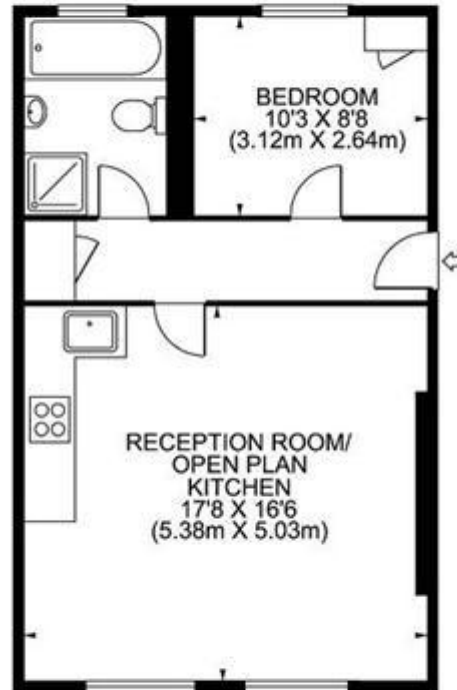

# Myddleton Square, EC1

Approximate Gross Internal Area :- 48 sq m / 519 sq ft



THIRD FLOOR

FOR IDENTIFICATION ONLY NOT TO SCALE  
THEFLOORPLANSTUDIO.COM

Energy Efficiency Rating		Current	Potential
Very energy efficient - lower running costs			
(92+)	A		
(81-91)	B		
(69-80)	C		
(55-68)	D		63
(49-54)	E	53	
(21-38)	F		
(1-20)	G		
Not energy efficient - higher running costs			
England, Scotland & Wales		EU Directive 2002/91/EC	

Clerkenwell & City | 020 7405 1288 | clerkenwell@winkworth.co.uk

winkworth.co.uk

Winkworth wishes to inform prospective buyers and tenants that these particulars are a guide and act as information only. All our details are given in good faith and believed to be correct at the time of printing but they don't form part of an offer or contract. No Winkworth employee has authority to make or give any representation or warranty in relation to this property. All fixtures and fittings, whether fitted or not are deemed removable by the vendor unless stated otherwise and room sizes are measured between internal wall surfaces, including furnishings.

Winkworth