



River Avenue, N13

£700,000 *Freehold*

3  2  1 

An extended terraced house in a sought-after location, within easy reach of both Palmers Green and Winchmore Hill Overground stations (serving Moorgate via Finsbury Park), as well as the wide range of shops and popular eateries along Winchmore Hill Broadway.

Offered for sale chain-free, the property provides just over 1,300 sq.

KEY FEATURES

- Extended Terraced House in a Sought-After Location
- Offered Chain-Free
- In Easy Reach of Palmers Green and Winchmore Hill Overground Stations to Moorgate (via Finsbury Park)
- Two Reception Rooms with Wooden Parquet Flooring
- Open-Plan Kitchen/Dining Room
- Utility Room and Ground Floor WC



Palmers Green

020 8920 9900 | palmersgreen@winkworth.co.uk

River Avenue, N13
Approx. Gross Internal Floor Area 1307 sq. ft / 121.44 sq. m

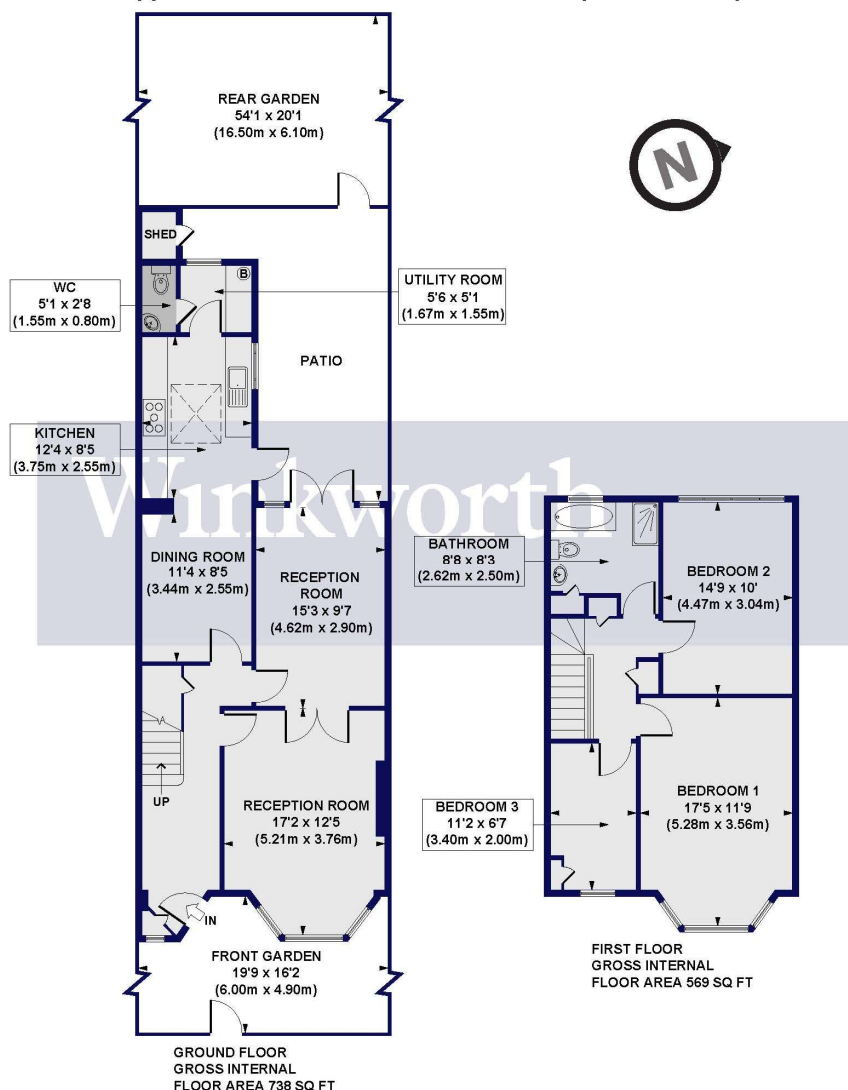

All measurements of walls, doors, windows, fittings and appliances, including their size and location, are shown as standard sizes and do not constitute any warranty or representation by the seller, their agent or CP Creative. Any intending purchaser must satisfy himself by inspection or otherwise as to the correctness of the information contained in these plans.

MATERIAL INFO

For more information, scan the QR code or visit the link below

Tenure: Freehold
Term: 0 year and 0 months
Service Charge: £0 per annum
Ground Rent: £ 0 Annually (subject to increase)
Council Tax Band: E
EPC rating: To be confirmed



<https://www.winkworth.co.uk/sale/property/PGN250295>

Where no figures are shown, we have been unable to ascertain the information. All figures that are shown were correct at the time of printing.

Palmers Green

020 8920 9900 | palmersgreen@winkworth.co.uk