



FLAT 32, WIGAN HOUSE, WARWICK GROVE, HACKNEY, LONDON, E5
£450,000 LEASEHOLD

GREAT VALUE THREE BEDROOM FOURTH FLOOR APARTMENT

Hackney | 020 8986 4216 | hackney@winkworth.co.uk

Winkworth

winkworth.co.uk

See things differently



DESCRIPTION:

A great value & spacious three-bedroom flat, located on the fourth floor of a purpose-built building. Accommodation comprises a large bright reception and separate fitted kitchen, three double bedrooms, bathroom suite and plenty of storage.

Within proximity to green open spaces such as Springfield Park and the River Lea. This property is also, well located near to shopping amenities and transport links providing direct access to the city.

Early viewings recommended!

Winkworth



Winkworth

Wigan House, Warwick Grove, E5
 Approx. Gross Internal Floor Area 779 sq. ft / 72.33 sq. m

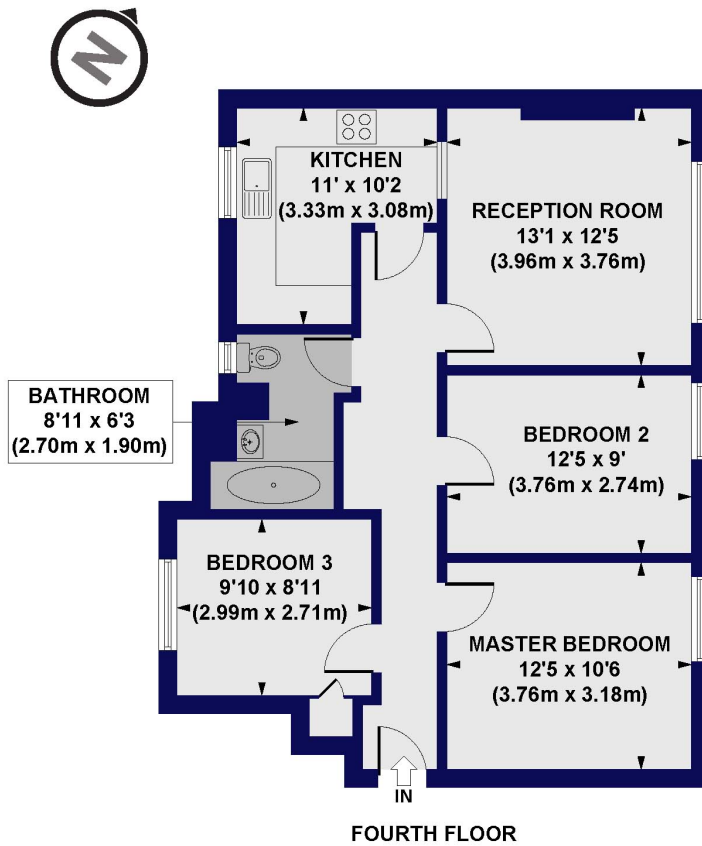

All measurements of walls, doors, windows, fittings and appliances, including their size and location, are shown as standard sizes and do not constitute any warranty or representation by the seller, their agent or CP Creative. Any intending purchaser must satisfy himself by inspection or otherwise as to the correctness of the information contained in these plans. This plan is for illustrative purposes only and should be used as such by any prospective purchasers.

Winkworth

This floorplan is for illustration purposes only and is not to scale. The position and size of doors, windows, appliances and other features are approximate.

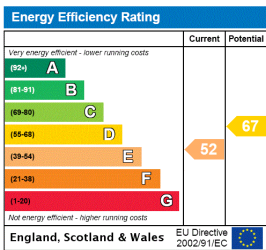

Hackney | 020 8986 4216 | hackney@winkworth.co.uk

Winkworth

winkworth.co.uk

See things differently

Winkworth wishes to inform prospective buyers and tenants that these particulars are a guide and act as information only. All our details are given in good faith and believed to be correct at the time of printing but they don't form part of an offer or contract. No Winkworth employee has authority to make or give any representation or warranty in relation to this property. All fixtures and fittings, whether fitted or not are deemed removable by the vendor unless stated otherwise and room sizes are measured between internal wall surfaces, including furnishings.