



Ballards Lane, London, N3

£425,000 *Leasehold*

1 1 1

Set in an ideal location for local amenities, Victoria Park and transport links, such as Finchley Central and West Finchley underground stations, we are pleased to offer this modern one bedroom, purpose built flat - offering 737 sqft of living space.

KEY FEATURES

- Modern block
- Third floor with lift
- Open plan living
- Large bedroom
- Modern fitted kitchen & bathroom
- Storage throughout
- Private Terrace



Finchley

020 8349 3388 | finchley@winkworth.co.uk

Winkworth

for every step...



The property offers good living accommodation and comprises of an open plan living/ dining / modern fitted kitchen area, spacious bedroom with fitted wardrobes, modern fitted bathroom and access to a large terrace area with wonderful views. Further benefits include a long lease, lift in block, and being sold on a chain free basis. An internal viewing is highly recommended.





MATERIAL INFO

Tenure: Leasehold
Term: 245 year and 0 months
Service Charge: £2820 per annum
Ground Rent: £ 350 Annually (subject to increase)
Council Tax Band: D
EPC rating: B

Ballards Lane, N3
Approx. Gross Internal Floor Area 737 sq. ft / 68.50 sq. m

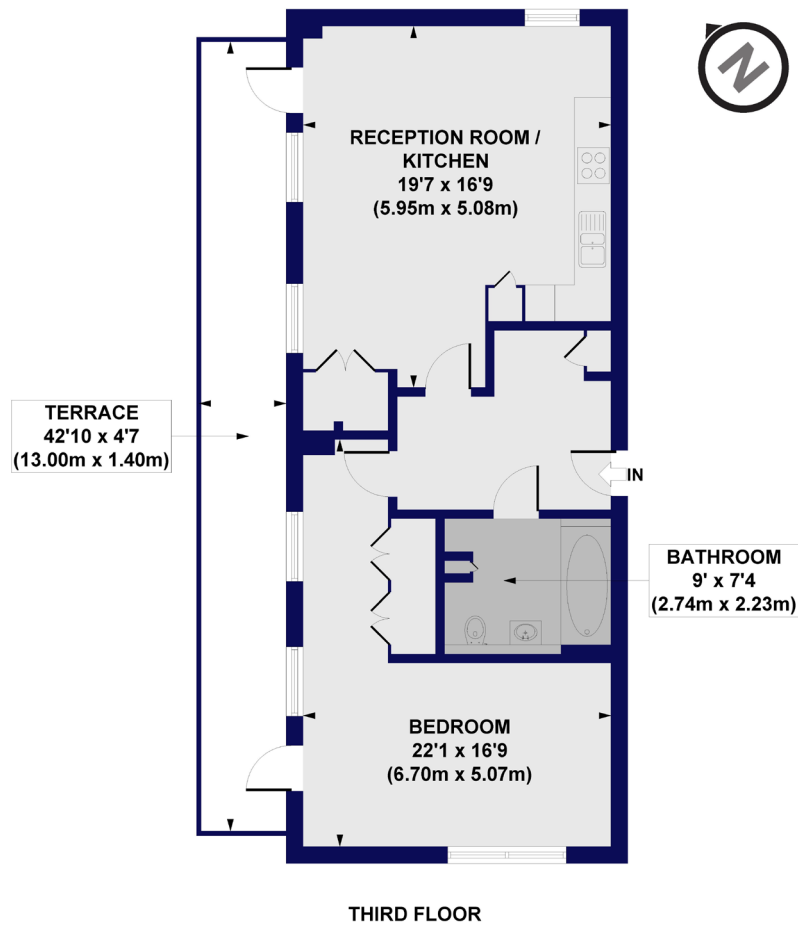

All measurements of walls, doors, windows, fittings and appliances, including their size and location, are shown as standard sizes and do not constitute any warranty or representation by the seller, their agent or CP Creative. Any intending purchaser must satisfy himself by inspection or otherwise as to the correctness of the information contained in these plans. This plan is for illustrative purposes only and should be used as such by any prospective purchasers.

Winkworth

Score	Energy rating	Current	Potential
92+	A		
81-91	B	83 B	83 B
69-80	C		
55-68	D		
39-54	E		
21-38	F		
1-20	G		

For more information, scan the QR code or visit the link below

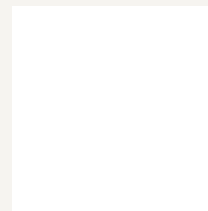

<https://www.winkworth.co.uk/sale/property/FIN250250>

Where no figures are shown, we have been unable to ascertain the information. All figures that are shown were correct at the time of printing.

Finchley

020 8349 3388 | finchley@winkworth.co.uk

Winkworth

for every step...

Winkworth wishes to inform prospective buyers and tenants that these particulars are a guide and act as information only. All our details are given in good faith and believed to be correct at the time of printing but they don't form part of an offer or contract. No Winkworth employee has authority to make or give any representation or warranty in relation to this property. All fixtures and fittings, whether fitted or not are deemed removable by the vendor unless stated otherwise and room sizes are measured between internal wall surfaces, including furnishings.