



45 MOORES COURT, SLEAFORD, NG34 7UL
£75,000 LEASEHOLD

This Spacious One Bedroom Apartment is located close to the town centre and was built by McCarthy & Stone. The property is offered for sale with no onward chain and it is situated on the second floor with the building benefitting from a lift. There is a superb residents lounge area and kitchen and a communal. Come and have a look!

Sleaford | 01529 303 377 | sleaford@winkworth.co.uk

Winkworth

for every step...

winkworth.co.uk

ACCOMMODATION

Entrance Hall - With door to front and airing cupboard.

Lounge - 18'3" x 11'1" (5.56m x 3.38m) With UPVC window to rear aspect, power points, TV point, telephone point and electric fire.

Kitchen - 8'11" x 6'1" (2.72m x 1.85m) Benefitting from a range of base and eye level units with bevelled edge worktop over, stainless steel sink, four ring hob with extractor hood over, electric oven, space for fridge freezer, space for separate fridge, power points, UPVC window to rear aspect, tiled splashbacks and coving to ceiling.

Bedroom - Having UPVC window to rear aspect, power points, built in wardrobes, telephone point and coving to ceiling.

Family Bathroom - Being fully tiled and benefitting from a three piece suite comprising panel bath with shower over, low level w/c, hand wash basin with vanity unit, extractor fan and coving to ceiling.

| Energy Efficiency Rating | | Current | Potential |
|---|---|-------------------------|-----------|
| Very energy efficient - lower running costs | | | |
| (92+) | A | | |
| (81-91) | B | | |
| (69-80) | C | 80 | 83 |
| (55-68) | D | | |
| (39-54) | E | | |
| (21-28) | F | | |
| (1-20) | G | | |
| Not energy efficient - higher running costs | | | |
| England, Scotland & Wales | | EU Directive 2002/91/EC | |

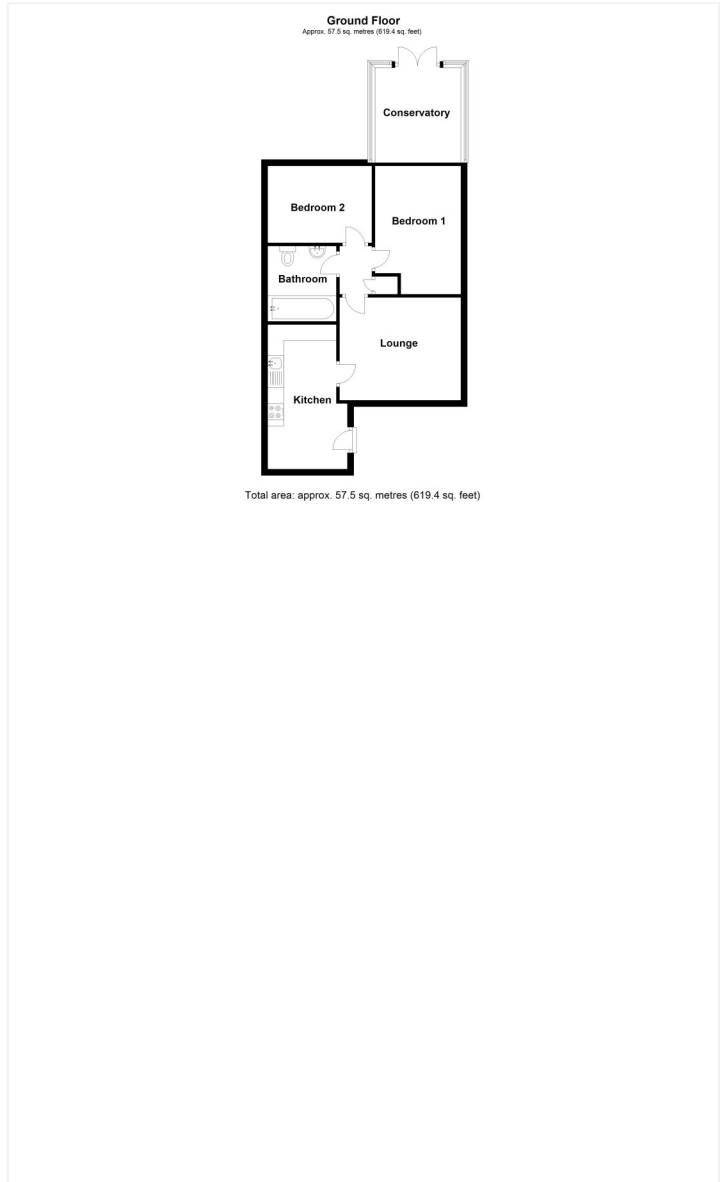

This floorplan is for illustration purposes only and is not to scale. The position and size of doors, windows, appliances and other features are approximate.

Sleaford | 01529 303 377 | sleaford@winkworth.co.uk

Winkworth

for every step...

winkworth.co.uk

Winkworth wishes to inform prospective buyers and tenants that these particulars are a guide and act as information only. All our details are given in good faith and believed to be correct at the time of printing but they don't form part of an offer or contract. No Winkworth employee has authority to make or give any representation or warranty in relation to this property. All fixtures and fittings, whether fitted or not are deemed removable by the vendor unless stated otherwise and room sizes are measured between internal wall surfaces, including furnishings.