



HUNTER STREET, WC1N
£250,000 LEASEHOLD

Winkworth



HUNTER STREET, WC1N

A studio apartment for sale on the third floor, with a lift, of a late Victorian redbrick mansion block on Hunter Street near Russell Square in the heart of Bloomsbury.

The flat is at the quieter rear of the block and in fair condition with a large kitchen, shower room and lounge / come Bedroom.

The building is served by a lift and has a caretaker.

The lease has 52 years remaining.

The property is 5 minutes from Russell Square underground station and 10 mins walk to the British Museum.

This Pied a Terre in Jenner house is convenient for The Brunswick Centre and the universities of UCL, SOAS and LSE.

The West End, Euston Kings Cross and St Pancras are all nearby.

Leasehold: Approx. 52 years remaining
Service Charge: Approx. £1,569.18 p/a
Ground Rent: Approx. £150 p/a.
Council Tax is Band B: Approx. £1,394 p/a





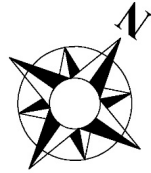

Jenner House WC1N

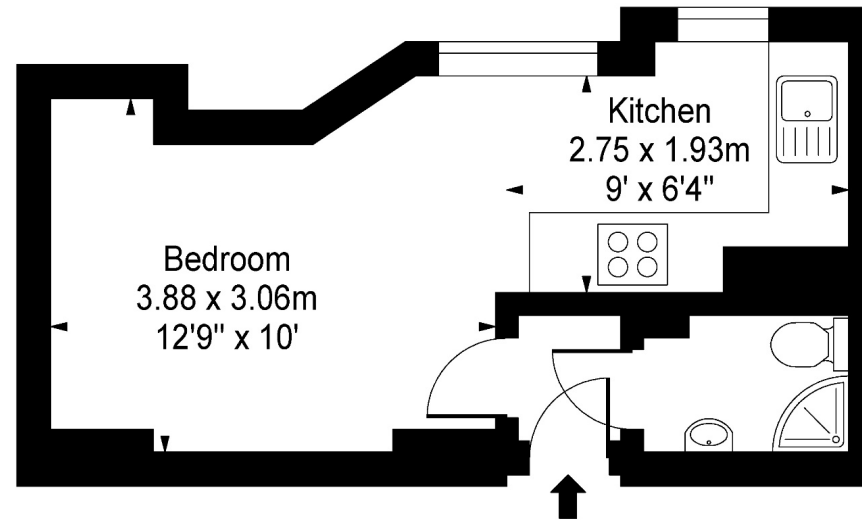

Third Floor

Approx Gross Internal Area

236 Sq Ft - 22 Sq M

Measured in accordance with RICS guidelines. Every attempt is made to ensure accuracy.

However all measurements are approximate.

The floor plan is illustrative purposes only and is not to scale

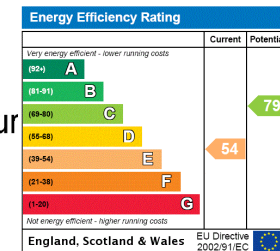

West End | 020 7240 3322 | westend@winkworth.co.uk

winkworth.co.uk

Winkworth wishes to inform prospective buyers and tenants that these particulars are a guide and act as information only. All our details are given in good faith and believed to be correct at the time of printing but they don't form part of an offer or contract. No Winkworth employee has authority to make or give any representation or warranty in relation to this property. All fixtures and fittings, whether fitted or not are deemed removable by the vendor unless stated otherwise and room sizes are measured between internal wall surfaces, including furnishings.

Winkworth