



Meldrum Close RG14 6SL

A smartly presented three bedroom terraced house on this most sought after development.

There is an entrance hall, cloakroom, a generous sitting room, kitchen/diner with walk in pantry, three bedrooms and bathroom.

The house has a south facing garden and a garage that can be accessed through a footpath in rear garden.

Gas central heating and UPVC double glazing.

Garage in a block.

Ultrafast broadband available with no known mobile issues.

West Berkshire Council Band C
EPC: C



Winkworth

AT A GLANCE

NO ONWARD CHAIN

Three bedrooms
Family bathroom
kitchen/diner
Sitting room
Hall
Cloakroom
South facing garden

UTILITIES

Mains Gas
Mains Electric
Mains Water

SITUATION

In the popular village of Wash Common this property offers idyllic location and is just 2 miles from Newbury retail park which includes shops such as Tesco Extra, JD sports, Currys, TK max & many more.

DIRECTIONS

What3words:///chats.deny.glad

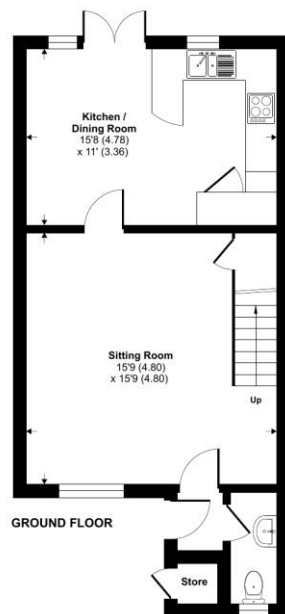

Floor plan produced in accordance with RICS Property Measurement 2nd Edition, incorporating International Property Measurement Standards (IPMS2 Residential). © richcom 2025. Produced for Winkworth. REF: 1306229

Meldrum Close, Newbury, RG14

Approximate Area = 891 sq ft / 82.7 sq m

Outbuilding = 6 sq ft / 0.5 sq m

Total = 897 sq ft / 83.2 sq m

For identification only - Not to scale

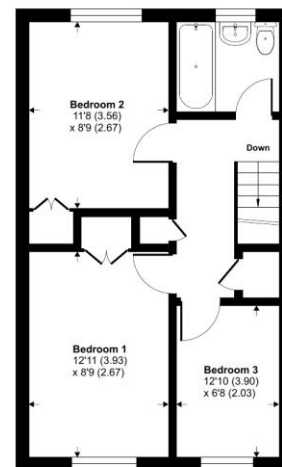

FIRST FLOOR

Winkworth



Newbury Office

43 Northbrook Street, Newbury, Berkshire RG14 1DT

01635 552552 | newbury@winkworth.co.uk

[winkworth.co.uk/newbury](https://www.winkworth.co.uk/newbury)

Winkworth

See things differently.