



**PENNYROYAL COURT, READING, RG1 6HE  
OFFERS IN EXCESS OF £180,000 LEASEHOLD**

**OFFERED TO THE MARKET IS THIS WELL-  
PRESENTED APARTMENT SITUATED IN THE  
POPULAR PENNYROYAL COURT**

Reading | 0118 4022 300 | [reading@winkworth.co.uk](mailto:reading@winkworth.co.uk)

**Winkworth**

for every step...

[winkworth.co.uk](http://winkworth.co.uk)





## DESCRIPTION:

Offered to the market is this well-presented apartment situated in the popular Pennyroyal Court, which is in a central location offering easy access to Reading town centre, Reading mainline station, and The Oracle shopping centre. Local amenities include several shops, recreation grounds, and public transport links. The property has been tastefully modernised with a refitted shower room, living room, refitted kitchen, and double bedroom with storage. To the exterior, there are communal grounds and parking. This property would make an ideal first-time purchase or investment property.

## AT A GLANCE

- One bedroom apartment
- Second floor
- Within One Mile of Reading Station
- Refitted kitchen / bathroom
- One Allocated Parking Space
- No Onward Chain





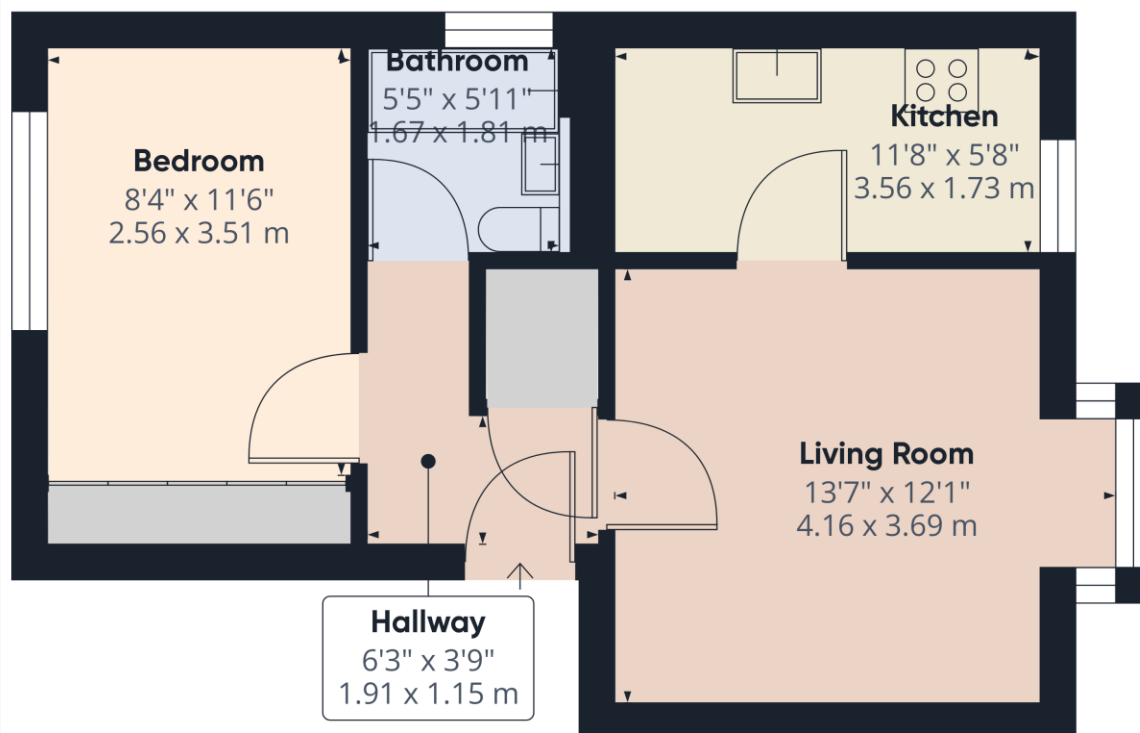

Approximate total area<sup>(1)</sup>

413.01 ft<sup>2</sup>  
38.37 m<sup>2</sup>

(1) Excluding balconies and terraces

While every attempt has been made to ensure accuracy, all measurements are approximate, not to scale. This floor plan is for illustrative purposes only.

Calculations are based on RICS IPMS 3C standard.

GIRAFFE 360

This floorplan is for illustration purposes only and is not to scale. The position and size of doors, windows, appliances and other features are approximate.

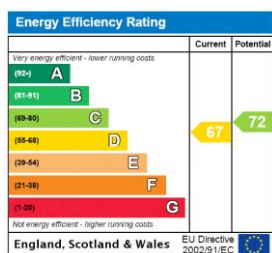

**Tenure:** Leasehold

**Term:** 152 year and 0 months

**Service Charge:** £1727 per annum

**Ground Rent:** £ 0 Annually)

**Council Tax Band:** B

Where no figures are shown, we have been unable to ascertain the information. All figures that are shown were correct at the time of printing.

**Winkworth**

Reading | 0118 4022 300 | [reading@winkworth.co.uk](mailto:reading@winkworth.co.uk)

for every step...

[winkworth.co.uk](http://winkworth.co.uk)

Winkworth wishes to inform prospective buyers and tenants that these particulars are a guide and act as information only. All our details are given in good faith and believed to be correct at the time of printing but they don't form part of an offer or contract. No Winkworth employee has authority to make or give any representation or warranty in relation to this property. All fixtures and fittings, whether fitted or not are deemed removable by the vendor unless stated otherwise and room sizes are measured between internal wall surfaces, including furnishings.