



Wisdom Court, Southcote Road, RG30 2AG

£1,300 per month *Furnished*

2 1 1

A well-presented two bedroom, second floor apartment located to the West of Reading just off the A4 Bath Road. The property comprises spacious living room with a private balcony, separate kitchen, three piece bathroom and two double bedrooms. Benefits include residents parking and a garage. Available now. Furnished.

KEY FEATURES

- Two bedroom apartment
- Second floor (no lift)
- Private Balcony
- Single Garage
- On road parking
- Available now
- Furnished



Reading

0118 4022 300 | reading@winkworth.co.uk

Winkworth

for every step...





MATERIAL INFO

Deposit: £1,500.00

Holding Deposit: £300.00

Council Tax Band: B

EPC rating: C

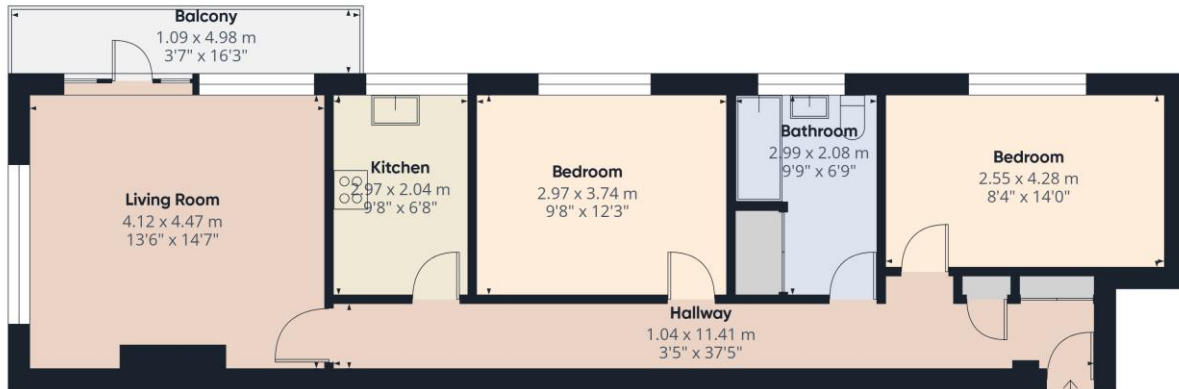
Approximate total area⁽¹⁾

66.4 m²
715 ft²

Balconies and terraces

5.4 m²
58 ft²

(1) Excluding balconies and terraces

Calculations reference the RICS IPMS 3C standard. Measurements are approximate and not to scale. This floor plan is intended for illustration only.

GIRAFFE360

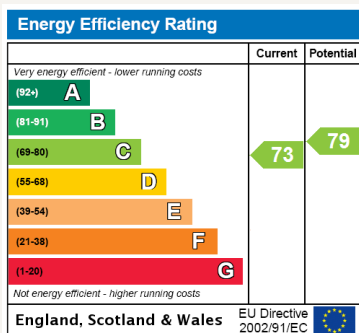

For more information, scan the QR code or visit the link below

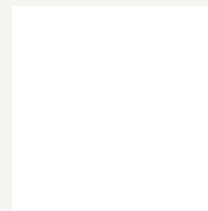
<https://www.winkworth.co.uk/rent/property/REA150239>

Where no figures are shown, we have been unable to ascertain the information. All figures that are shown were correct at the time of printing.

Reading

0118 4022 300 | reading@winkworth.co.uk

Winkworth

for every step...

Winkworth wishes to inform prospective buyers and tenants that these particulars are a guide and act as information only. All our details are given in good faith and believed to be correct at the time of printing but they don't form part of an offer or contract. No Winkworth employee has authority to make or give any representation or warranty in relation to this property. All fixtures and fittings, whether fitted or not are deemed removable by the vendor unless stated otherwise and room sizes are measured between internal wall surfaces, including furnishings.