



GROVE AVENUE, LONDON, N3
£1,250,000 FREEHOLD

A FOUR BEDROOM PERIOD STYLE FAMILY HOME WITH A LARGE REAR GARDEN AND POTENTIAL TO EXTEND STPP

Finchley | 020 8349 3388 | finchley@winkworth.co.uk

Winkworth

for every step...

winkworth.co.uk



Winkworth

DESCRIPTION:

We are pleased to offer this, period style, four bedroom family home, set in an ideal location for local amenities, transport links such as Finchley Central underground and local schools. The property offers good living space throughout and still has further potential for expansion STPP. To the ground floor the property comprises two reception rooms, one to the front and one to the rear, eat in kitchen, utility area and a downstairs cloakroom. To the first floor the property comprises four bedrooms, family bathroom, shower room and separate wc. This lovely property does require some updating, but has the benefit of a wonderful and large rear garden circa 180 ft, cellar and off street parking.

An internal viewing is highly recommended.

AT A GLANCE

- Period style family home
- Two reception rooms
- Four bedrooms
- Two bathrooms
- Large rear garden
- Cellar and Loft
- Off street parking



Winkworth



Winkworth



Winkworth



Winkworth



Winkworth



Winkworth



Winkworth

Grove Avenue, N3

Approx. Gross Internal Floor Area 1817 sq. ft / 168.77 sq. m

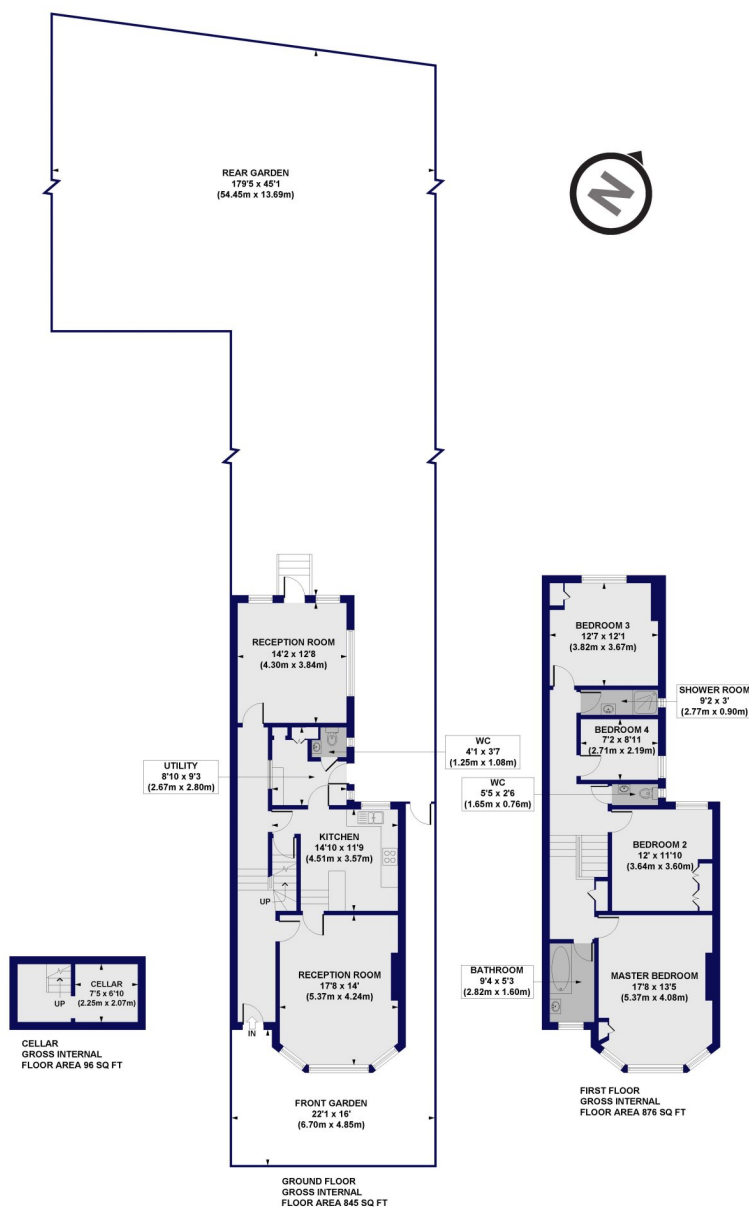

All measurements of walls, doors, windows, fittings and appliances, including their size and location, are shown as standard sizes and do not constitute any warranty or representation by the seller, their agent or CP Creative. Any intending purchaser must satisfy himself by inspection or otherwise as to the correctness of the information contained in these plans. This plan is for illustrative purposes only and should be used as such by any prospective purchasers.

Winkworth

This floorplan is for illustration purposes only and is not to scale. The position and size of doors, windows, appliances and other features are approximate.

Tenure: Freehold

Council Tax Band: G

Where no figures are shown, we have been unable to ascertain the information. All figures that are shown were correct at the time of printing.

Finchley | 020 8349 3388 | finchley@winkworth.co.uk

Winkworth

for every step...

winkworth.co.uk

Winkworth wishes to inform prospective buyers and tenants that these particulars are a guide and act as information only. All our details are given in good faith and believed to be correct at the time of printing but they don't form part of an offer or contract. No Winkworth employee has authority to make or give any representation or warranty in relation to this property. All fixtures and fittings, whether fitted or not are deemed removable by the vendor unless stated otherwise and room sizes are measured between internal wall surfaces, including furnishings.