



MEDFIELD STREET, SW15
£1,750 PER MONTH FURNISHED

A superb one bedroom first floor flat with a roof terrace finished to an incredibly high standard throughout

Putney | 020 8877 1000 | putney@winkworth.co.uk

Winkworth

for every step...

winkworth.co.uk



DESCRIPTION:

This stylish property has been renovated to a very high standard throughout. Situated on the first floor of a conversion it extends to circa 600 sq ft of lateral space.

Towards the front of the property is the light and airy reception room with high ceilings and wood flooring. Adjacent is the generously sized bedroom with wall-to-wall fitted wardrobes which is serviced by a luxuriously appointed bathroom with a rolltop bath and shower over.

At the rear is a beautiful eat-in kitchen also with wood flooring and ample space for a dining table. Off the kitchen is a balcony/terrace complete with rattan garden furniture.

Medfield Street is close to the amenities and transport facilities Roehampton has to offer and is well served with excellent bus links to surrounding areas including Putney, Richmond, and Barnes. Motorists are equally well served by the A3. The green open spaces of Putney Heath, Richmond Park, and Wimbledon Common are also close by.



ACCOMMODATION

Long Let, 1 Bedroom, 1 Reception Room, 1 Bathroom, Flat/Apartment, First Floor, Balcony, Residents Parking, Period, Furnished, 599 Approx Sq Ft

Medfield Street, SW15
Approx. Gross Internal Floor Area 599 sq. ft / 55.66 sq. m

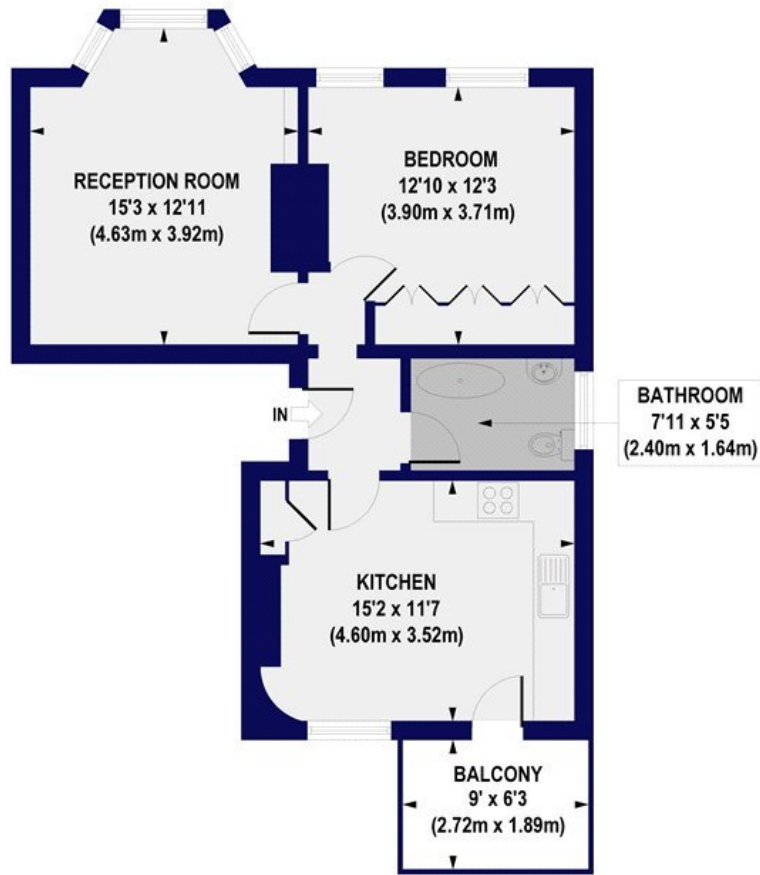

FIRST FLOOR

All measurements of walls, doors, windows, fittings and appliances, including their size and location, are shown as standard sizes and do not constitute any warranty or representation by the seller, their agent or CP Creative. Any intending purchaser must satisfy himself by inspection or otherwise as to the correctness of the information contained in these plans. This plan is for illustrative purposes only and should be used as such by any prospective purchasers.

Winkworth

This floorplan is for illustration purposes only and is not to scale. The position and size of doors, windows, appliances and other features are approximate.

Putney | 020 8877 1000 | putney@winkworth.co.uk

Winkworth

for every step...

winkworth.co.uk

Winkworth wishes to inform prospective buyers and tenants that these particulars are a guide and act as information only. All our details are given in good faith and believed to be correct at the time of printing but they don't form part of an offer or contract. No Winkworth employee has authority to make or give any representation or warranty in relation to this property. All fixtures and fittings, whether fitted or not are deemed removable by the vendor unless stated otherwise and room sizes are measured between internal wall surfaces, including furnishings.