



VANE CLOSE, HARROW, MIDDLESEX, HA3  
**£495,000 FREEHOLD**

**VANE CLOSE BRINGS THIS 2 BEDROOM-  
TERRACED BLANK CANVAS WITH A GARAGE**

Kingsbury | 020 8204 0000 | [kingsbury@winkworth.co.uk](mailto:kingsbury@winkworth.co.uk)

**Winkworth**

for every step...

[winkworth.co.uk](http://winkworth.co.uk)





**DESCRIPTION:** Welcome to Vane Close, where an exciting opportunity awaits you in the form of a charming TWO-BEDROOM TERRACED HOUSE WITH A GARAGE EN-BLOCK. This property beckons you to unleash your creativity and make it your own. Upon entering, you'll be greeted by a very good-sized kitchen, with AMPLE wall and base level units. The living room serves as the hub of this inviting home, with LARGE WINDOWS that not only flood the room with natural light but also provide a picturesque garden view. On the first floor, you'll find TWO SPACIOUS BEDROOMS, each brimming with immense potential. These BLANK CANVASES eagerly await your personal touch and creative flair. Additional benefits to this property include a LARGE REAR GARDEN, En-block GARAGE, street parking available, and the potential to extend to the rear (STPP). Preston Road Station (Metropolitan Line) and Kingsbury Tube Station (Jubilee Line) are both equidistant away from the property and HIGHLY RATED OFSTED schools like UXENDON MANOR PRIMARY SCHOOL and CLAREMONT HIGH SCHOOL are close by. With the canvas set, the potential for transformation and the chance to make this house truly your own is an opportunity not to be missed. Internal viewing is highly recommended.



**Winkworth**

for every step...





**Winkworth**

for every step...

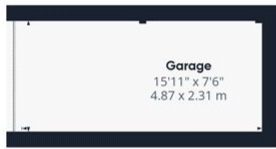
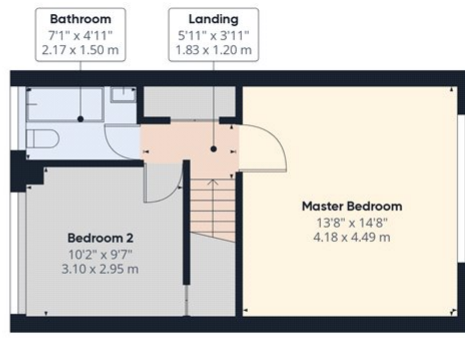
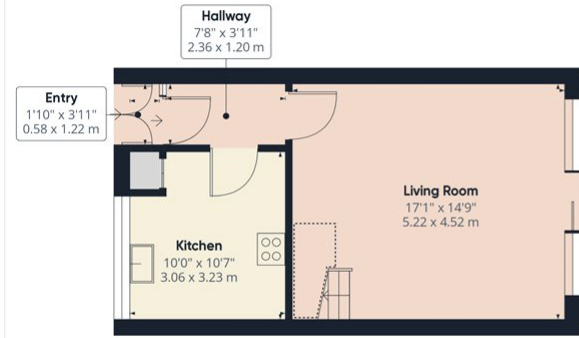

**Approximate total area<sup>1)</sup>**  
 910.48 ft<sup>2</sup>  
 84.59 m<sup>2</sup>

**Reduced headroom**  
 15.67 ft<sup>2</sup>  
 1.46 m<sup>2</sup>

Excluding balconies and terraces

Reduced headroom (below 1.5m/4.92ft)

While every attempt has been made to ensure accuracy, all measurements are approximate, not to scale. This floor plan is for illustrative purposes only.

GIRAFFE360

This floorplan is for illustration purposes only and is not to scale. The position and size of doors, windows, appliances and other features are approximate.

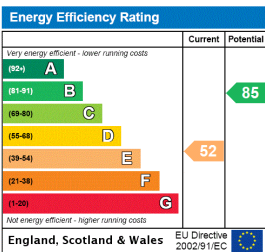

Kingsbury | 020 8204 0000 | kingsbury@winkworth.co.uk

for every step...

winkworth.co.uk

Winkworth wishes to inform prospective buyers and tenants that these particulars are a guide and act as information only. All our details are given in good faith and believed to be correct at the time of printing but they don't form part of an offer or contract. No Winkworth employee has authority to make or give any representation or warranty in relation to this property. All fixtures and fittings, whether fitted or not are deemed removable by the vendor unless stated otherwise and room sizes are measured between internal wall surfaces, including furnishings.