



CLARENDON ROAD, W11
£475,000 LEASEHOLD

**A BRIGHT TWO BEDROOM FLAT WITH
BALCONY ON THE THIRD FLOOR OF THIS
WELL LOCATED NOTTING HILL
DEVELOPMENT**

North Kensington | 020 7792 5000 | northkensington@winkworth.co.uk

Winkworth

for every step...

winkworth.co.uk



DESCRIPTION:

A bright South facing two bedroom flat on the third floor of this well maintained 1930's block in Notting Hill. Benefits include a lovely south facing balcony, sitting room, kitchen and two double bedrooms. This flat would make an ideal London home, pied a terre or rental investment.

The block is located perfectly for access to the trendy shops and restaurants of Notting Hill and the Portobello Road. Additionally, the Kensington Leisure Centre with swimming pool, squash court, large sports hall and gym is around the corner. Ladbroke grove Station (Hammersmith and City Line) is a mere six minute walk away with Holland Park Station (Central Line) a twelve minute walk away.

AT A GLANCE

- Top Floor Flat
- Two Bedrooms
- Private Balcony
- Great Views
- Communal Gardens
- Secure Block
- Leasehold 90 years
- Service Charges £1,747
- Ground Rent £10 pa





Nottingwood House

Approx. Gross Internal Area 634 Sq Ft - 58.90 Sq M
 Approx. External Area Of Balcony 33 Sq Ft - 3.07 Sq M

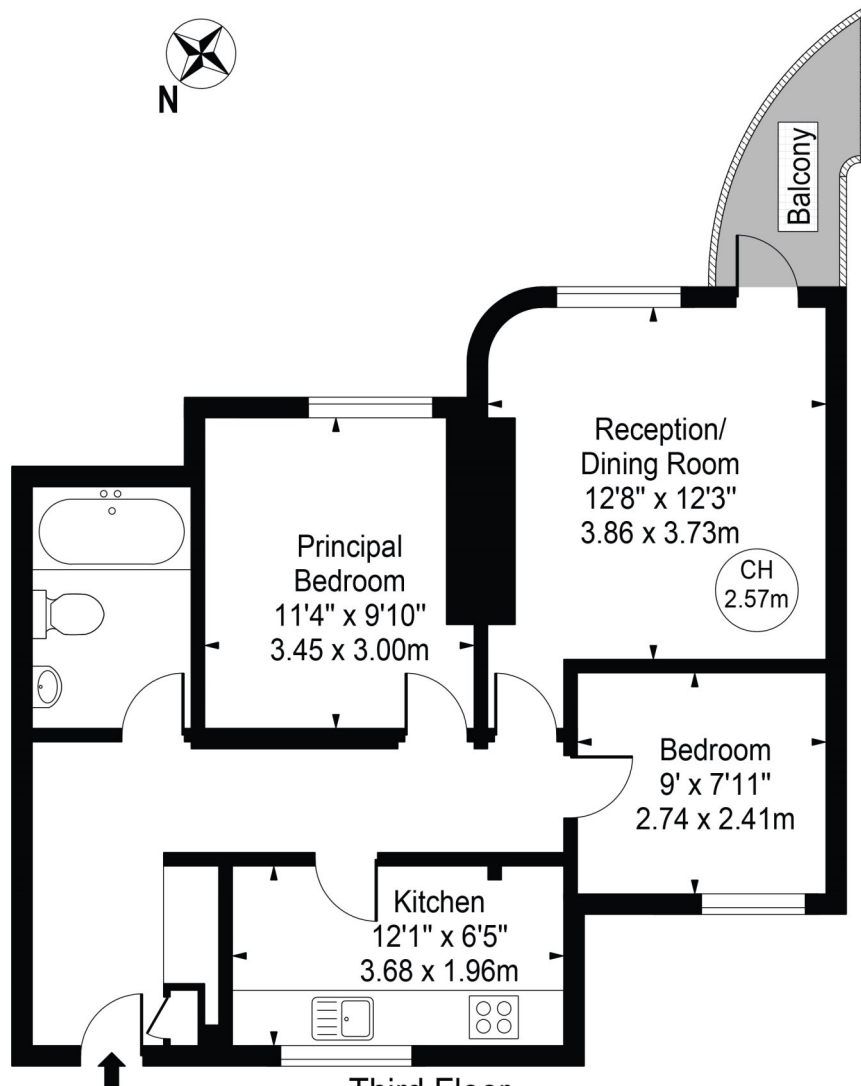

Third Floor

For Illustration Purposes Only - Not To Scale

This floor plan should be used as a general outline for guidance only and does not constitute in whole or in part an offer or contract. Any intending purchaser or lessee should satisfy themselves by inspection, searches, enquiries and full survey as to the correctness of each statement. Any areas, measurements or distances quoted are approximate and should not be used to value a property or be the basis of any sale or let.
 Copyright Morriarti Photography & Design LTD

This floorplan is for illustration purposes only and is not to scale. The position and size of doors, windows, appliances and other features are approximate.

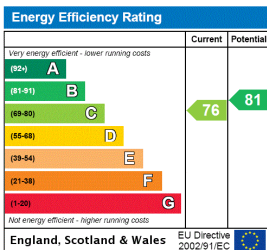

North Kensington | 020 7792 5000 | northkensington@winkworth.co.uk



for every step...

winkworth.co.uk

Winkworth wishes to inform prospective buyers and tenants that these particulars are a guide and act as information only. All our details are given in good faith and believed to be correct at the time of printing but they don't form part of an offer or contract. No Winkworth employee has authority to make or give any representation or warranty in relation to this property. All fixtures and fittings, whether fitted or not are deemed removable by the vendor unless stated otherwise and room sizes are measured between internal wall surfaces, including furnishings.