



**HOLDERS HILL GARDENS, HENDON, LONDON, NW4**  
**£950,000 FREEHOLD**

**THIS WELL PRESENTED FOUR BEDROOM SEMI-DETACHED RESIDENCE EXTENDING TO IN EXCESS OF 1,300 SQ. FT. IS SITUATED IN A MOST SOUGHT AFTER LOCATION IN HENDON**

Hendon | 020 8202 1031 | [hendon@winkworth.co.uk](mailto:hendon@winkworth.co.uk)

**Winkworth**

for every step...

[winkworth.co.uk](http://winkworth.co.uk)



## DESCRIPTION:

This well presented four bedroom semi-detached residence extending to in excess of 1,300 sq. ft. is situated in a most sought after location in Hendon. The property is in good decorative order throughout, consisting of a through lounge/dining room and eat-in kitchen on the ground floor. At first floor, there are three spacious bedrooms with a family bathroom and an extensive loft comprising a master bedroom together with an en-suite shower room.

This family home also benefits from off street parking, a large rear garden, potential to extend subject to Planning Permission and sold chain free.

Viewing is highly recommended

EPC: TBC

Council Tax Band: E

## AT A GLANCE

- FOUR BEDROOM, TWO BATHROOM SEMI-DETACHED FAMILY HOME
- LIVING ACCOMMODATION EXTENDING TO C. 1,384 SQ. FT.
- PRIME LOCATION
- OFF STREET PARKING
- SCOPE FOR EXTENSION SUBJECT TO P.P.
- SOLD CHAIN FREE





# Holdes Hill Gardens, NW4

Approx. Gross Internal Floor Area 1384 sq. ft / 128.63 sq. m (Including Storage)

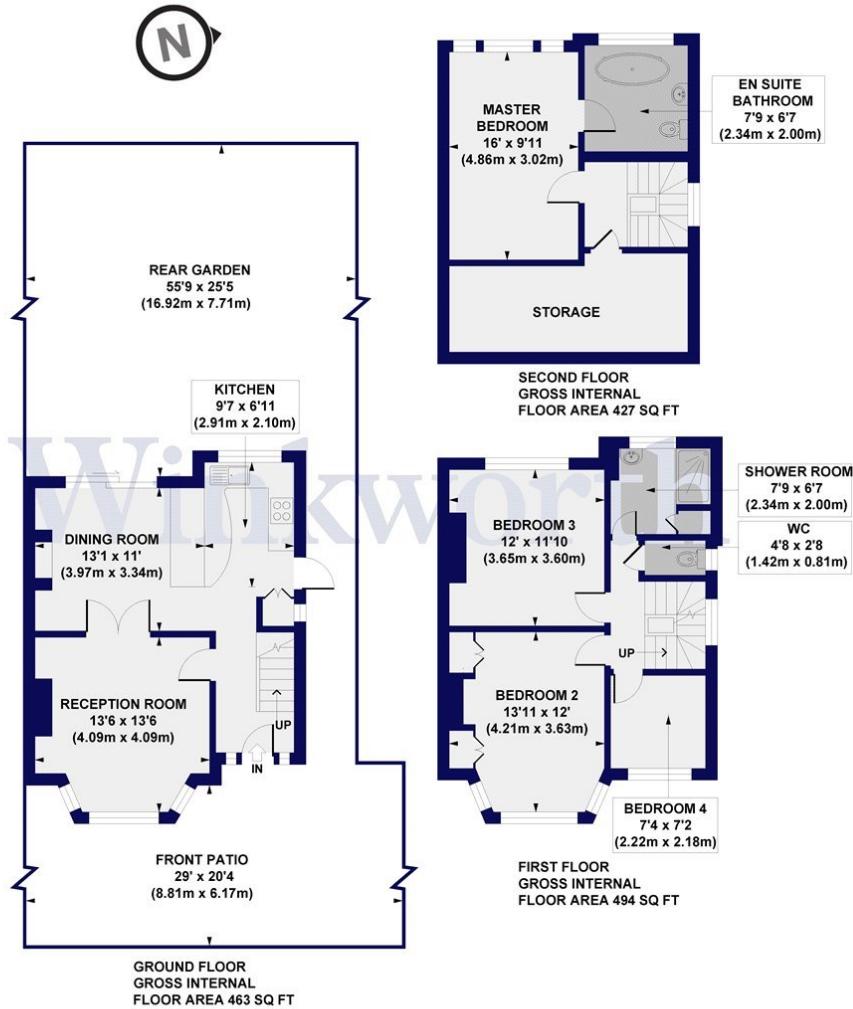

All measurements of walls, doors, windows, fittings and appliances, including their size and location, are shown as standard sizes and do not constitute any warranty or representation by the seller, their agent or CP Creative. Any intending purchaser must satisfy himself by inspection or otherwise as to the correctness of the information contained in these plans. This plan is for illustrative purposes only and should be used as such by any prospective purchasers.

**Winkworth**

This floorplan is for illustration purposes only and is not to scale. The position and size of doors, windows, appliances and other features are approximate.

Hendon | 020 8202 1031 | hendon@winkworth.co.uk

**Winkworth**

for every step...

winkworth.co.uk

Winkworth wishes to inform prospective buyers and tenants that these particulars are a guide and act as information only. All our details are given in good faith and believed to be correct at the time of printing but they don't form part of an offer or contract. No Winkworth employee has authority to make or give any representation or warranty in relation to this property. All fixtures and fittings, whether fitted or not are deemed removable by the vendor unless stated otherwise and room sizes are measured between internal wall surfaces, including furnishings.